

BENCHMARKS:

Railroad Spike in Power Pole
 Located 27' South and 402' East
 of the Northwest Corner of the
 NE 1/4, Section 24, TWP. 28-S, R-1-W.
 Elevation = 92.98 City Datum

City of Wichita Benchmark Disc SE Corner
 of Intersection of 47th St. S. and West St.
 42.10' E. of Centerline
 51.00' S. of Centerline
 99.80' E. of P.P. on SW Corner
 23.80' S. of P.P.
 Elevation = 92.29 City Datum

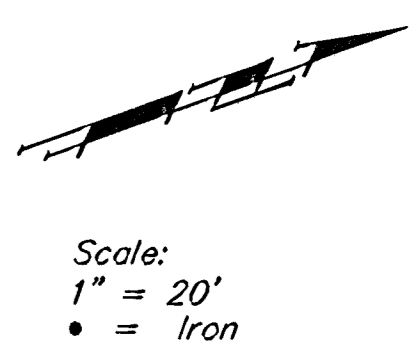

Scale:
 1" = 20'
 • = Iron

ANGEL FIRE ADDITION

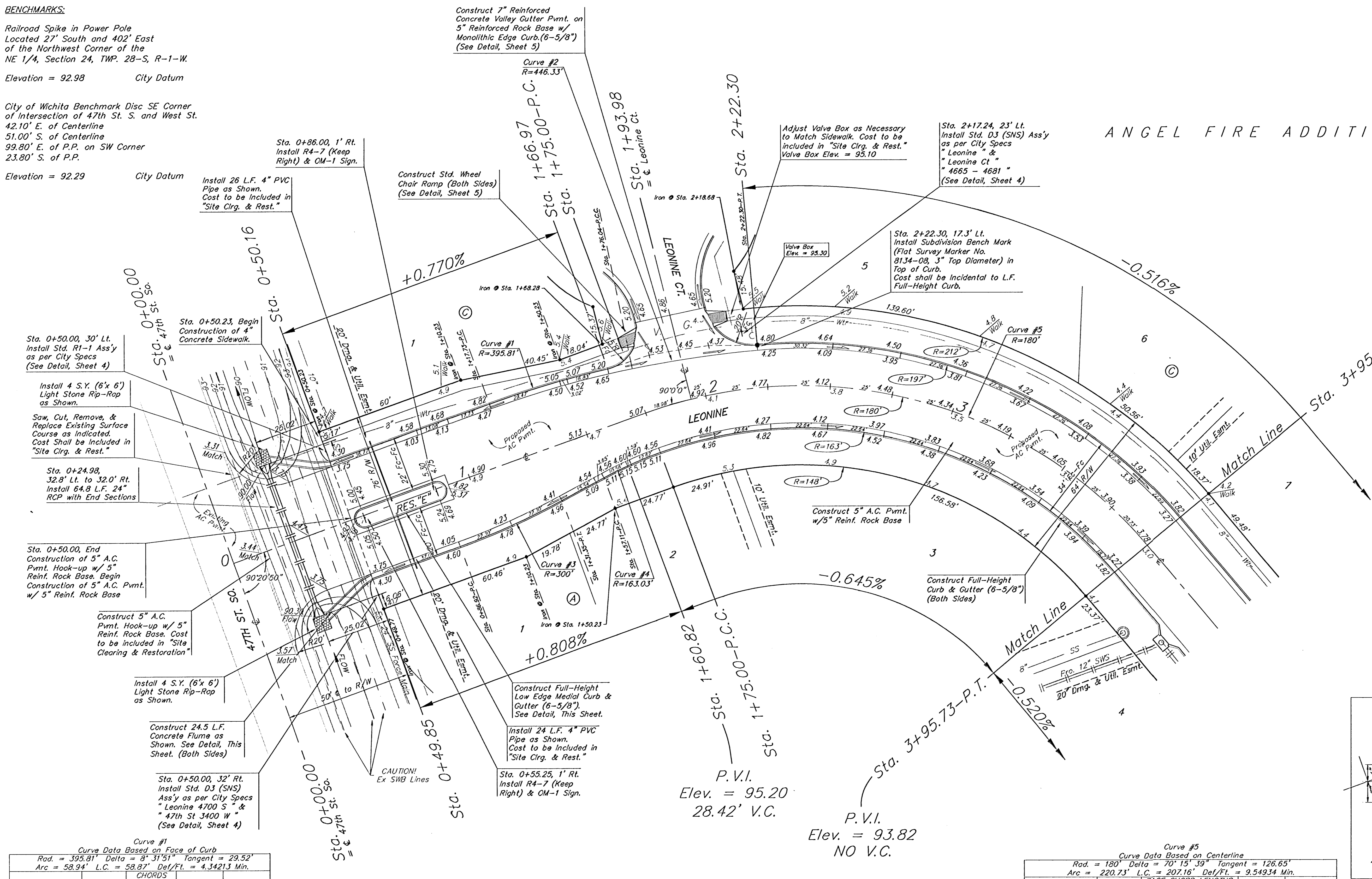

Curve #1
 Curve Data Based on Face of Curb
 Rad. = 395.81' Delta = 8° 31' 51" Tangent = 29.52'
 Arc = 58.94' L.C. = 58.87' Def/Ft. = 4.34213 Min.

Station	Arc	CHORDS		
		8 Lt.	Def.	T. Def.
0+00.00	-	0.00	0.00	0.00
0+29.47	29.47'	30.06'	2.0758'	2.0758'
0+58.94	29.47'	30.06'	2.0758'	4.1516'

Curve #2
 Curve Data Based on Face of Curb
 Rad. = 446.33' Delta = 6° 31' 30" Tangent = 25.44'
 Arc = 50.83' L.C. = 50.80' Def/Ft. = 3.85107 Min.

Station	Arc	CHORDS		
		8 Lt.	Def.	T. Def.
0+00.00	-	0.00	0.00	0.00
0+25.42	25.42'	25.87'	1.3754'	1.3754'
0+50.83	25.41'	25.86'	1.3751'	2.7505'

Curve #3
 Curve Data Based on Face of Curb
 Rad. = 300' Delta = 8° 30' 59" Tangent = 22.34'
 Arc = 44.60' L.C. = 44.55' Def/Ft. = 5.72851 Min.

Station	Arc	CHORDS		
		8 Rt.	Def.	T. Def.
0+00.00	-	0.00	0.00	0.00
0+22.30	22.30'	22.89'	2.0745'	2.0745'
0+44.60	22.30'	22.89'	2.0745'	4.1490'

Curve #4
 Curve Data Based on Face of Curb
 Rad. = 163.03' Delta = 8° 42' 19" Tangent = 12.41'
 Arc = 24.77' L.C. = 24.75' Def/Ft. = 10.54333 Min.

Station	Arc	CHORDS		
		8 Rt.	Def.	T. Def.
1+57.11	-	0.00	0.00	0.00
1+60.82	10.56'	11.09'	1.5120'	1.5120'
1+62.40	1.59'	1.67'	0.1646'	2.0806'
1+75.00	12.62'	13.24'	2.1303'	4.2110'

Curve #5
 Curve Data Based on Centerline
 Rad. = 180' Delta = 70° 15' 39" Tangent = 126.65'
 Arc = 220.73' L.C. = 207.18' Def/Ft. = 9.54934 Min.

Station	Arc	FACE CHORD LENGTHS			Def.	T. Def.
		8 Lt.	8 Rt.	8 Rt.		
0+00.00	-	-	-	0.00	0.00	
1+93.98	18.98'	19.81'	18.13'	3.0115'	3.0115'	
2+00.00	6.02'	6.29'	5.75'	0.5729'	3.5844'	
2+22.30	22.30'	23.28'	21.30'	3.3257'	7.3141'	
2+25.00	2.70'	2.82'	2.58'	0.2547'	7.5728'	
2+50.00	25.00'	26.10'	23.88'	3.5844'	11.5612'	
2+75.00	25.00'	26.10'	23.88'	3.5844'	15.5456'	
3+00.00	25.00'	26.10'	23.88'	3.5844'	19.5300'	
3+25.00	25.00'	26.10'	23.88'	3.5844'	23.5244'	
3+50.00	25.00'	26.10'	23.88'	3.5844'	27.5188'	
3+75.00	25.00'	26.10'	23.88'	3.5844'	31.4952'	
3+95.73	20.73'	21.64'	19.80'	3.1758'	35.0750'	

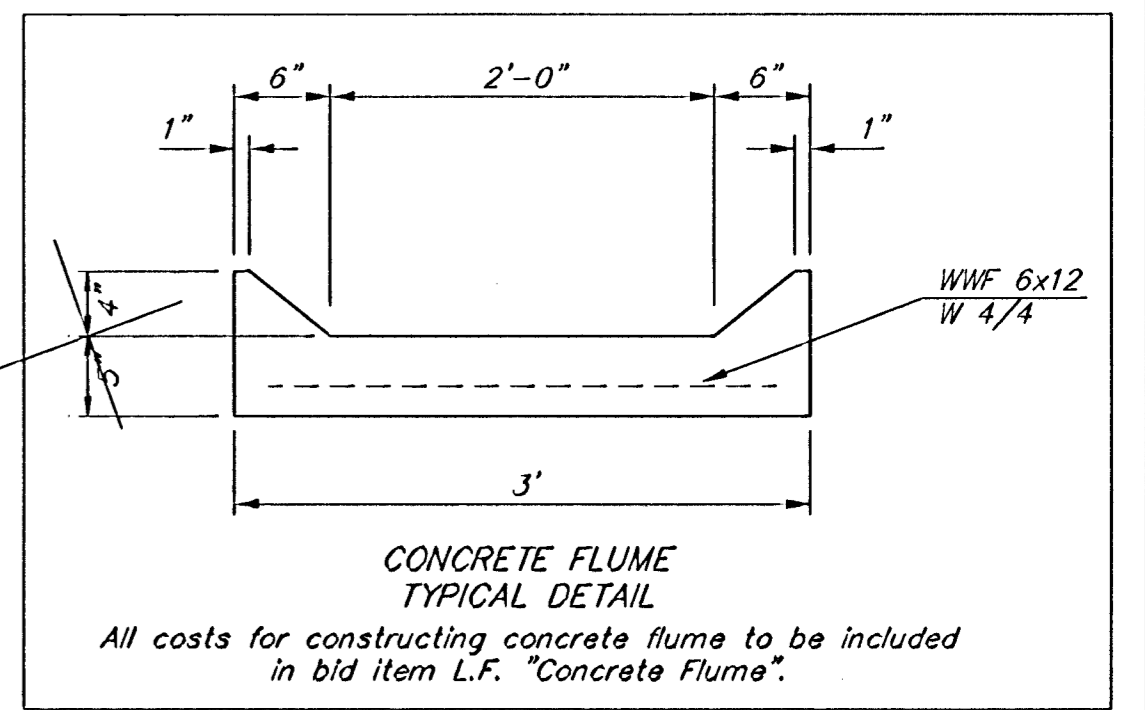
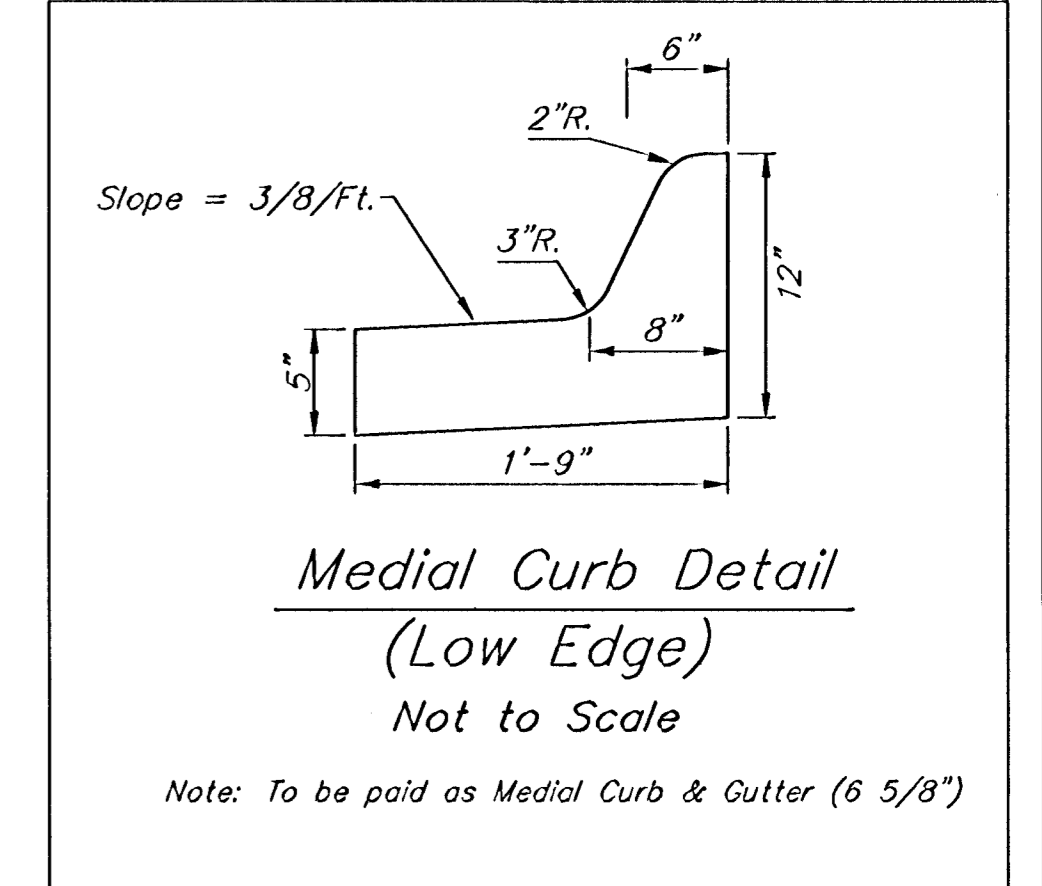

ANGEL FIRE ADDITION - PHASE 1
LEONINE
 STREET & INCIDENTAL STORM WATER SEWER

BAUGHMAN COMPANY P.A.
 ENGINEERING, SURVEYING, & PLANNING
 318-262-7271 • 315 ELLIS • WICHITA, KANSAS 67211

PROJECT NUMBER: 472-83292
 SHEET: 6 OF 28
 DESIGN: BLP/AEG DRAWN: AEG APPROVED: DATE: 3/28/01 SCALE: NOTED