

**BENCHMARKS:**  
 Railroad Spike in Power Pole  
 Located 27' South and 402' East  
 of the Northwest Corner of the  
 NE 1/4, Section 24, TWP. 28-S, R-1-W.  
 Elevation = 92.98 City Datum

City of Wichita Benchmark Disc SE Corner  
 of Intersection of 47th St. S. and West St.  
 42.10' E. of Centerline  
 51.00' S. of Centerline  
 99.80' E. of P.P. on SW Corner  
 23.80' S. of P.P.  
 Elevation = 92.29 City Datum

Scale:  
 1" = 20'  
 • = Iron

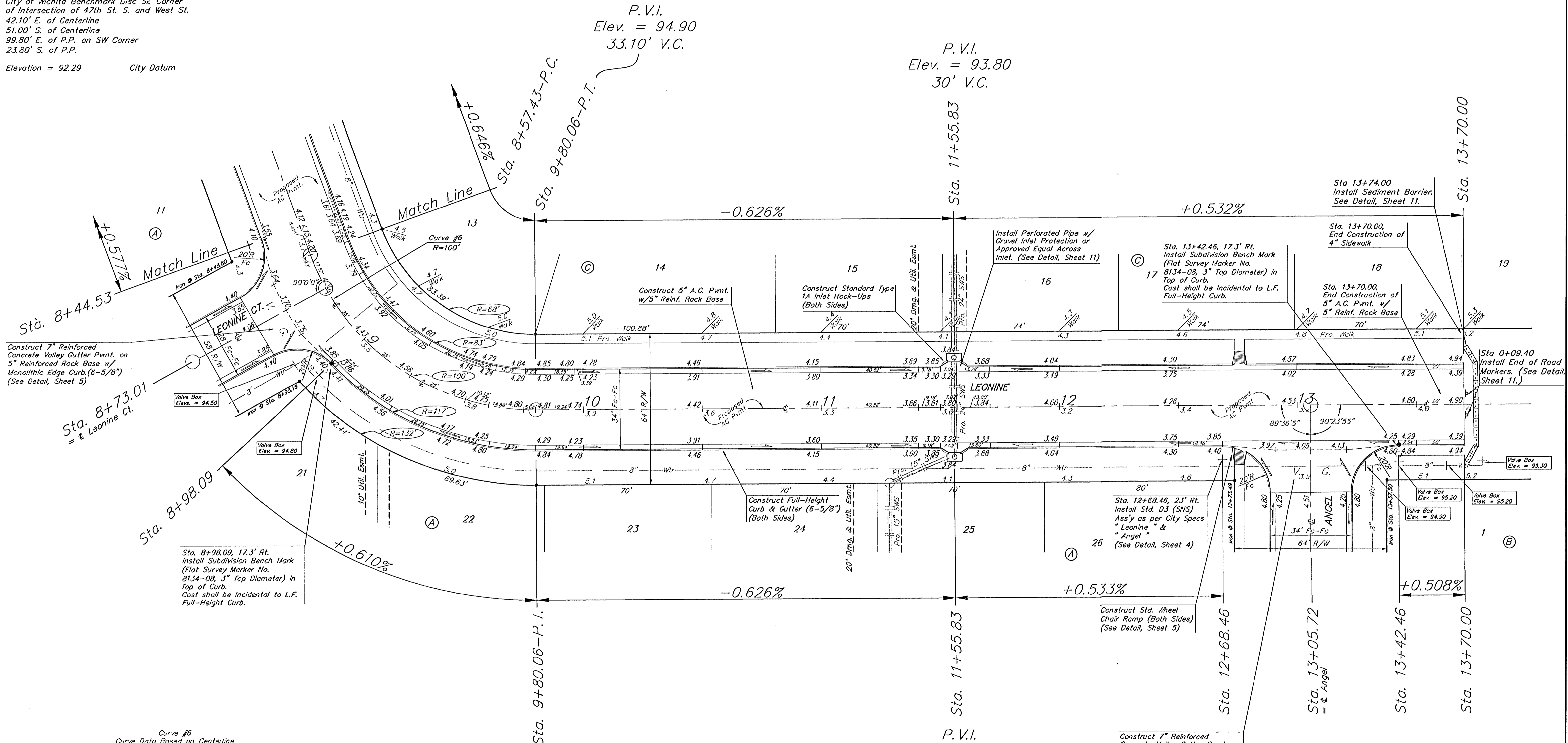

Curve #6  
 Curve Data Based on Centerline  
 Rad. = 100' Delta = 70° 15' 39" Tangent = 70.36'  
 Arc = 122.63' L.C. = 115.09' Del/Ft. = 17.18850 Min.

Station	Arc	8 Lt.	8 Rt.	Del.	T. Del.
8+57.43	-	-	-	0°00'00"	0°00'00"
8+73.01	15.58'	14.32'	16.81'	4°27'48"	4°27'48"
8+75.00	1.99'	1.83'	2.15'	0°34'12"	5°02'00"
8+98.09	23.09'	21.20'	24.88'	6°36'53"	11°38'53"
9+00.00	1.91'	1.76'	2.06'	0°32'50"	12°11'43"
9+25.00	25.00'	22.94'	24.93'	7°09'43"	19°21'26"
9+50.00	25.00'	22.94'	24.93'	7°09'42"	26°31'08"
9+75.00	25.00'	22.94'	24.93'	7°09'43"	33°40'51"
9+80.06	5.06'	4.66'	5.46'	1°26'59"	35°07'50"

P.V.I.  
 Elev. = 94.90  
 39.88' V.C.

P.V.I.  
 Elev. = 93.80  
 30' V.C.

ANGEL FIRE ADDITION

ANGEL FIRE ADDITION - PHASE 1  
**LEONINE**  
 STREET & INCIDENTAL STORM SEWER IMPROVEMENTS  
**BAUGHMAN COMPANY P.A.**  
 ENGINEERING, SURVEYING, & PLANNING  
 316-262-7271 • 315 ELLIS • WICHITA, KANSAS 67211  
 PROJECT NUMBER  
**472-83292**  
 SHEET **8**  
 DESIGN BLP/AEG DRAWN AEG APPROVED DATE 3/28/01 SCALE NOTED