

**BENCHMARKS:**

Railroad Spike in Power Pole  
 Located 27' South and 402' East  
 of the Northwest Corner of the  
 NE 1/4, Section 24, TWP. 28-S, R-1-W.  
 Elevation = 92.98 City Datum

City of Wichita Benchmark Disc SE Corner  
 of Intersection of 47th St. S. and West St.  
 42.10' E. of Centerline  
 51.00' S. of Centerline  
 99.80' E. of P.P. on SW Corner  
 23.80' S. of P.P.  
 Elevation = 92.29 City Datum

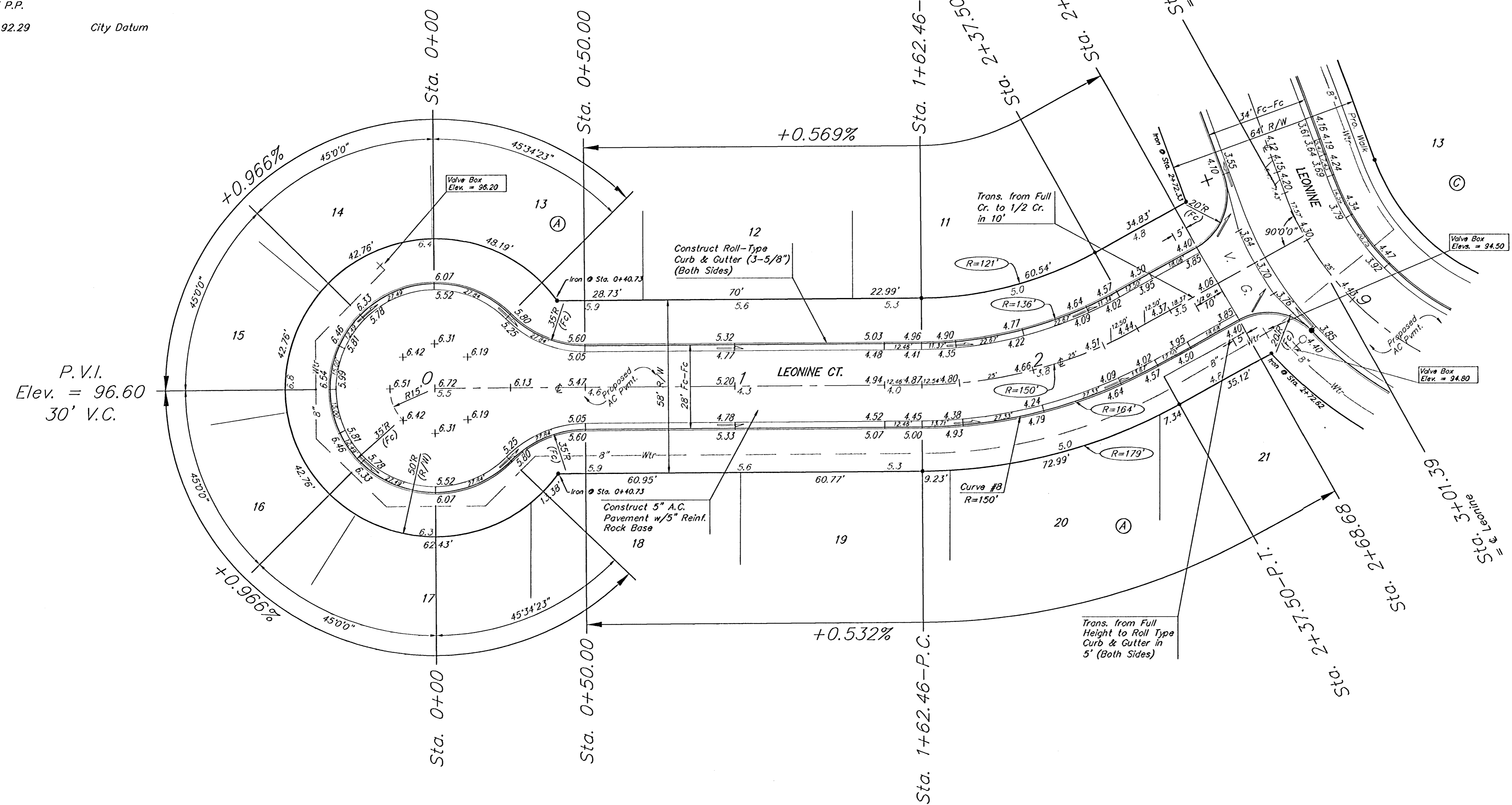
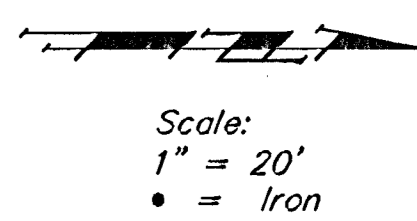

P.V.I.  
 Elev. = 96.60  
 30' V.C.

ANGEL FIRE ADDITION

Curve #8  
 Curve Data Based on Centerline  
 Rad. = 150' Delta = 28° 39' 55" Tangent = 38.33'  
 Arc = 75.05' L.C. = 74.27' Def. Pt. = 11.45847 Min.

Station	Arc	CHORD LENGTHS		Dell.	T. Dell.
		B Lt.	B Rt.		
1+62.46	—	—	—	0'00"00"	0'00"00"
1+75.00	12.54'	10.70'	14.37'	2'23'41"	2'23'41"
2+00.00	25.00'	21.31'	28.63'	4'46'28"	7'10'09"
2+25.00	25.00'	21.31'	28.63'	4'46'28"	11'56'37"
2+37.50	12.50'	10.66'	14.33'	2'23'14"	14'19'51"

Roll Type Curb & Gutter to be  
 Constructed on the Pavement Shown  
 on this Sheet. Top of Curb Elevations  
 are Given for Full Height Curb.

ANGEL FIRE ADDITION - PHASE 1  
**LEONINE CT.**  
 STREET & INCIDENTAL STORM SEWER IMPROVEMENTS

**BAUGHMAN COMPANY P.A.**  
 ENGINEERING, SURVEYING, & PLANNING  
 318-282-7271 • 313 ELLIS • WICHITA, KANSAS 67211

PROJECT NUMBER  
**472-83292**

DESIGN: BLP/AEG DRAWN: AEG APPROVED: DATE: 3/28/01 SCALE: NOTED

SHEET **10** OF **28**