

Benchmark:

Railroad Spike in Power Pole
 Located 27' South and 402' East
 of the Northwest Corner of the
 NE 1/4, Section 24, TWP. 28-S, R-1-W.

Elevation = 92.98 City Datum

City of Wichita Benchmark Disc SE Corner
 of Intersection of 47th St. S. and West St.
 42.10' E. of Centerline
 51.00' S. of Centerline
 99.80' E. of P.P. on SW Corner
 23.80' S. of P.P.

Elevation = 92.29 City Datum

Scale:
 1" = 20' Horizontal
 1" = 5' Vertical
 • = Iron

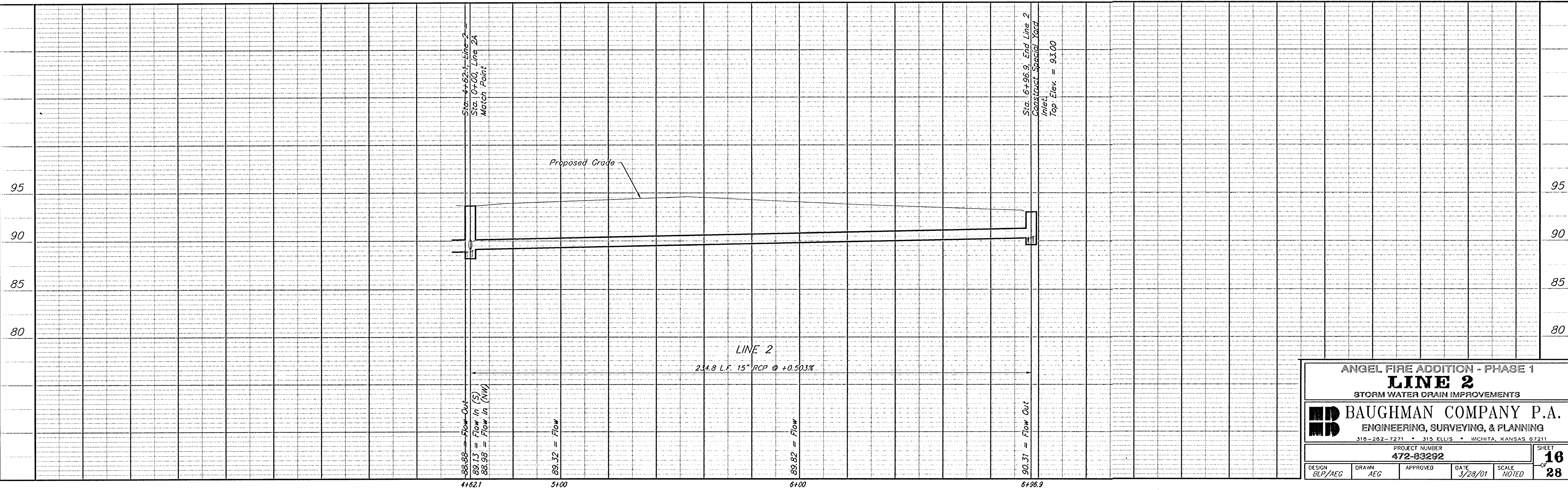
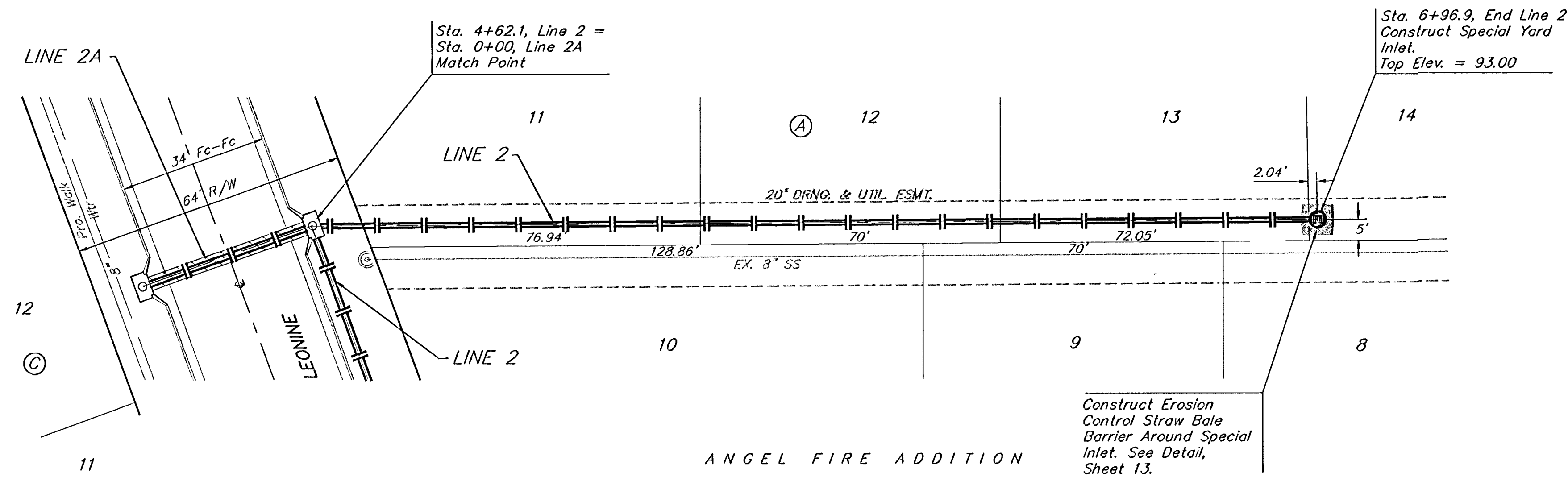

ANGEL FIRE ADDITION - PHASE 1
LINE 2
 STORM WATER DRAIN IMPROVEMENTS

BAUGHMAN COMPANY P.A.
 ENGINEERING, SURVEYING, & PLANNING
 318-262-7271 • 315 ELLIS • WICHITA, KANSAS 67211

PROJECT NUMBER
472-83292

DESIGN: BLP/AEG DRAWN: AEG APPROVED: _____ DATE: 3/28/01 SCALE: NOTED

SHEET **16** OF **28**

00-11-EG87
 F. Angel Fire Issues