

SCALE 1"=100'

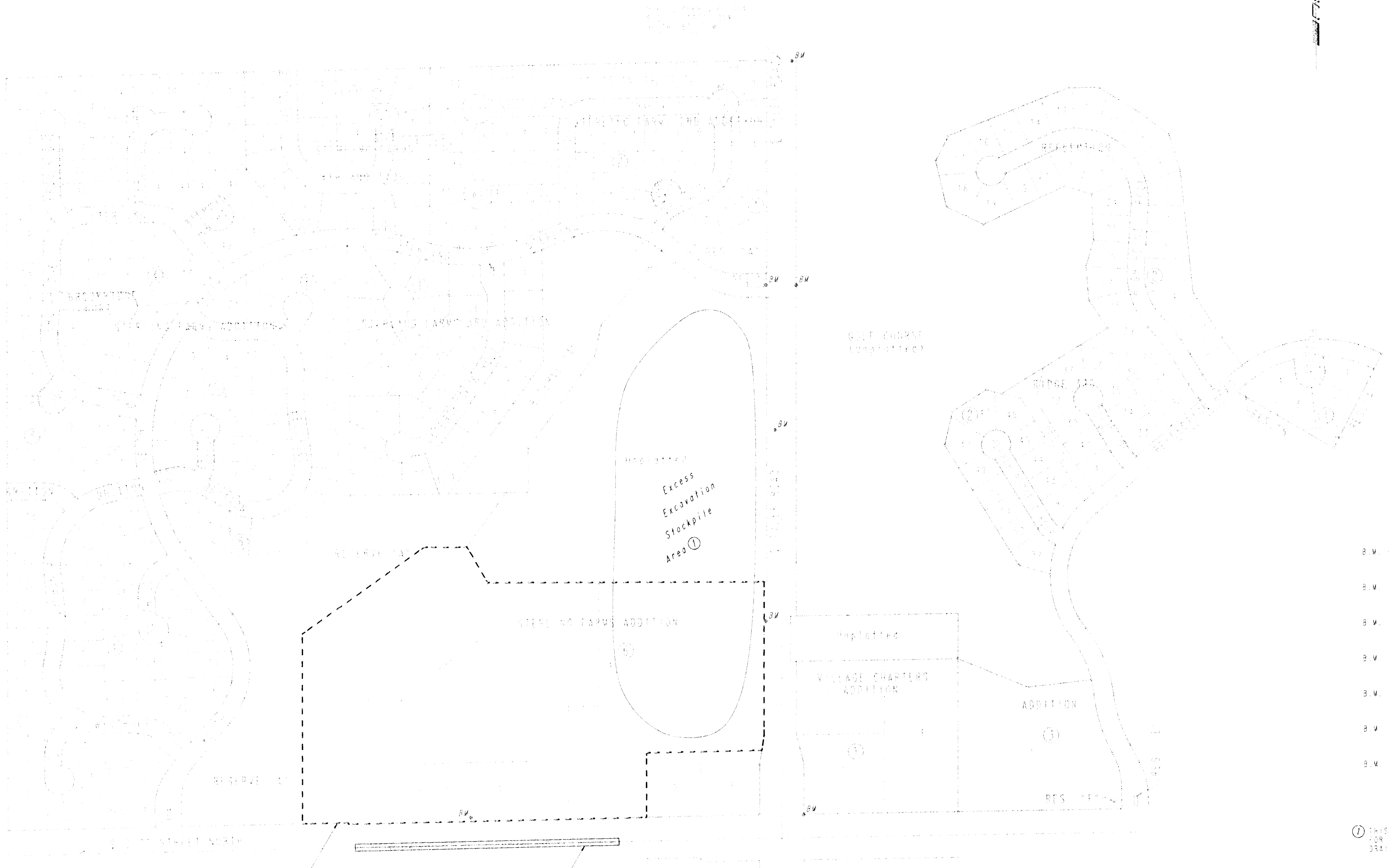

PLAN	SURVEYED	DATE
ANGLE	PLOTTED	BY
NO.	ALIGNMENT	CHECKED
	NO.	DATE

DRAWING MADE BY 94420-3 (L) FROM REF. M4
 CHECKED BY [Name]
 DATE LAST APPROVED ON [Date]

- B.M. - CITY OF WICHITA DISC AT NORTHEAST CORNER 21ST STREET NORTH AND TYLER ROAD. ELEV. +170.90
- B.M. - CITY OF WICHITA DISC 45' EAST OF EAST 1/4 CORNER SECTION 5, T27S, R1W. ELEV. +165.53
- B.M. - RAILROAD SPIKE IN POWER POLE APPROX. STA. 8+34.48' LT. ELEV. +166.65
- B.M. - RAILROAD SPIKE IN POWER POLE APPROX. STA. 14+81.48' LT. ELEV. +167.87
- B.M. - CHISELED "D" ON MEDIAN NOSE IN STERLING, WEST SIDE TYLER ROAD. ELEV. +165.91
- B.M. - "T" POST IN EAST RIGHT-OF-WAY OF TYLER ROAD AT STERLING. STA. 19+79.48' RT. ELEV. +164.32
- B.M. - RAILROAD SPIKE IN POWER POLE, 10' WEST OF S.E. CORNER, LOT 2, BLOCK 5, STERLING FARMS. ELEV. +164.88

① THIS AREA IS APPROXIMATE. CONTACT THE OWNER (JACK RITCHIE, 684-7300) FOR EXACT LOCATION. MATERIAL SHALL BE BLADED SMOOTH AND SLOPED TO DRAIN BY THE CONTRACTOR AT NO ADDITIONAL COST.

IMPROVEMENT DISTRICT BOUNDARY

LEFT TURN LANE IMPROVEMENTS

21ST STREET NORTH

KEY MAP LEFT TURN LANE

PROFESSIONAL ENGINEERING CONSULTANTS, P.A.
ENGINEERS
WICHITA, KANSAS

Designed by	MRB, GDD	Checked by	
Drawn by	DEP	Date	NOV. 1994
		Job No.	94420-3