

SCALE: 1"=20'

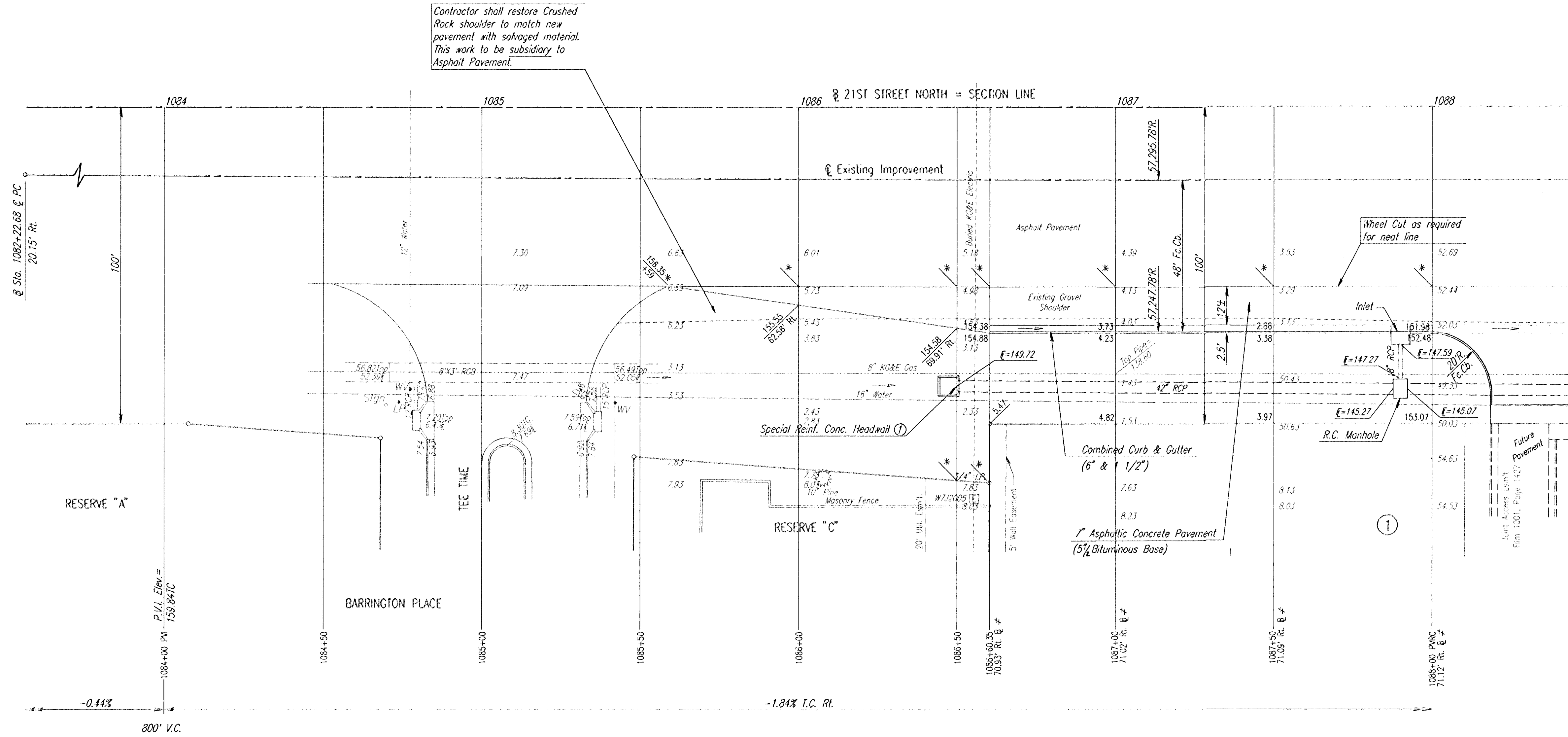

Contractor shall restore Crushed Rock shoulder to match new pavement with salvaged material. This work to be subsidiary to Asphalt Pavement.

Curve Data
 $\Delta = 0^\circ 58' 00''$
 $D = 0^\circ 06' 00''$
 $R = 57,295.78'$
 $L = 966.67'$
 $T = 483.35'$
 $E = 2.04'$

① Contractor to shape fill behind curb to match Special Reinf. Conc. Headwall constructed by Storm Water Sewer Contractor.

NOTE: STORM SEWER PIPES AND STRUCTURES TO BE CONSTRUCTED BY OTHERS UNDER C.O.M.
 PROJ. NO. 468-76-245-81911-000-000-001.
 * MATCH EXISTING EDGE OF PAVEMENT PLUS 1/2"
 # FACE OF CURB

usr/ustw/dgn: 995/95325/plan/dgn
 date: plotted: 8/8/95
 deliver to: awwa/ra dunn

BARRINGTON CORNER DECEL LANE

21ST STREET NORTH

STA. 1084+00 TO STA. 1088+00

PROFESSIONAL ENGINEERING CONSULTANTS, P.A.
 ENGINEERS
 WICHITA, KANSAS

Designed by	BER, GDD	Checked by	
Drawn by	DEP	Date	AUG., 1995
		Job No.	95325