

BENCHMARKS:
 City of Wichita Benchmark
 Disk 32.6' N and 24.5' E
 of Intersection of 135th St. W.
 and Central. 39.5' NE of Iron at
 Section Corner.
 Elev. = 159.50 (City Datum)

" " Cut Rear Center of Inlet Top
 Adjacent to SE Corner, Lot 19,
 Block C, Highland Springs 2nd
 Addition.
 Elev. = 175.35 (City Datum)

" " Cut Top of Curb Adjacent to
 SE Corner, Lot 21, Block D,
 Highland Springs 2nd Addition.
 Elev. = 176.54 (City Datum)

P.V.I.
 Elev. = 177.50
 No V.C.

HIGHLAND SPRINGS 2ND ADDITION

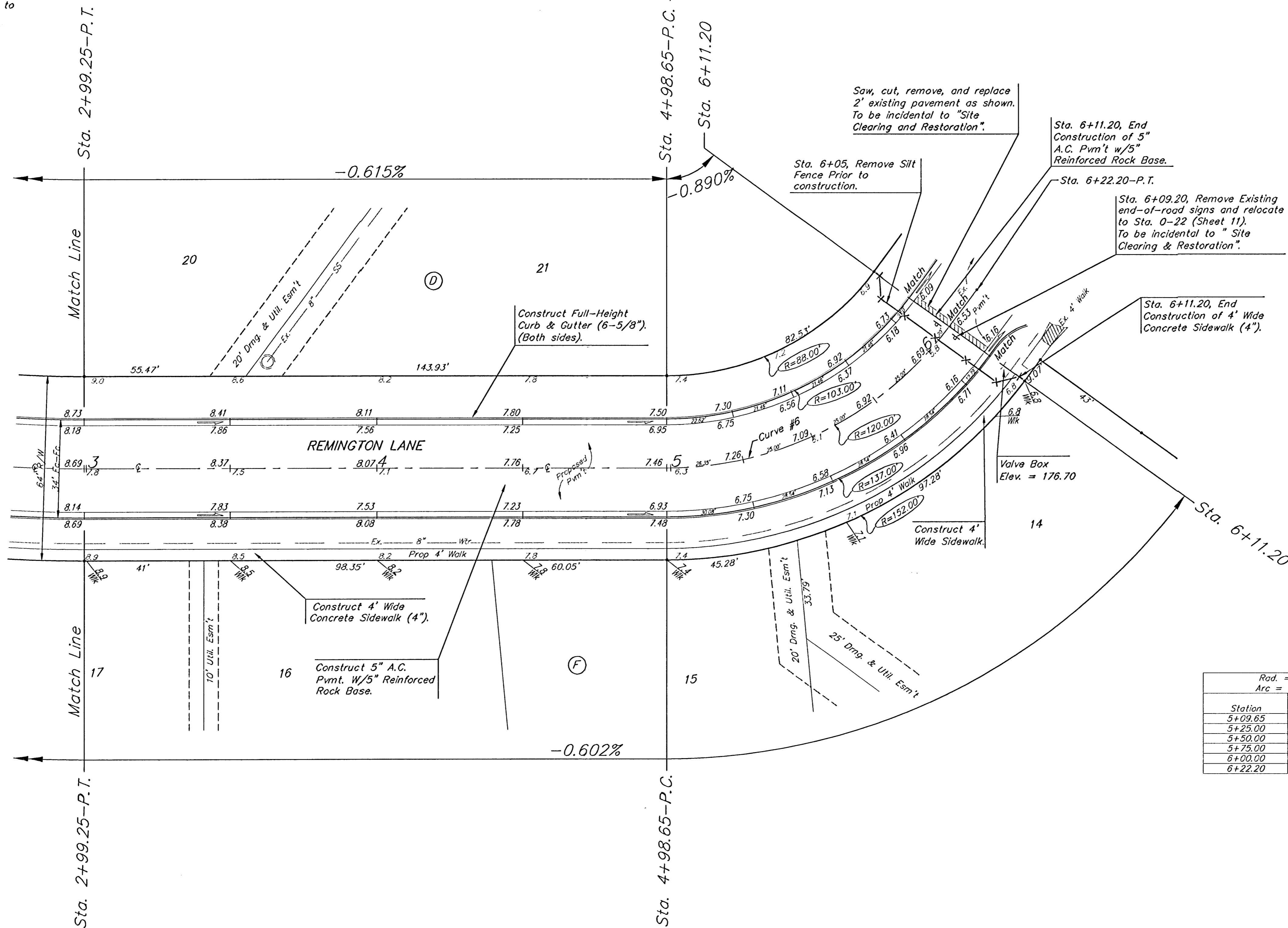
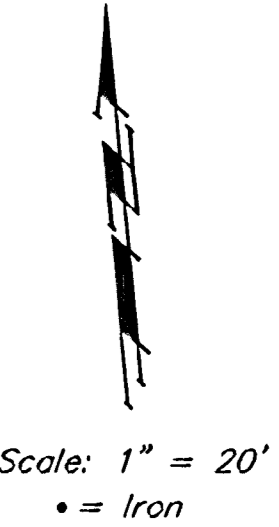

Saw, cut, remove, and replace
 2' existing pavement as shown.
 To be incidental to "Site
 Clearing and Restoration".

Sta. 6+05, Remove Silt
 Fence Prior to
 construction.

Sta. 6+11.20, End
 Construction of 5"
 A.C. Pvm't w/5"
 Reinforced Rock Base.

Sta. 6+22.20-P.T.

Sta. 6+09.20, Remove Existing
 end-of-road signs and relocate
 to Sta. 0-22 (Sheet 11).
 To be incidental to "Site
 Clearing & Restoration".

Sta. 6+11.20, End
 Construction of 4' Wide
 Concrete Sidewalk (4").

Curve #6
 Curve Data Based on Centerline
 Rad. = 120' Delta = 53° 44' 12" Tangent = 60.80'
 Arc = 112.55' L.C. = 108.47' Del/Ft. = 14.32341 Min.

Station	Arc	FACE CHORD LENGTHS		Defl.	T. Defl.
		B' Lt.	B' Rt.		
5+09.65	-	-	-	0°00'00"	0°00'00"
5+25.00	15.35'	12.14'	18.53'	3°39'52"	3°39'52"
5+50.00	25.00'	19.76'	30.15'	5°58'05"	9°37'57"
5+75.00	25.00'	19.76'	30.15'	5°58'05"	15°36'02"
6+00.00	25.00'	19.76'	30.15'	5°58'05"	21°34'07"
6+22.20	22.20'	17.55'	26.79'	5°17'59"	26°52'06"

HIGHLAND SPRINGS 2ND ADDITION - PHASE II
REMINGTON LANE
 STA 2+99.25 TO STA 6+11.20

BAUGHMAN COMPANY P.A.
 ENGINEERING, SURVEYING, & PLANNING
 315-282-7271 • 313 ELLIS • WICHITA, KANSAS 67211

PROJECT NUMBER
472-83143

DESIGN BP/IMG DRAWN CNX APPROVED DATE 2-13-02 SCALE Noted

SHEET **12** OF **32**