

BENCHMARKS:
 City of Wichita Benchmark
 Disk 32.6' N and 24.5' E
 of Intersection of 135th St. W.
 and Central. 39.5' NE of Iron at
 Section Corner.
 Elev. = 159.50 (City Datum)

" " Cut Rear Center of Inlet Top
 Adjacent to SE Corner, Lot 19,
 Block C, Highland Springs 2nd
 Addition.
 Elev. = 175.35 (City Datum)

" " Cut Top of Curb Adjacent to
 SE Corner, Lot 21, Block D,
 Highland Springs 2nd Addition.
 Elev. = 176.54 (City Datum)

Curve #10
 Curve Data Based on Centerline
 Rad. = 150' Delta = 15° 50' 07" Tangent = 20.86'
 Arc = 41.46' L.C. = 41.32' Del/Ft. = 11.45966 Min.

Station	Arc	FACE CHORD LENGTHS		Defl.	T. Defl.
		B' Lt.	B' Rt.		
0+33.14	-	-	-	0'00"00"	0'00"00"
0+37.58	4.44'	3.79'	5.09'	0'50"52"	0'50"52"
0+40.21	2.63'	2.25'	3.02'	0'30"09"	1'21"01"
0+50.00	9.79'	8.35'	11.22'	1'52"10"	3'13"11"
0+74.60	24.60'	20.97'	28.17'	4'41"53"	7'55"04"

Curve #11
 Curve Data Based on Centerline
 Rad. = 150' Delta = 40° 04' 28" Tangent = 54.71'
 Arc = 104.91' L.C. = 102.79' Del/Ft. = 11.45966 Min.

Station	Arc	FACE CHORD LENGTHS		Defl.	T. Defl.
		B' Lt.	B' Rt.		
0+74.60	-	-	-	0'00"00"	0'00"00"
0+75.00	0.40'	0.46'	0.34'	0'04"35"	0'04"35"
1+00.00	25.00'	28.64'	21.31'	4'46"30"	4'51"05"
1+25.00	25.00'	28.63'	21.31'	4'46"29"	9'37"34"
1+50.00	25.00'	28.64'	21.31'	4'46"30"	14'24"04"
1+75.00	25.00'	28.63'	21.31'	4'46"29"	19'10"33"
1+79.51	4.91'	5.12'	3.85'	0'51"41"	20'02"14"

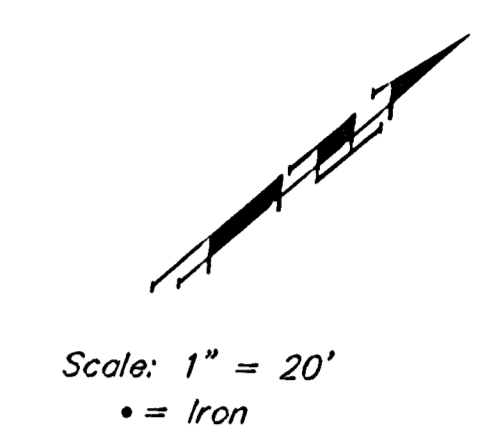
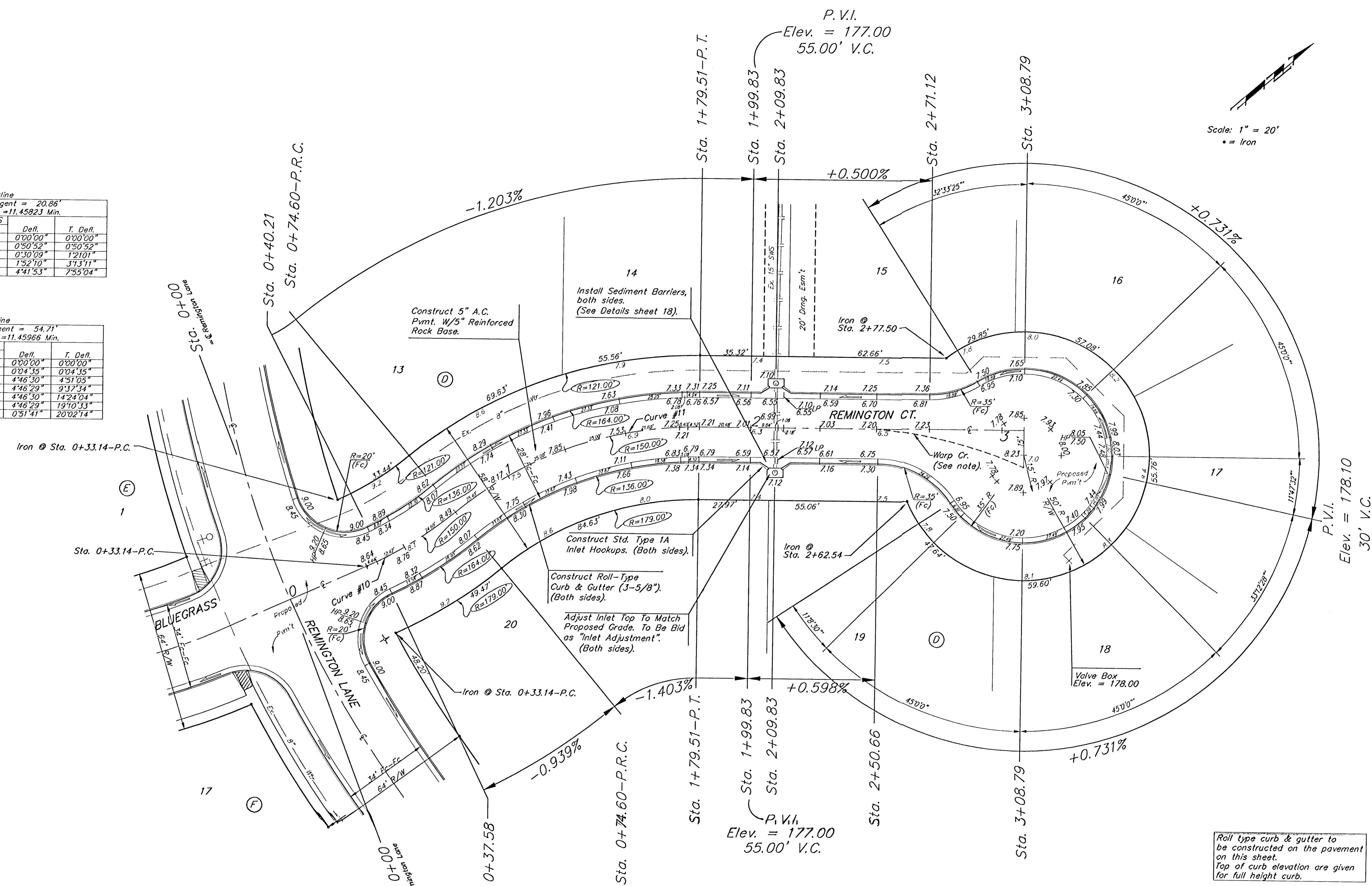

HIGHLAND SPRINGS 2ND ADDITION

HIGHLAND SPRINGS 2ND ADDITION - PHASE II
REMINGTON CT.
 Lots 13-20, Block D

BAUGHMAN COMPANY P.A.
 ENGINEERING, SURVEYING, & PLANNING
 316-262-7271 • 315 ELLIS • WICHITA, KANSAS 67211

PROJECT NUMBER
472-83143

DESIGN: BP/IMG DRAWN: CNX APPROVED: DATE: 2-13-02 SCALE: Noted

SHEET **13** OF **32**

Note: Warp Crown to conform to Approx. Center of proposed pavement.

P.V.I.
 Elev. = 178.62
 No V.C.

P.V.I.
 Elev. = 177.00
 55.00' V.C.

P.V.I.
 Elev. = 178.10
 30' V.C.