

BENCHMARKS:

City of Wichita Benchmark
Disk 32.6' N and 24.5' E
of Intersection of 135th St. W
and Central, 39.5' NE of Iron at
Section Corner.
Elev. = 159.50 (City Datum)

"□" Cut Rear Center of Inlet Top
Adjacent to SE Corner, Lot 19,
Block C, Highland Springs 2nd
Addition.
Elev. = 175.35 (City Datum)

"□" Cut Top of Curb Adjacent to
SE Corner, Lot 21, Block D,
Highland Springs 2nd Addition.
Elev. = 176.54 (City Datum)

HIGHLAND SPRINGS 2ND ADDITION

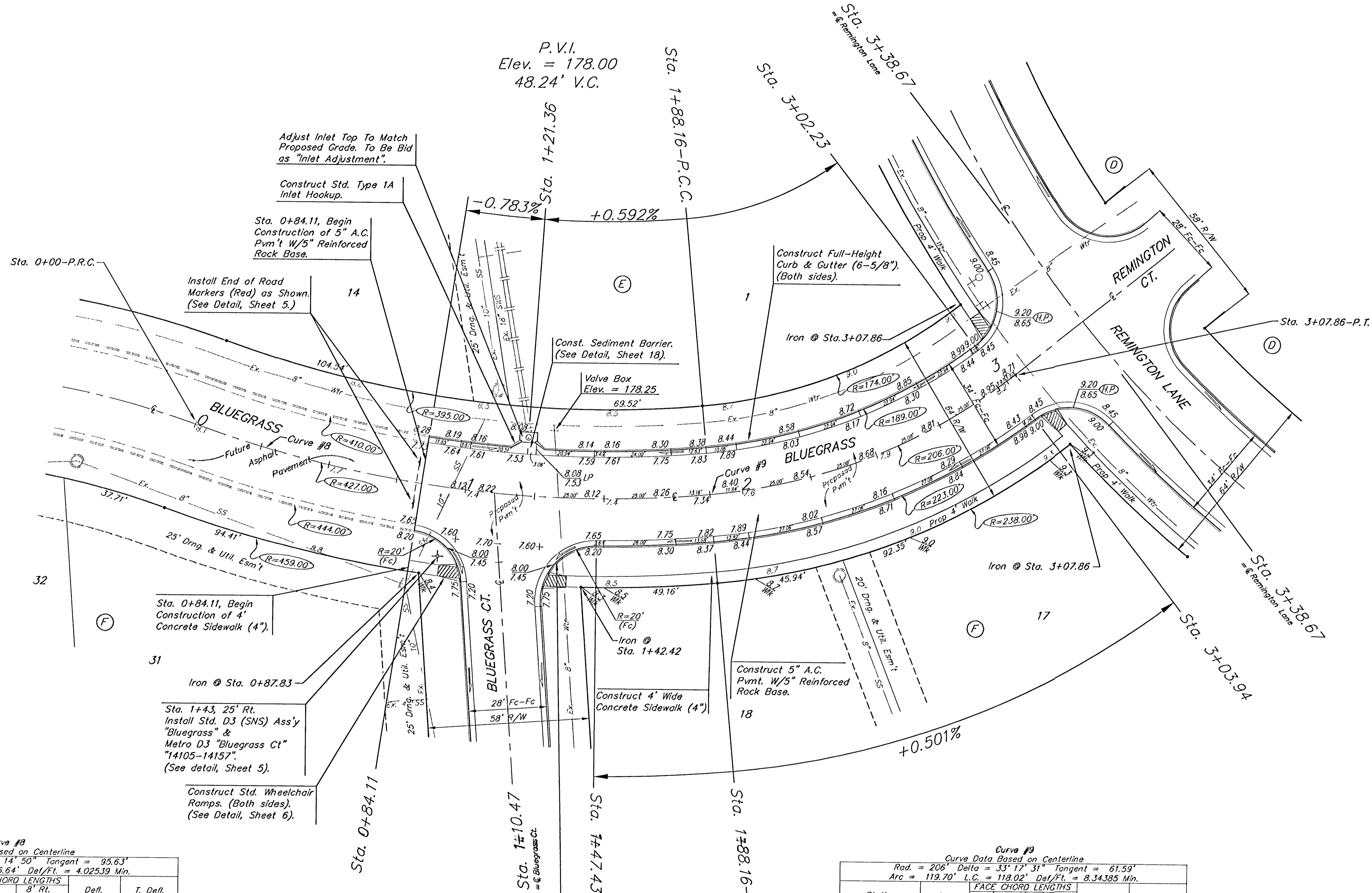
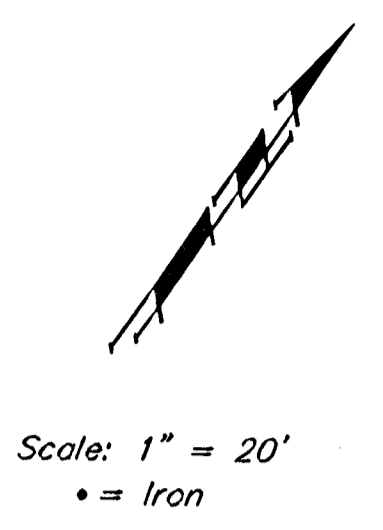

Curve #8
Curve Data Based on Centerline
Rad. = 427' Delta = 25° 14' 50" Tangent = 95.63'
Arc = 188.16' L.C. = 186.64' Def/Ft. = 4.02539 Min.

Station	Arc	FACE CHORD LENGTHS		Defl.	T. Defl.
		8' Lt.	8' Rt.		
0+00.00	-	-	-	0'00"00"	0'00"00"
0+25.00	25.00'	23.53'	26.46'	1'40'38"	1'40'38"
0+50.00	25.00'	23.53'	26.46'	1'40'38"	3'21'16"
0+75.00	25.00'	23.53'	26.46'	1'40'38"	5'01'54"
0+84.11	9.11'	8.58'	9.65'	0'36'41"	5'38'35"
1+00.00	15.89'	14.96'	16.82'	1'03'57"	6'42'32"
1+10.47	10.47'	9.86'	11.08'	0'42'09"	7'24'41"
1+25.00	14.53'	13.68'	15.38'	0'58'29"	8'23'10"
1+47.43	22.43'	21.12'	23.74'	1'30'18"	9'53'28"
1+50.00	2.57'	2.42'	2.72'	0'10'20"	10'03'48"
1+75.00	25.00'	23.53'	26.46'	1'40'39"	11'44'27"
1+88.16	13.16'	12.39'	13.93'	0'52'58"	12'37'25"

Curve #9
Curve Data Based on Centerline
Rad. = 206' Delta = 33° 17' 31" Tangent = 61.59'
Arc = 119.70' L.C. = 118.02' Def/Ft. = 3.34385 Min.

Station	Arc	FACE CHORD LENGTHS		Defl.	T. Defl.
		8' Lt.	8' Rt.		
1+88.16	-	-	-	0'00"00"	0'00"00"
2+00.00	11.84'	10.40'	13.27'	1'38'47"	1'38'47"
2+25.00	25.00'	21.95'	28.02'	3'28'36"	5'07'23"
2+50.00	25.00'	21.95'	28.02'	3'28'36"	8'35'59"
2+75.00	25.00'	21.95'	28.02'	3'28'36"	12'04'35"
3+00.00	25.00'	21.95'	28.01'	3'28'36"	15'33'11"
3+02.23	2.23'	1.96'	2.50'	0'18'36"	15'51'47"
3+07.86	5.63'	4.95'	6.31'	0'46'59"	16'38'46"

HIGHLAND SPRINGS 2ND ADDITION - PHASE II
BLUEGRASS
STA 0+49.71 TO STA 3+03.94

BAUGHMAN COMPANY P.A.
ENGINEERING, SURVEYING, & PLANNING
316-262-7271 • 315 ELLIS • WICHITA, KANSAS 67211

PROJECT NUMBER
472-63143

DESIGN: EP/TMG DRAWN: CNX APPROVED: DATE: 2-13-02 SCALE: Noted

SHEET **14** OF **32**