

**BENCHMARKS:**  
 City of Wichita Benchmark  
 Disk 32.6' N and 24.5' E  
 of Intersection of 135th St. W  
 and Central. 39.5' NE of Iron at  
 Section Corner.  
 Elev. = 159.50 (City Datum)

" " Cut Rear Center of Inlet Top  
 Adjacent to SE Corner, Lot 19,  
 Block C, Highland Springs 2nd  
 Addition.  
 Elev. = 175.35 (City Datum)

" " Cut Top of Curb Adjacent to  
 SE Corner, Lot 21, Block D,  
 Highland Springs 2nd Addition.  
 Elev. = 176.54 (City Datum)

P. V.I.  
 Elev. = 171.30  
 87.00' V.C.

HIGHLAND SPRINGS 2ND ADDITION

Scale: 1" = 20'  
 • = Iron

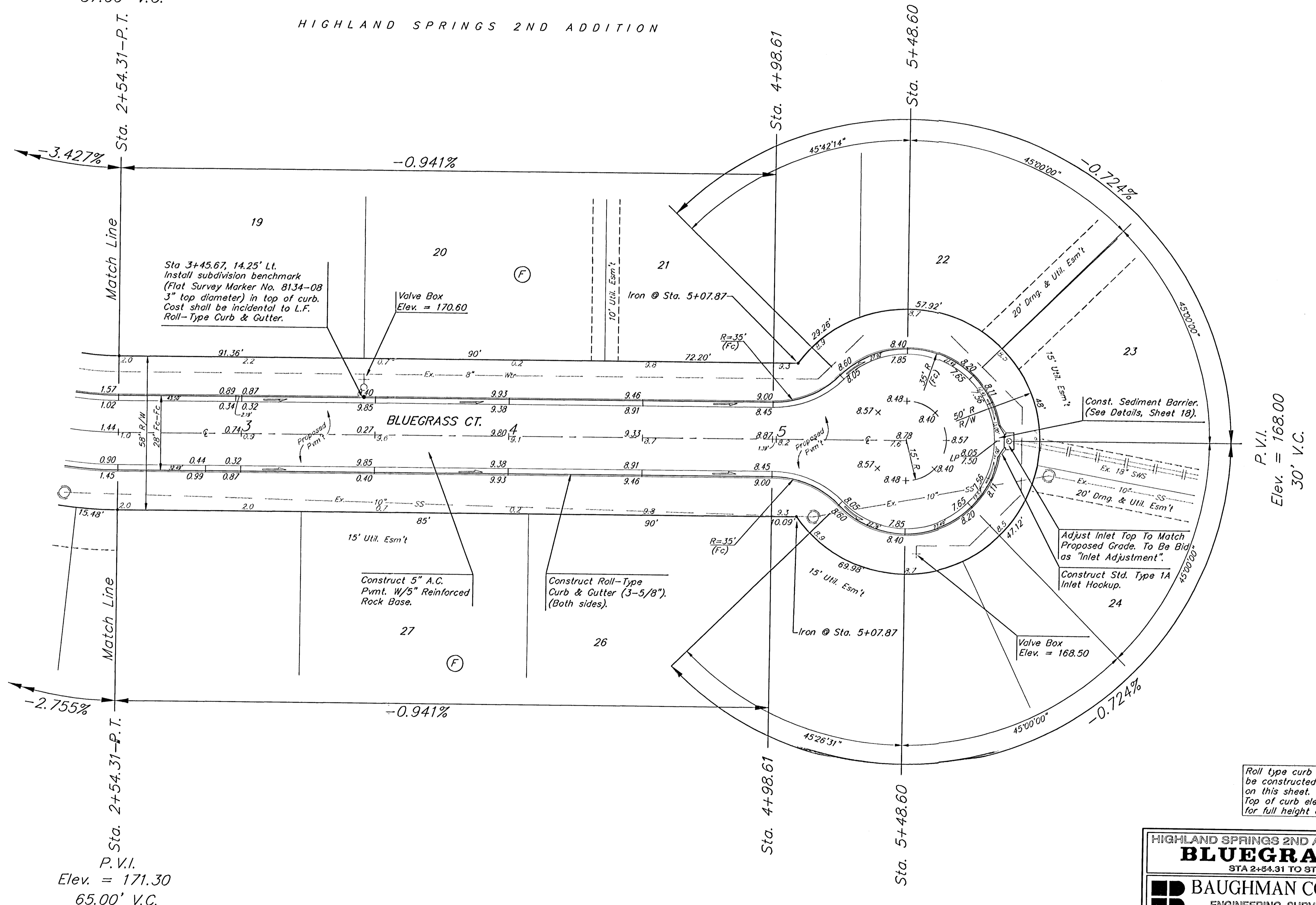

P. V.I.  
 Elev. = 168.00  
 30' V.C.

P. V.I.  
 Elev. = 171.30  
 65.00' V.C.

Roll type curb & gutter to  
 be constructed on the pavement  
 on this sheet.  
 Top of curb elevation are given  
 for full height curb.

HIGHLAND SPRINGS 2ND ADDITION - PHASE II  
**BLUEGRASS CT.**  
 STA 2+54.31 TO STA 5+48.60

**BAUGHMAN COMPANY P.A.**  
 ENGINEERING, SURVEYING, & PLANNING  
 316-262-7271 • 315 ELLIS • WICHITA, KANSAS 67211

PROJECT NUMBER  
**472-83143**

DESIGN: BP/TMG    DRAWN: GNX    APPROVED:    DATE: 2-13-02    SCALE: Noted

SHEET **16** OF **32**