

WATER VALVE BOX ELEVATIONS			
STREET	STATION	OFFSET	PROPOSED ELEVATION
PARKDALE COURT	25+92.99 (Ext'd.)	39.7' RL	178.7
PARKDALE COURT	26+43.04	22.0' LL	175.3

SCALE: 1"=20'

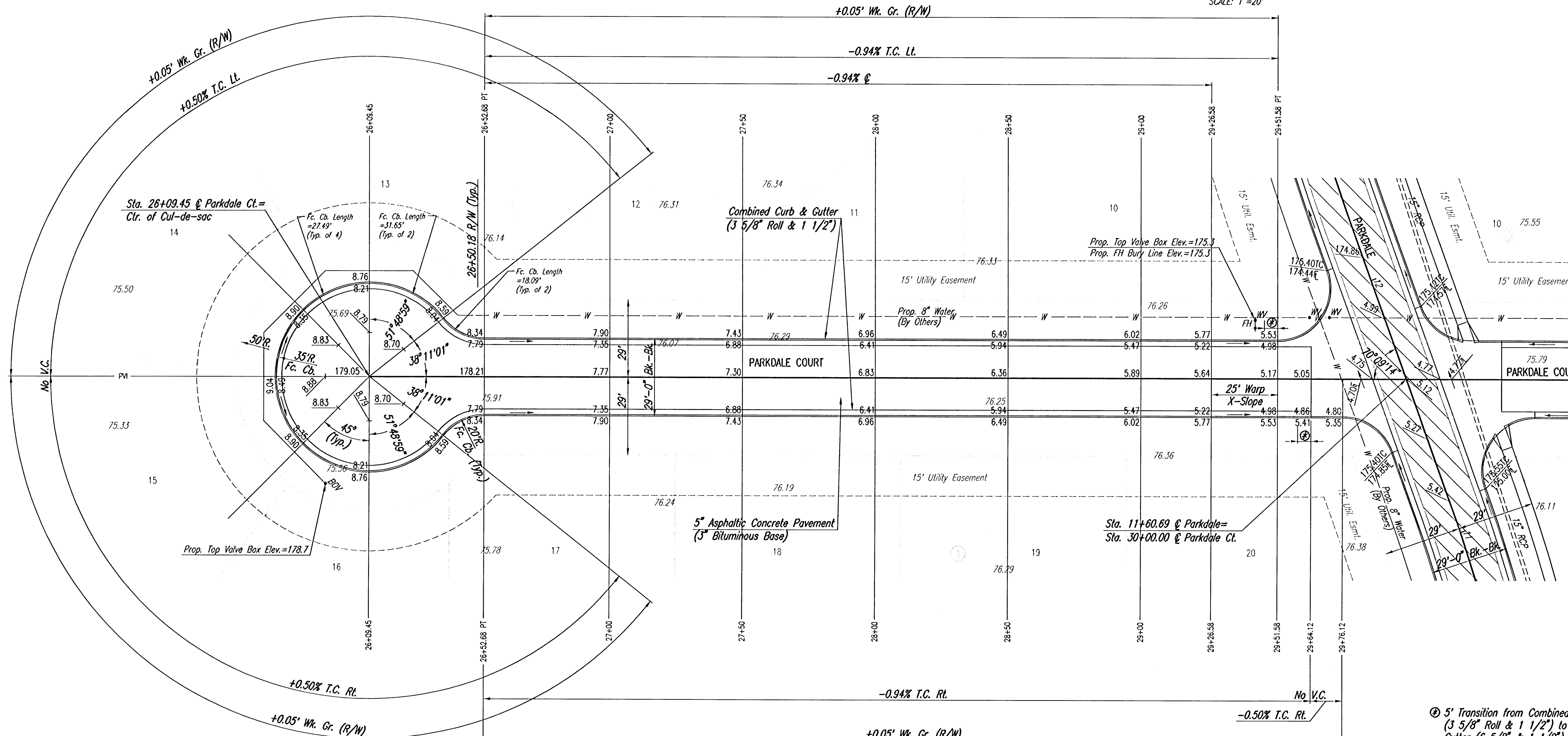

⊙ 5' Transition from Combined Curb and Gutter (3 5/8" Roll & 1 1/2") to Combined Curb and Gutter (6 5/8" & 1 1/2"). To be bid and paid for as "Combined Curb and Gutter (3 5/8" Roll & 1 1/2)".

NOTE: THIS STREET TO BE CONSTRUCTED WITH ROLL-TYPE CURB. TOP OF CURB ELEVATIONS GIVEN ARE FOR FULL HEIGHT CURB.

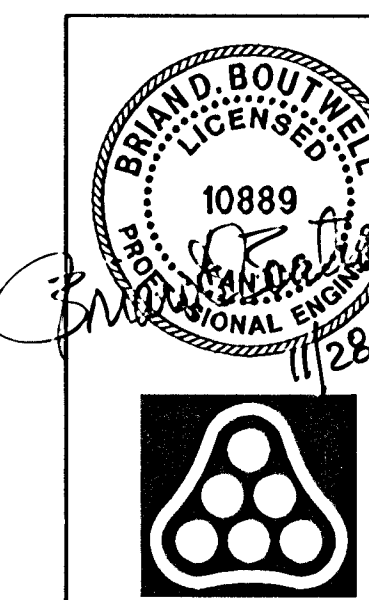

No.	Revision	By	Date
	EVERGREEN 5TH		
PARKDALE COURT			
STA. 26+09.45 TO STA. 30+00			
JAMES L. ARMOUR, P.E.—CITY ENGINEER CITY OF WICHITA PROJECT NO. 472-84103			
Professional Engineering Consultants, P.A.			
303 S. TOPEKA • WICHITA, KANSAS 67202 316-262-2691 • FAX 316-262-3003			
Designed by	BDB, BMM	Job No.	35-05415-000
Drawn by	BJS, BMM	Date	July 2005
			Sheet 9 of 45

DSNR: BLB OPER_BJS SCALE: 1"=20.00
 C:\2005\06415\000\05415-000-C-STP26-30 11-28-2005 09:39:38 am