

WATER VALVE BOX ELEVATIONS			
STREET	STATION	OFFSET	PROPOSED ELEVATION
PARKDALE COURT	32+24.76 (Extd.)	39.7' RL	176.2

SCALE: 1"=20'

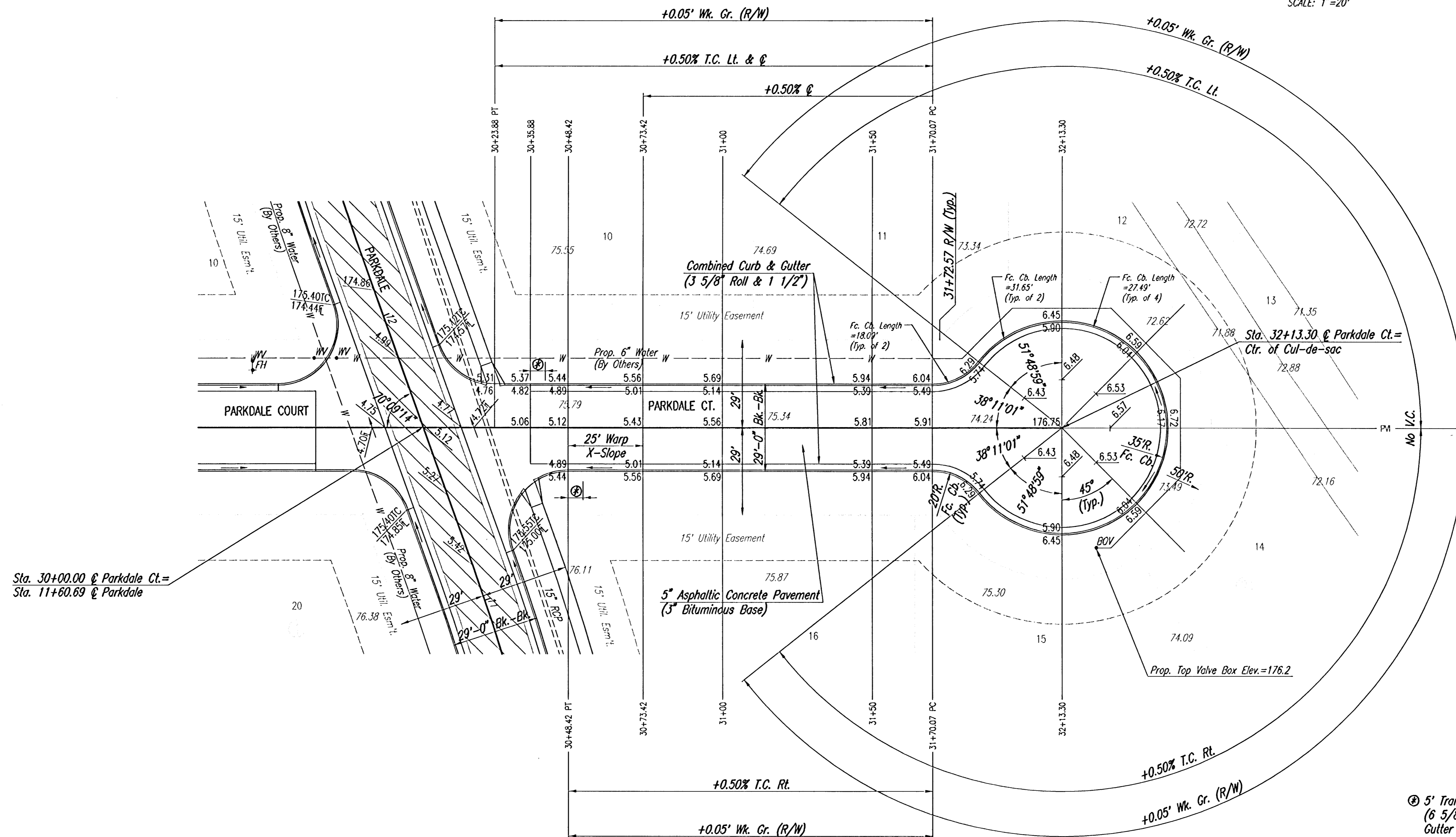

Sta. 30+00.00 @ Parkdale Ct. =  
Sta. 11+60.69 @ Parkdale

⑤ 5' Transition from Combined Curb and Gutter (6 5/8" & 1 1/2") to Combined Curb and Gutter (3 5/8" Roll & 1 1/2"). To be bid and paid for as "Combined Curb and Gutter (3 5/8" Roll & 1 1/2)".

NOTE: THIS STREET TO BE CONSTRUCTED WITH ROLL-TYPE CURB. TOP OF CURB ELEVATIONS GIVEN ARE FOR FULL HEIGHT CURB.

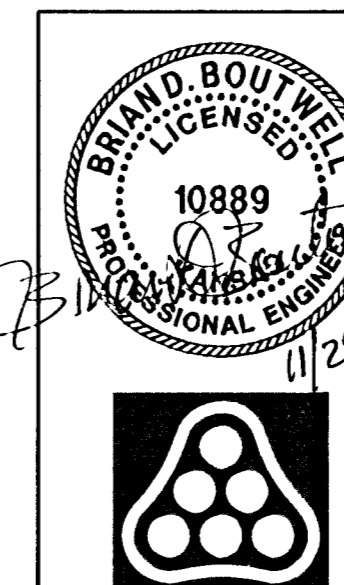

No.	Revision	By	Date
	EVERGREEN 5TH		
<b>PARKDALE COURT</b>			
STA. 30+00 TO STA. 32+13.30			
JAMES L. ARMOUR, P.E.—CITY ENGINEER CITY OF WICHITA PROJECT NO. 472-84103			
<b>Professional Engineering Consultants, P.A.</b>			
303 S. TOPEKA • WICHITA, KANSAS 67202 316-262-2691 • FAX 316-262-3003			
Designed by	BDB, BMM	Job No.	35-05415-000
Drawn by	BJS, BMM	Date	July 2005
			Sheet 10 of 45