

Scale: 1" = 60'

EROSION CONTROL PLAN LEGEND
(Installation Details Found in the SMP2 Plan)

- LIGHT STONE RIP-RAP
- DROP INLET PROTECTION
- CURB INLET PROTECTION
- DITCH CHECK
- SILT FENCING
- CUT-OFF TRENCH
- CURLEX BLANKET

NO SCALE

NOTES:
Stockpile excess material on-site as indicated on sheet 30. Earthwork quantities are for reference only. All cost associated with mass grading shall be incidental to lump sum bid item "Mass Grading".

- Contractor to strip top 3" of soil in areas of pond construction within Reserve "B", Falcon Falls 2nd Addition and street R/W before mass grading and stockpile. Top soil stockpile to be redistributed over reserve above water surface.
- Compaction of 95% shall be obtained in all street R/W's, 90% in all other areas.
- It shall be the Contractor's responsibility to protect any existing utilities during mass grading. Any damage done to these systems by Contractor or subcontractor shall be repaired at no additional cost to the project.
- Only trees within the street R/W or in areas of pond construction may be removed if necessary for grading. All other trees shall be protected from damage.
- All areas disturbed by construction (except within street R/W) shall be seeded as indicated on Pond Plan.

EARTHWORK TOTALS

	CY EXC	CY FILL
Mass Grading	12,873	25,956
Pond	20,531	80
GRAND TOTAL	33,404	26,036

	Existing Grade
	Proposed Grade

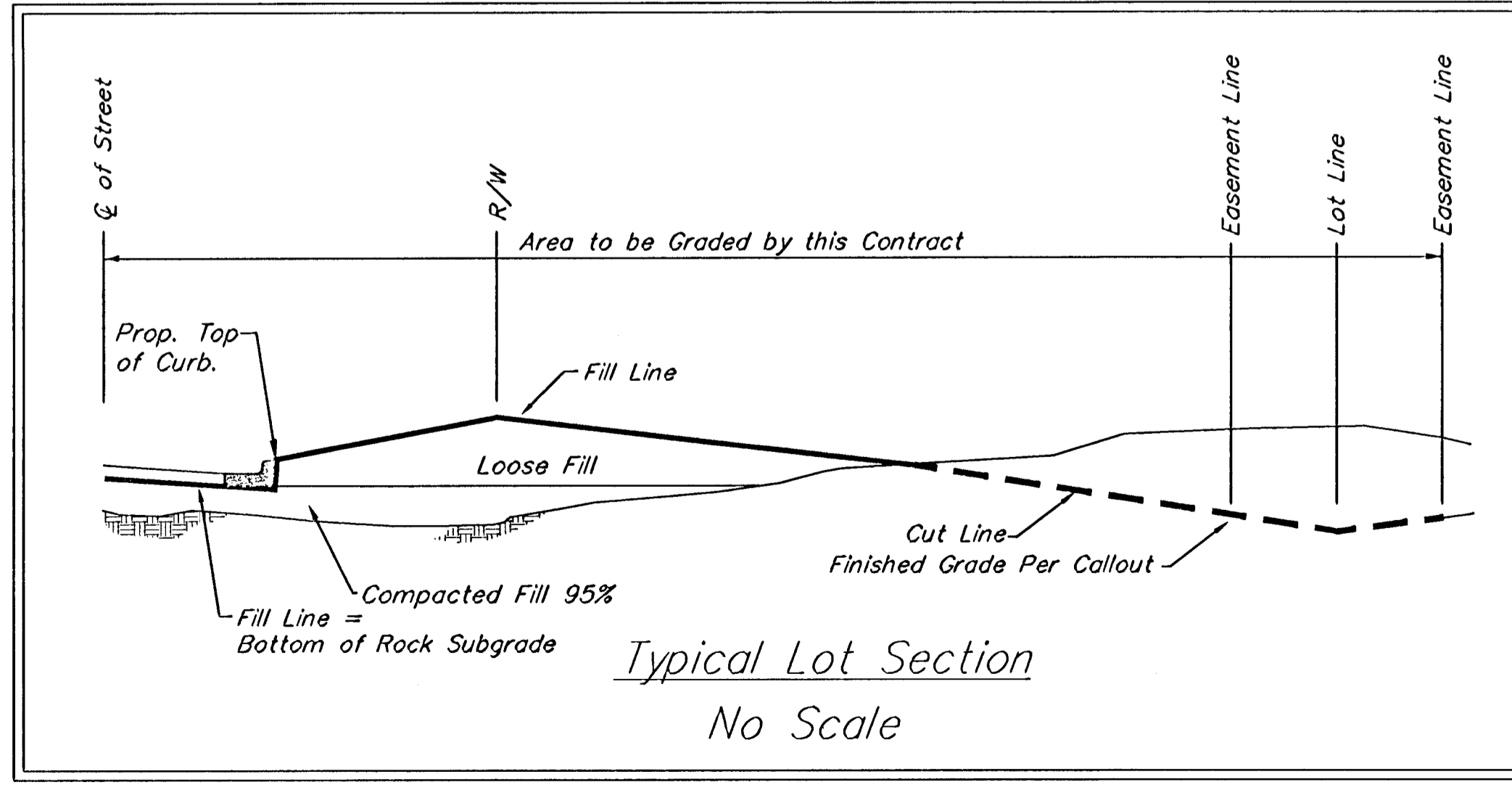

Baughman FALCON FALLS 2ND ADD. - PH. I
MASS GRADING PLAN & EROSION CONTROL PLAN
WICHITA, KANSAS

Baughman Company, P.A. 315 E. 11th St., Wichita, KS 67211 F 316-263-1271 F 316-262-0149
ENGINEERING | SURVEYING | PLANNING | LANDSCAPE ARCHITECTURE

PROJECT NUMBER 472-84264	DESIGN AEG	DRAWN TMS
REVISIONS:	APPROVED	DATE 01/06
SCALE Noted		SHEET 29 OF 44

FalconFalls2ndMsw1 05-10-E376