

BENCHMARKS:

"□" Cut top of curb on the southeast top of curb return, 46.66' East and 19.46' South of the intersection of Thurman & Evergreen
Elev. = 166.10 (city datum)

"□" Cut top of curb on the south side curb line of the north Suncrest Ave. a distance of 97.86' East & 2.17' South of Lot 1, Blk. A, English Country Gardens Addition.
Elev. = 158.61 (city datum)

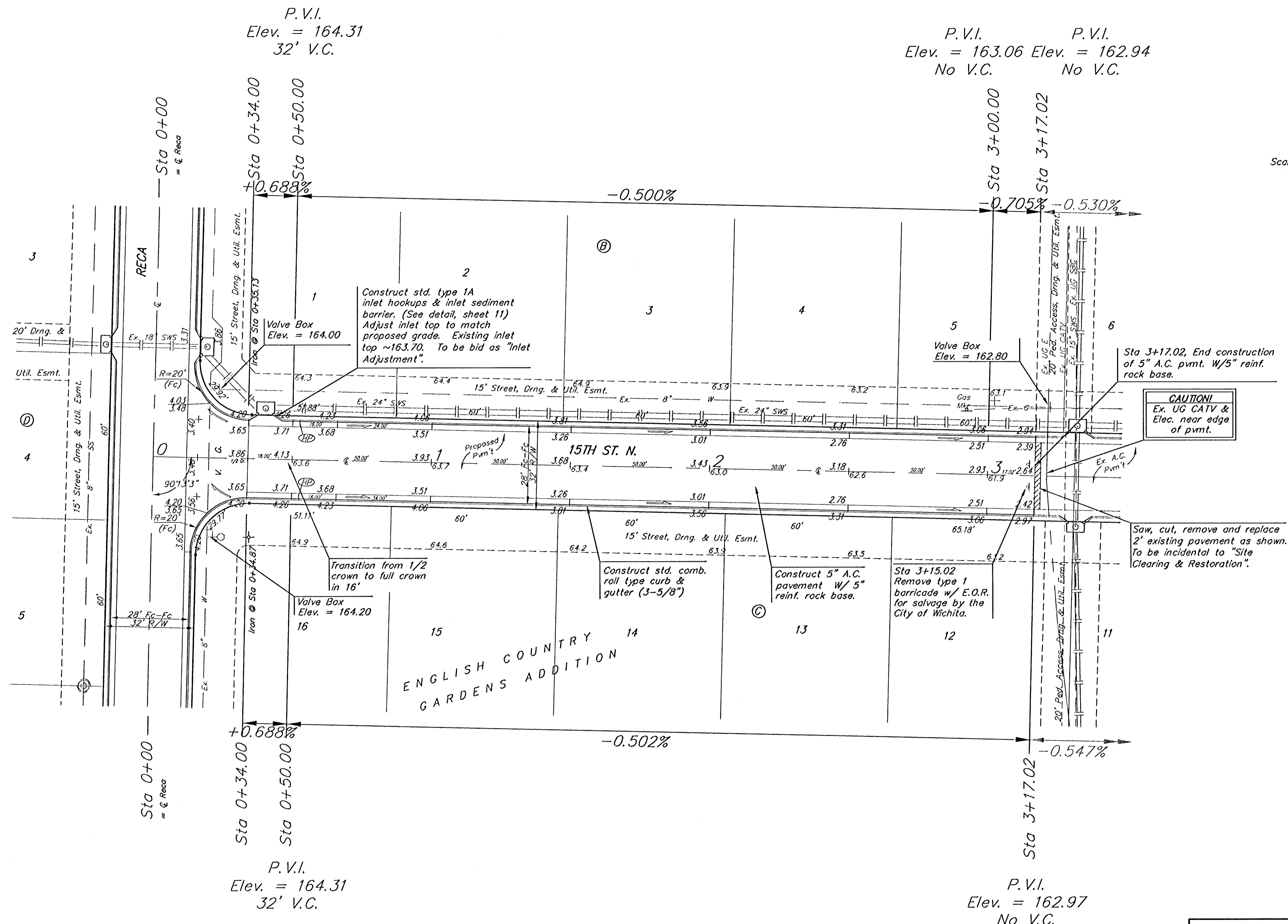

P.V.I.
Elev. = 164.31
32' V.C.

P.V.I. Elev. = 163.06 No V.C.
P.V.I. Elev. = 162.94 No V.C.

P.V.I.
Elev. = 164.31
32' V.C.

P.V.I.
Elev. = 162.97
No V.C.

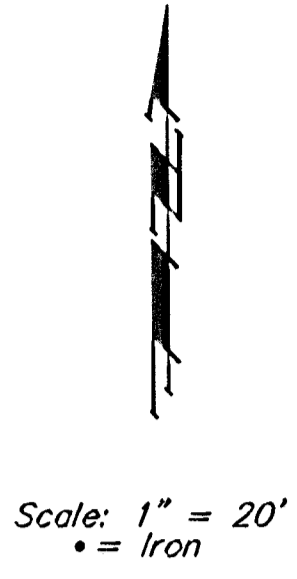

CAUTION!
Ex. UG CATV & Elec. near edge of pvmt.

Saw, cut, remove and replace 2" existing pavement as shown. To be incidental to "Site Clearing & Restoration".

NOTE: ROLL TYPE CURB & GUTTER TO BE CONSTRUCTED ON THE PAVEMENT SHOWN ON THIS SHEET. TOP OF CURB ELEVATIONS ARE GIVEN FOR FULL HEIGHT CURB.

		ENGLISH COUNTRY GARDENS ADD. - PH. II 15TH ST. N. STA 0+00 TO STA 3+17.02	
<small>Baughman Company, P.A. 115 Elm St. Wichita, KS 67211 P 316-262-7271 F 316-262-0149 ENGINEERING SURVEYING PLANNING LANDSCAPE ARCHITECTURE</small>			
PROJECT NUMBER 472-83936	DESIGN AEG	DRAWN TMS	
REVISIONS:	APPROVED	DATE 07/05	
	SCALE Noted	SHEET	
			7 OF 17
<small>EnglishCountryGardens\PhaseII\Str3</small>		<small>05-06-E273</small>	