

BENCHMARK:
 BM #1: "□" Cut in middle of
 N headwall of RCBC on 21st
 St. North. 1004.3' W & 22.1'
 N of SE Cor., SE 1/4, Sec. 2,
 T-27-S, R-2-E.
 Elev. = 173.23 City Datum

BM #2: "□" Cut at the SE
 corner of the intersection of
 Castle Rock & Castle Rock Ct.,
 Krug North Addition.
 Elev. = 183.50 City Datum

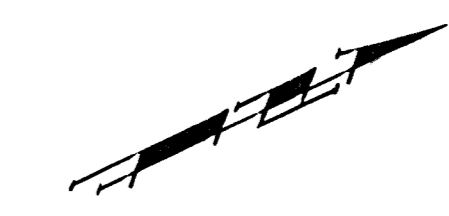

Scale: 1" = 20'
 = Iron

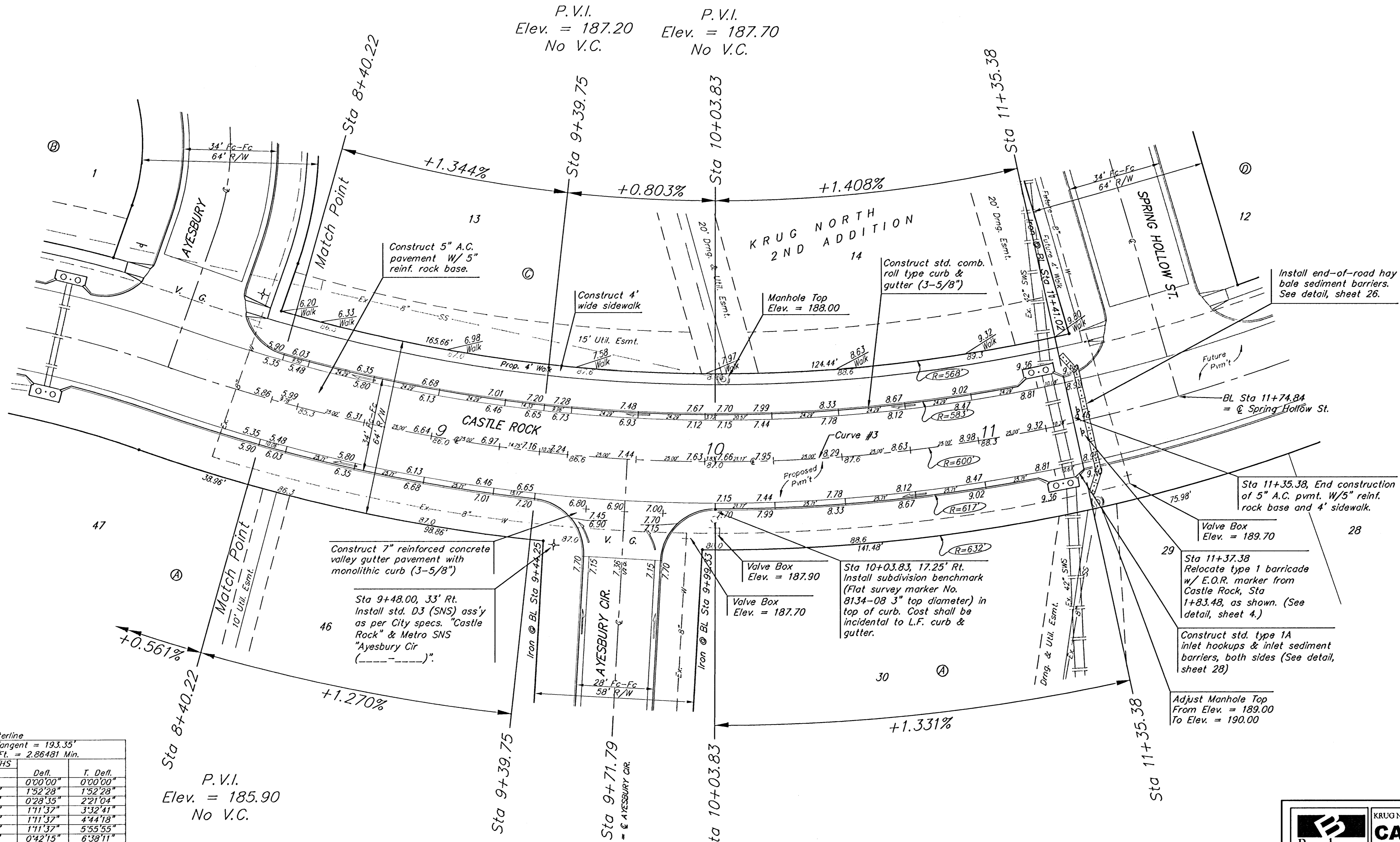

Curve #3
 Curve Data Based on Centerline
 Rad. = 600' Delta = 35° 43' 20" Tangent = 193.35'
 Arc = 374.08' L.C. = 368.05' Def/Ft. = 2.86481 Min.

Station	Arc	FACE CHORD LENGTHS		Def.	T. Def.
		8' Lt.	8' Rt.		
8+00.76	-	-	-	0'00.00"	0'00.00"
8+40.02	39.26'	37.62'	40.89'	1'52.28"	1'52.28"
8+50.00	9.98'	9.56'	10.40'	0'28.35"	2'21.04"
8+75.00	25.00'	23.96'	26.04'	1'11.37"	3'32.41"
9+00.00	25.00'	23.96'	26.04'	1'11.37"	4'44.18"
9+25.00	25.00'	23.96'	26.04'	1'11.37"	5'55.55"
9+39.75	14.75'	14.14'	15.36'	0'42.15"	6'38.11"
9+71.79	32.04'	30.70'	33.37'	1'31.47"	8'09.58"
10+03.83	32.04'	30.70'	33.37'	1'31.47"	9'41.45"
10+25.00	21.17'	20.29'	22.05'	1'00.39"	10'42.24"
10+50.00	25.00'	23.96'	26.04'	1'11.37"	11'54.01"
10+75.00	25.00'	23.96'	26.04'	1'11.37"	13'05.38"
11+00.00	25.00'	23.96'	26.04'	1'11.37"	14'17.16"
11+25.00	25.00'	23.96'	26.04'	1'11.37"	15'28.53"
11+35.38	10.38'	9.95'	10.81'	0'29.44"	15'38.37"
11+74.84	39.46'	37.81'	41.10'	1'53.03"	17'51.40"

P.V.I.
 Elev. = 185.90
 No V.C.

NOTE:
 ROLL TYPE CURB & GUTTER TO
 BE CONSTRUCTED ON THE
 PAVEMENT SHOWN ON THIS SHEET.
 TOP OF CURB ELEVATIONS ARE
 GIVEN FOR FULL HEIGHT CURB.

Baughman **CASTLE ROCK**
 KRUG NORTH 2ND/KRUG NORTH ADD. - P.H. II
 STA 8+40.22 TO STA 11+35.38

Baughman Company, P.A. 315 Ellis St. Wichita, KS 67211 P 316-262-7171 F 316-262-0149
 ENGINEERING | SURVEYING | PLANNING | LANDSCAPE ARCHITECTURE

PROJECT NUMBER 472-83974	DESIGN TMS
REVISIONS	APPROVED DATE 09/05
	SCALE Noted SHEET

8 OF 44

KrugNorth2nd\Phase1\Sta3 0504E231