

BENCHMARK:  
 BM #1: "□" Cut in middle of N headwall of RCBC on 21st St. North. 1004.3' W & 22.1' N of SE Cor., SE1/4, Sec. 2, T-27-S, R-2-E. Elev. = 173.23 City Datum

BM #2: "□" Cut at the SE corner of the intersection of Castle Rock & Castle Rock Ct., Krug North Addition. Elev. = 183.50 City Datum

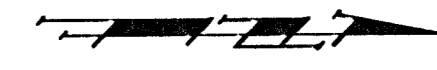

Scale: 1" = 20'  
 • = Iron

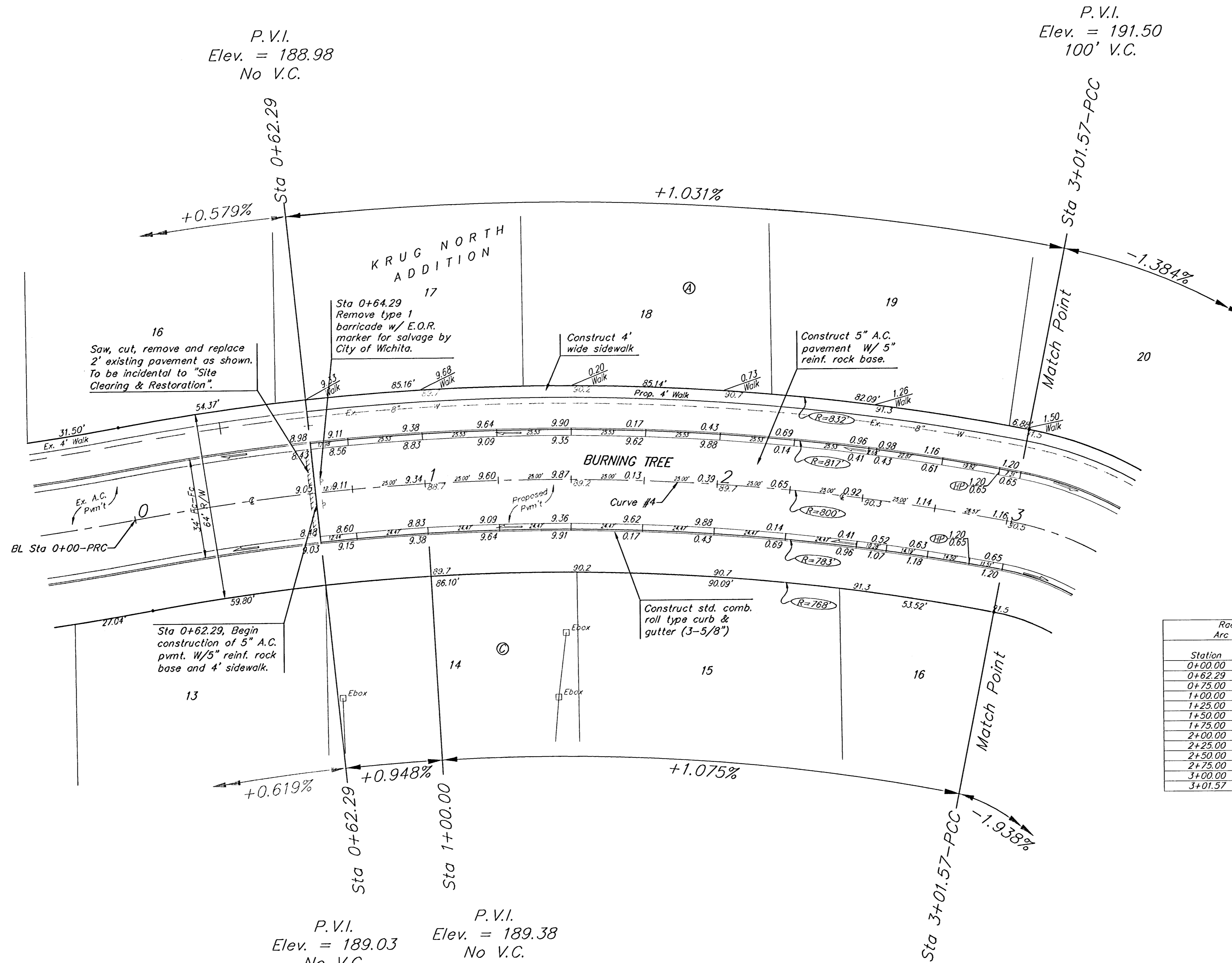

P.V.I.  
 Elev. = 188.98  
 No V.C.

P.V.I.  
 Elev. = 191.50  
 100' V.C.

P.V.I.  
 Elev. = 189.03  
 No V.C.

P.V.I.  
 Elev. = 189.38  
 No V.C.

P.V.I.  
 Elev. = 191.50  
 80.40' V.C.

Curve #4  
 Curve Data Based on Centerline  
 Rad. = 800' Delta = 21° 35' 53" Tangent = 152.59'  
 Arc = 301.57' L.C. = 299.78' Def./Fl. = 2.14856 Min.

Station	Arc	FACE CHORD LENGTHS		Defn.	T. Defn.
		8' Lt.	8' Rt.		
0+00.00	-	-	-	0'00'00"	0'00'00"
0+62.29	62.29'	64.22'	60.33'	2'13'50"	2'13'50"
0+75.00	12.71'	13.11'	12.31'	0'27'18"	2'41'08"
1+00.00	25.00'	25.78'	24.22'	0'53'43"	3'34'51"
1+25.00	25.00'	25.78'	24.22'	0'53'43"	4'28'34"
1+50.00	25.00'	25.78'	24.22'	0'53'43"	5'22'17"
1+75.00	25.00'	25.78'	24.22'	0'53'43"	6'15'60"
2+00.00	25.00'	25.78'	24.22'	0'53'43"	7'09'43"
2+25.00	25.00'	25.78'	24.22'	0'53'43"	8'03'25"
2+50.00	25.00'	25.78'	24.22'	0'53'43"	8'57'08"
2+75.00	25.00'	25.78'	24.22'	0'53'43"	9'50'51"
3+00.00	25.00'	25.78'	24.22'	0'53'43"	10'44'34"
3+01.57	1.57'	1.62'	1.52'	0'03'22"	10'47'56"

NOTE: ROLL TYPE CURB & GUTTER TO BE CONSTRUCTED ON THE PAVEMENT SHOWN ON THIS SHEET. TOP OF CURB ELEVATIONS ARE GIVEN FOR FULL HEIGHT CURB.

**Baughman** KRUG NORTH 2ND/KRUG NORTH ADD. - PH. II  
**BURNING TREE**  
 STA 0+62.29 TO STA 3+01.57

Baughman Company, P.A. 315 Ellis St. Wichita, KS 67211 P.316.262.7171 F.316.262.0149  
 ENGINEERING | SURVEYING | PLANNING | LANDSCAPE ARCHITECTURE

PROJECT NUMBER: 472-83974  
 DRAWN: TMS  
 REVISIONS:  
 APPROVED: DATE 09/05  
 SCALE: Noted  
 SHEET: 9 OF 44

KrugNorth2nd\Phase1\Sta4 05-04-E231