

BENCHMARK:  
 BM #1: "□" Cut in middle of  
 N headwall of RCBC on 21st  
 St. North. 1004.3' W & 22.1'  
 N of SE Cor., SE 1/4, Sec. 2,  
 T-27-S, R-2-E.  
 Elev. = 173.23 City Datum

BM #2: "□" Cut at the SE  
 corner of the intersection of  
 Castle Rock & Castle Rock Ct.,  
 Krug North Addition.  
 Elev. = 183.50 City Datum

Curve #5  
 Curve Data Based on Centerline  
 Rad. = 100' Delta = 88° 27' 28" Tangent = 97.34'  
 Arc = 154.39' L.C. = 139.51' Def/Ft. = 17.18851 Min.

Station	Arc	FACE CHORD LENGTHS		Defl.	T. Defl.
		8' Lt.	8' Rt.		
3+01.57	-	-	-	0'00"00"	0'00"00"
3+25.00	23.43'	29.22'	17.53'	6'42"43"	6'42"43"
3+50.00	25.00'	31.17'	18.70'	7'09"43"	13'52"26"
3+75.00	25.00'	31.17'	18.70'	7'09"43"	21'02"09"
4+00.00	25.00'	31.17'	18.70'	7'09"43"	28'11"52"
4+25.00	25.00'	31.17'	18.70'	7'09"43"	35'21"34"
4+50.00	25.00'	31.17'	18.70'	7'09"43"	42'31"17"
4+55.96	5.96'	7.45'	4.47'	1'42"26"	44'13"44"

P.V.I.  
 Elev. = 189.00  
 No V.C.

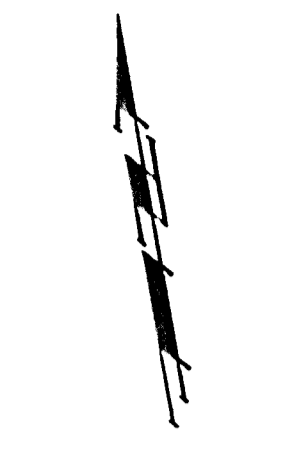

Scale: 1" = 20'  
 • = Iron

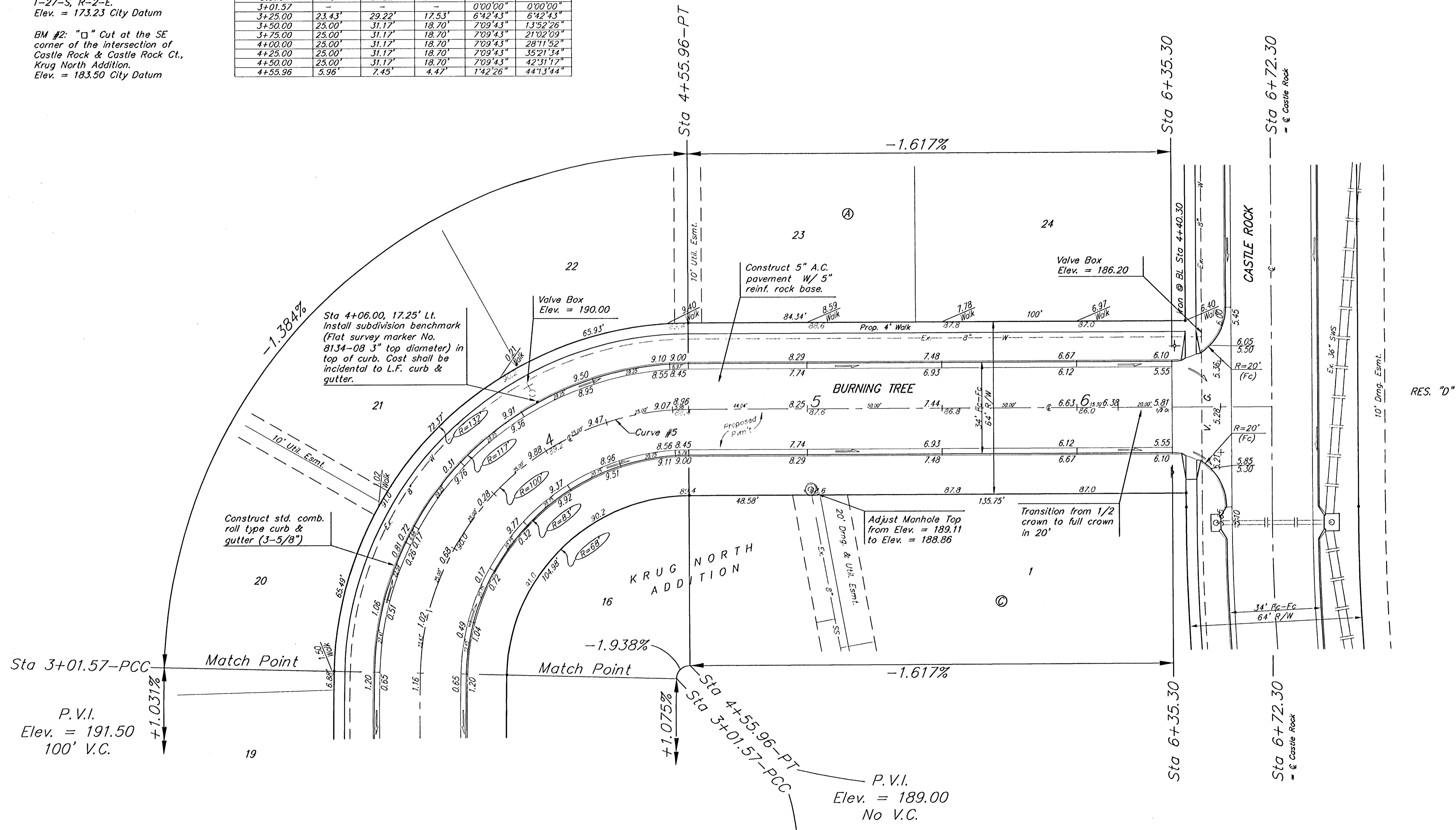

Sta 3+01.57-PCC  
 P.V.I.  
 Elev. = 191.50  
 100' V.C.  
 +1.031%

Sta 4+55.96-PT  
 P.V.I.  
 Elev. = 189.00  
 No V.C.  
 +1.075%

P.V.I.  
 Elev. = 191.50  
 80.40' V.C.

NOTE: ROLL TYPE CURB & GUTTER TO BE CONSTRUCTED ON THE PAVEMENT SHOWN ON THIS SHEET. TOP OF CURB ELEVATIONS ARE GIVEN FOR FULL HEIGHT CURB.

		KRUG NORTH 2ND/KRUG NORTH ADD. - PH. II <b>BURNING TREE</b> STA 3+01.57 TO STA 6+72.30	
		<small>Baughman Company, P.A. 315 E. 11th St., Wichita, KS 67211 P 316.262.7771 F 316.262.0149          ENGINEERING   SURVEYING   PLANNING   LANDSCAPE ARCHITECTURE</small>	
PROJECT NUMBER 47283974	DESIGN TMS	APPROVED DATE 09/05	SCALE Noted
REVISIONS:	SHEET <b>10 OF 44</b>	<small>KrugNorth2nd\Phase1\Sr5 05-04-E231</small>	