

BENCHMARK:
 BM #1: "□" Cut in middle of
 N headwall of RCBG on 21st
 St. North, 1004.3' W & 22.1'
 N of SE Cor., SE1/4, Sec. 2,
 T-27-S, R-2-E.
 Elev. = 173.23 City Datum

BM #2: "□" Cut at the SE
 corner of the intersection of
 Castle Rock & Castle Rock Ct.,
 Krug North Addition.
 Elev. = 183.50 City Datum

P.V.I.
 Elev. = 191.00
 No V.C.

P.V.I.
 Elev. = 190.40
 No V.C.

P.V.I.
 Elev. = 189.30
 No V.C.

Scale: 1" = 20'
 * = Iron

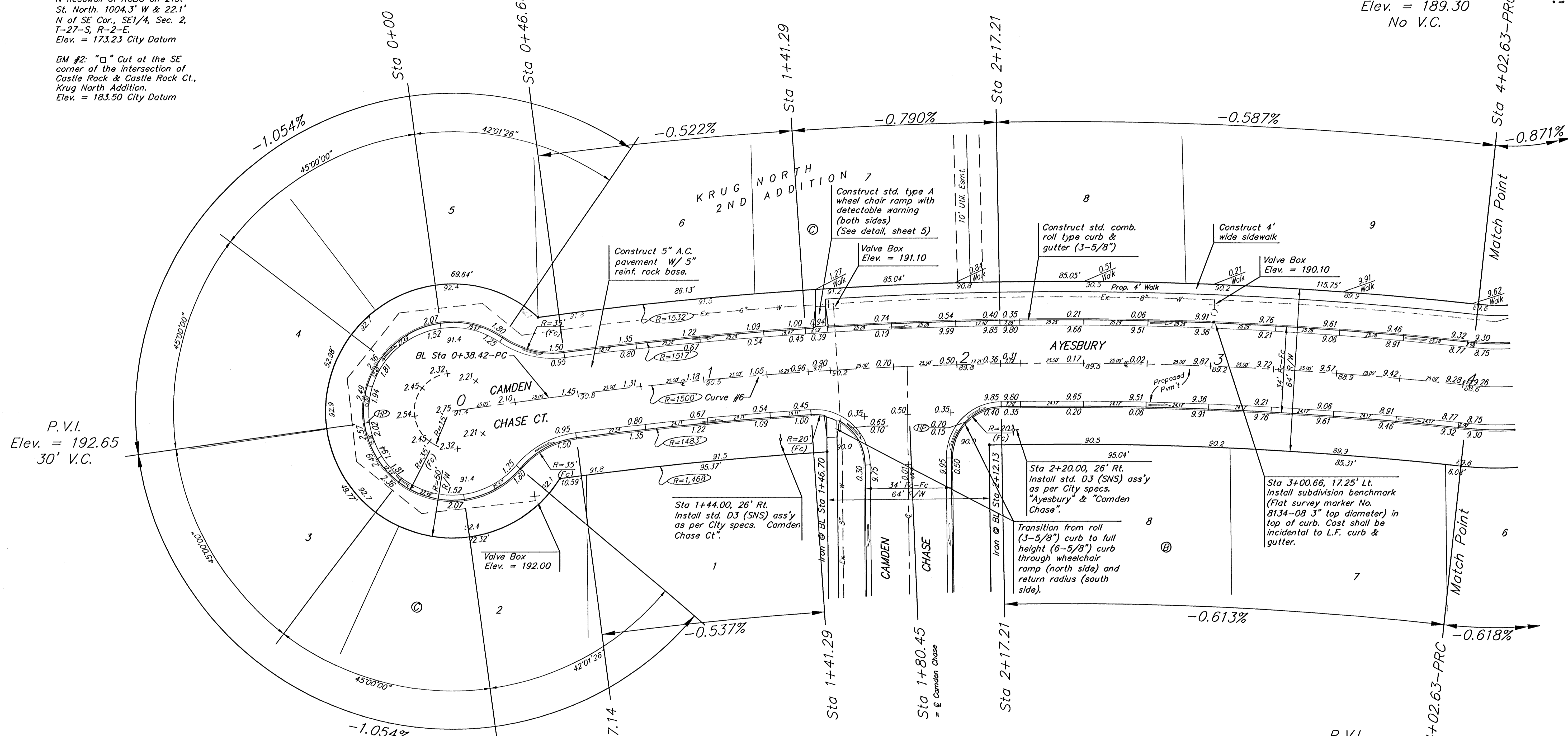

P.V.I.
 Elev. = 192.65
 30' V.C.

Curve #6
 Curve Data Based on Centerline
 Rad. = 1500' Delta = 13° 38' 41" Tangent = 179.46'
 Arc = 357.22' L.C. = 356.37' Del./Ft. = 1.14591 Min.

Station	FACE CHORD LENGTHS		Defl.	T. Defl.
	B' Lt.	B' Rt.		
0+45.41	-	-	0°00'00"	0°00'00"
0+45.92	0.51'	0.52'	0°00'35"	0°00'35"
0+47.73	1.81'	1.84'	0°02'04"	0°02'39"
0+50.00	2.27'	2.31'	0°02'36"	0°03'15"
0+75.00	25.00'	25.42'	0°28'39"	0°33'54"
1+00.00	25.00'	25.42'	0°28'39"	1°02'33"
1+25.00	25.00'	25.42'	0°28'39"	1°31'12"
1+41.29	16.29'	16.56'	0°18'40"	1°49'52"
1+80.45	39.16'	39.81'	0°44'52"	2°34'44"
2+17.21	36.76'	37.32'	0°42'07"	3°16'52"
2+25.00	7.79'	7.92'	0°08'55"	3°25'47"
2+50.00	25.00'	25.42'	0°28'39"	3°54'26"
2+75.00	25.00'	25.42'	0°28'39"	4°23'05"
3+00.00	25.00'	25.42'	0°28'39"	4°51'44"
3+25.00	25.00'	25.42'	0°28'39"	5°20'23"
3+50.00	25.00'	25.42'	0°28'39"	5°49'02"
3+75.00	25.00'	25.42'	0°28'39"	6°17'41"
4+00.00	25.00'	25.42'	0°28'39"	6°46'19"
4+02.63	2.63'	2.67'	0°03'01"	6°49'20"

NOTE: ROLL TYPE CURB & GUTTER TO BE CONSTRUCTED ON THE PAVEMENT SHOWN ON THIS SHEET. TOP OF CURB ELEVATIONS ARE GIVEN FOR FULL HEIGHT CURB.

Baughman
 Baughman Company, P.A. 315 Ella St. Wichita, KS 67111 F 316-262-7111 F 316-262-0149
 ENGINEERING | SURVEYING | PLANNING | LANDSCAPE ARCHITECTURE

PROJECT NUMBER: 472-83974
 REVISIONS:

DESIGN: TMS
 DRAWN: TMS
 APPROVED: DATE 09/05
 SCALE: Noted
 SHEET: 11 OF 44

KRUG NORTH 2ND/KRUG NORTH ADD. - PH. II
AYESBURY & CAMDEN CHASE CT.
 STA 0+00 TO STA 4+02.63

KrugNorth2nd\Phase\Str6 0504E231