

BENCHMARK:
 BM #1: "□" Cut in middle of
 N headwall of RCBC on 21st
 St. North. 1004.3' W & 22.1'
 N of SE Cor., SE1/4, Sec. 2,
 T-27-S, R-2-E.
 Elev. = 173.23 City Datum

BM #2: "□" Cut at the SE
 corner of the intersection of
 Castle Rock & Castle Rock Ct.,
 Krug North Addition.
 Elev. = 183.50 City Datum

Scale: 1" = 60'

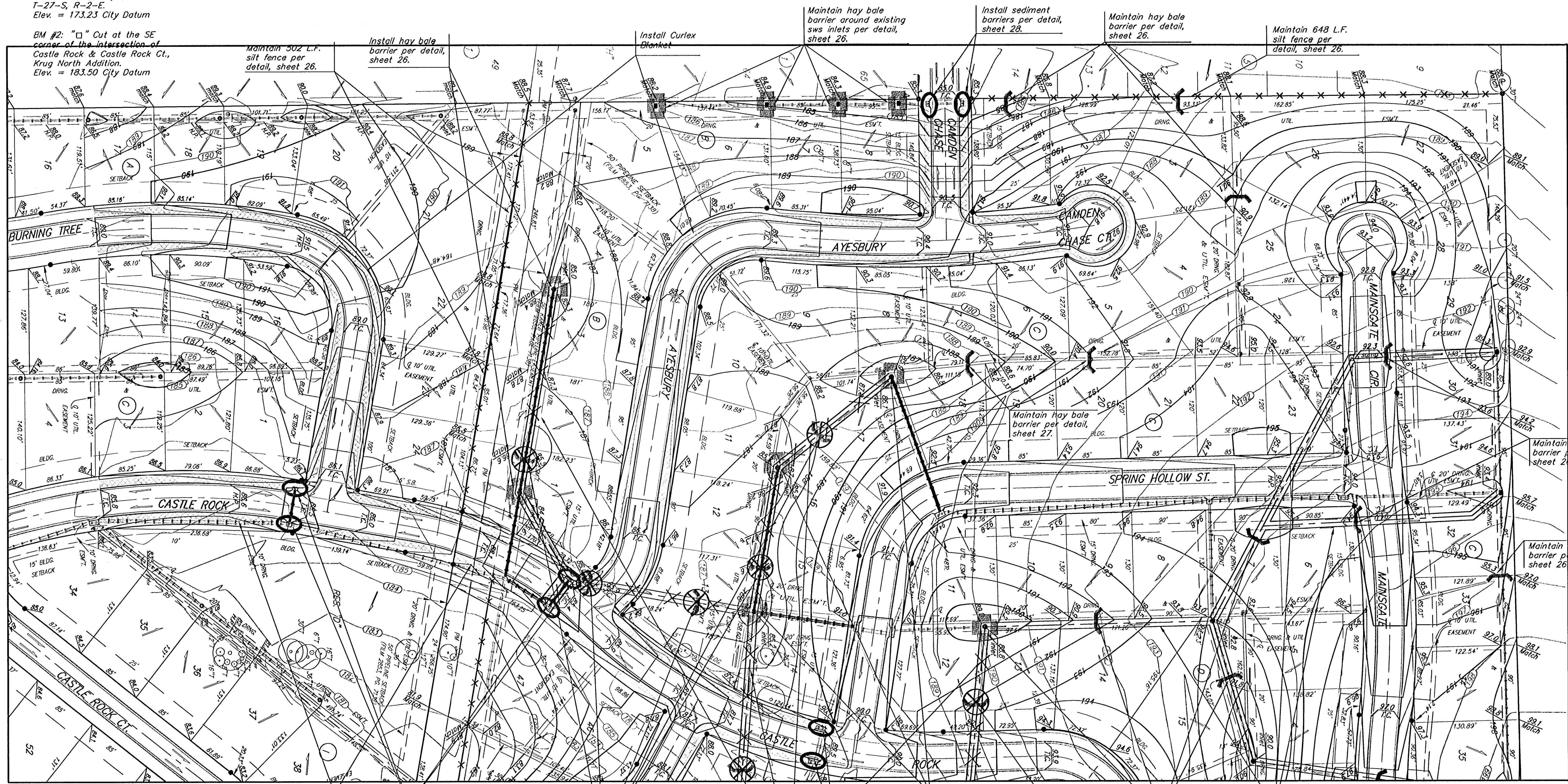

Maintain 502 L.F. silt fence per detail, sheet 26.

Install hay bale barrier per detail, sheet 26.

Install Curlex Blanket

Maintain hay bale barrier around existing sws inlets per detail, sheet 26.

Install sediment barriers per detail, sheet 28.

Maintain hay bale barrier per detail, sheet 26.

Maintain 648 L.F. silt fence per detail, sheet 26.

Maintain hay bale barrier per detail, sheet 27.

Maintain hay bale barrier per detail, sheet 26.

Maintain hay bale barrier per detail, sheet 26.

Install Curlex Blanket

Install sediment barriers per detail, sheet 28.

Remove existing hay bale barrier.

Install hay bale barrier per detail, sheet 26.

Remove existing hay bale barrier.

Maintain hay bale barrier per detail, sheet 26.

Maintain ditch to ensure positive drainage of sump areas.

Install sediment barriers per detail, sheet 28.

Fill & Grade existing temp. ditch to match plan elevations.

- Existing Grade
- Proposed Grade
- Silt Fence
- CURLEX BLANKET
- CURB INLET PROTECTION

All easements have been graded prior to construction with the mass grading plan, however, all easements shall be fine graded with this project after street & sws construction has been completed. All cost associated with the fine grading shall be included in the lump sum bid item "Easement Grading".

All cost associated with the filling and grading of the temporary ditches shall be included in the lump sum bid item "Easement Grading".

	ESMT. GRADING PLAN & EROSION CONTROL PLAN WICHITA, KANSAS	
	KRUG NORTH 2ND/KRUG NORTH ADD. - PH. II	
Baughman Company, P.A. 315 Hills St., Wichita, KS 67211 F 316-262-1211 F 316-262-1419 ENGINEERING SURVEYING PLANNING LANDSCAPE ARCHITECTURE	PROJECT NUMBER 472-83974	DESIGN TMS
REVISIONS:	APPROVED DATE 09/05	DRAWN TMS
		SCALE Noted
		30 OF 44
KrugNorth2nd/PhaseI/Sw/EC/plan1		05-04-E231