

REMOVE ALL TREES AND VEGETATION FROM THE 20' UTILITY EASEMENT AND FROM THE ADJACENT LOTS WHERE TREES EXIST. SUBSIDIARY TO THE BID ITEM "SITE CLEARING L.S."

EXISTING STOCKPILE TO BE RELOCATED AND USED FOR SITE GRADING.

TREES ALONG PROPERTY LINE TO REMAIN AND ONLY BE TRIMMED AS NECESSARY FOR CONSTRUCTION

TREE LIMBS SHALL BE TRIMMED 10' CLEAR VERTICALLY ABOVE ANY REGRADED AREAS.

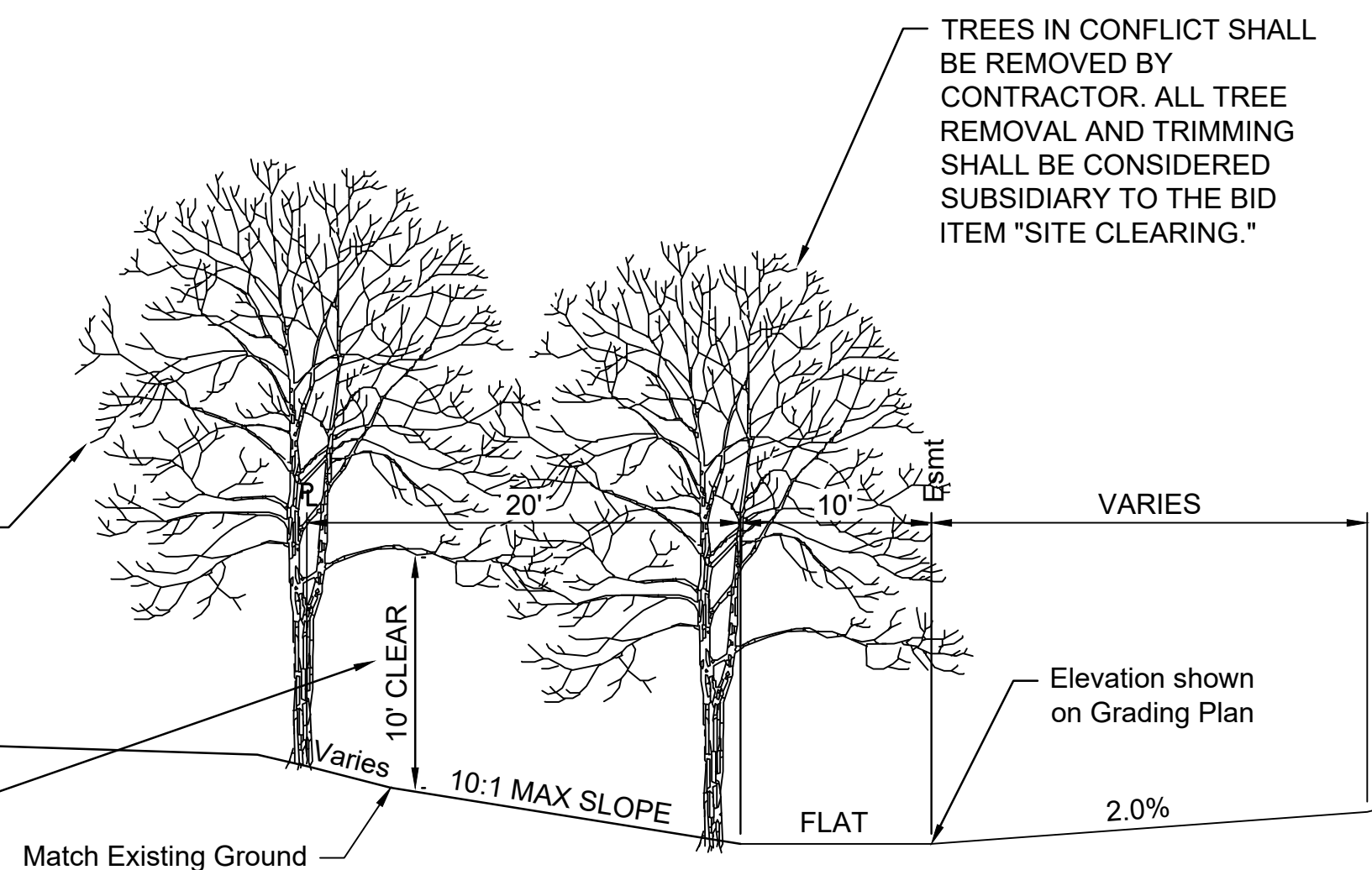

NOTES:
TOPSOIL ON THE SITE SHALL BE STRIPPED AND STOCKPILED AT AN ON-SITE LOCATION COORDINATED WITH THE FIELD ENGINEER. FOLLOWING GRADING OPERATIONS, A MINIMUM OF 4" OF TOPSOIL SHALL BE PLACED IN ALL EASEMENT AND RESERVE AREAS OF THE SITE. REMAINING TOPSOIL SHALL REMAIN IN THE STOCKPILE FOR PLACEMENT IN LOTS AND STREET AREAS BY OTHERS AT A FUTURE DATE.

COST OF TOPSOIL STRIPPING AND PLACEMENT IS INCIDENTAL TO THE BID ITEM FOR "EXCAVATION". ALL OTHER EXCESS EXCAVATION FROM CONSTRUCTION ACTIVITIES SHALL REMAIN ON-SITE IN A STOCKPILE COORDINATED WITH THE FIELD ENGINEER.

BRUSH GENERATED BY THE TRIMMING AND REMOVAL OF THE TREES MAY BE BURNED ON-SITE BUT THE LOCATION AND METHOD FOR BURNING WILL BE SUBJECT TO THE APPROVAL OF THE CITY OF WICHITA AND SEDGWICK COUNTY. IT SHOULD BE ASSUMED THAT AN AIR CURTAIN SYSTEM WILL BE REQUIRED FOR ON-SITE BURNING.

STORM WATER DRAIN CONTRACTOR SHALL BURN ANY TREE PILES OR DEBRIS THAT REMAINS FROM THE SANITARY SEWER PROJECT. TREE TRIMMING AND BURNING/REMOVAL SHALL BE SUBSIDIARY TO THE BID ITEM FOR SITE CLEARING.

REMOVE EXISTING TEMP. AC PAVEMENT. SUBSIDIARY TO "SITE CLEARING"

NOTE: SEE SHEET 4 FOR SECTION DETAILS.

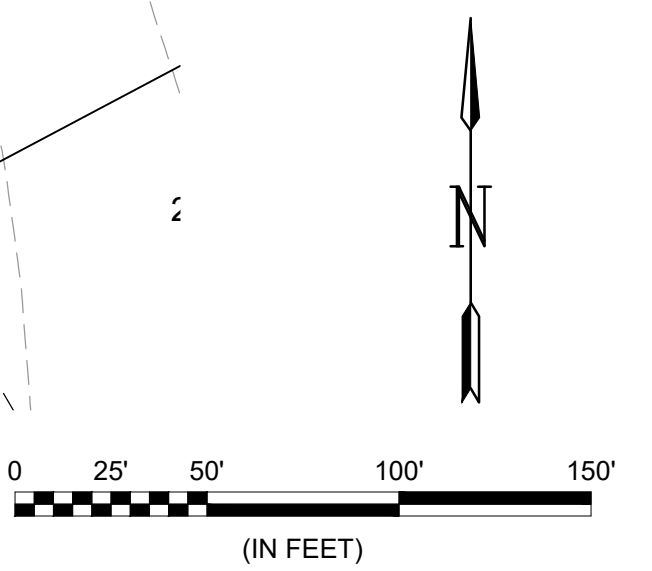

© 2021 GARVER, LLC
THIS DOCUMENT, ALONG WITH THE IDEAS AND DESIGNS CONVEYED HEREIN, SHALL BE CONSIDERED INSTRUMENTS OF PROFESSIONAL SERVICE AND ARE PROPERTY OF GARVER, LLC. ANY USE, REPRODUCTION, OR DISTRIBUTION OF THIS DOCUMENT, ALONG WITH THE IDEAS AND DESIGN CONTAINED HEREIN, IS PROHIBITED UNLESS AUTHORIZED IN WRITING BY GARVER, LLC OR EXPLICITLY ALLOWED IN THE GOVERNING PROFESSIONAL SERVICES AGREEMENT FOR THIS WORK.

1995 Midfield Road
Wichita, KS 67209
(316) 264-8008

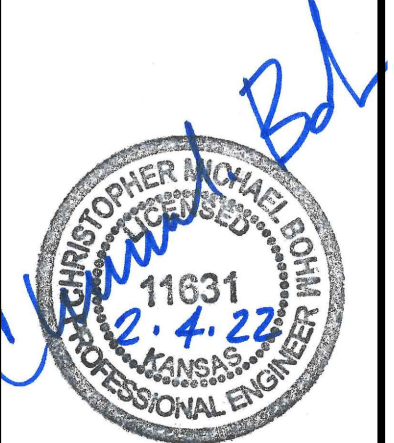

REV.	DATE	DESCRIPTION



CITY OF WICHITA
WICHITA, KANSAS
CLEAR RIDGE ADDITION
WICHITA, KANSAS
PHASE 2 - STORM WATER

GRADING PLAN NORTH

JOB NO.: 21T41002
DATE: FEB. 2022
DESIGNED BY: CMB
DRAWN BY: DRS

BAR IS ONE INCH ON ORIGINAL DRAWING
IF NOT ONE INCH ON THIS SHEET, ADJUST SCALES ACCORDINGLY.

DRAWING NUMBER

SHEET NUMBER **2 OF 37**

File: L:\2021\21T41002 - Clear Ridge Phase 2\Drawings\CADD\21T41002-GRADING PLANS.dwg Last Save: 2/3/2022 4:45 PM Last saved by: Dstrandrich Last plotted by: Standrich, Daryl R Plot Style: 1:2.5849 Plot Date: 2/7/2022 11:30 AM Plotter used: None