

# TYPICAL MASS GRADING DETAIL

## STREET R/W GRADING

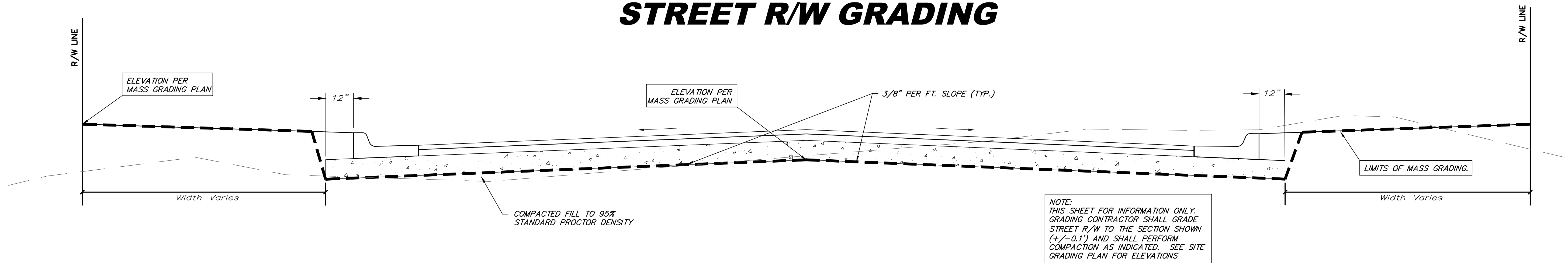

## LOT FILL GRADING

### INTERIOR PLATTED LOT SECTION

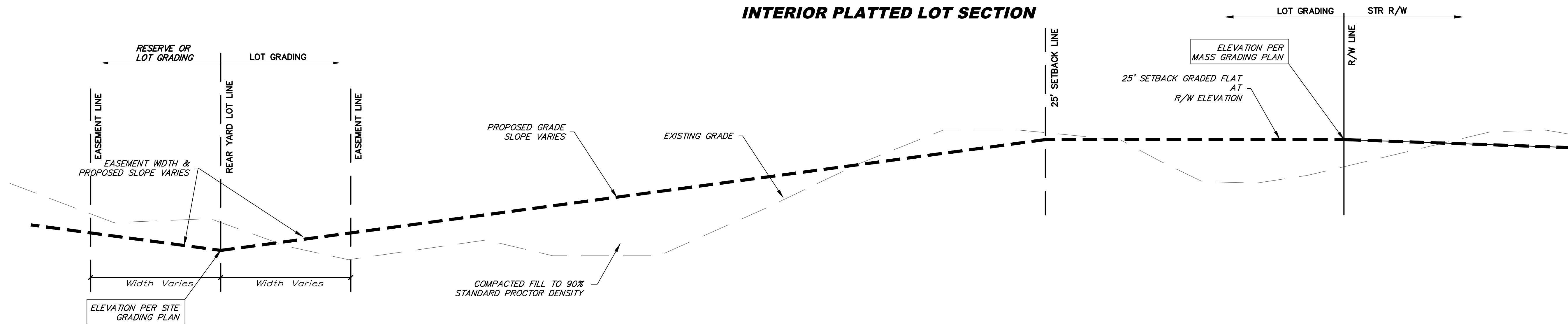

### EXTERIOR PLATTED LOT SECTION

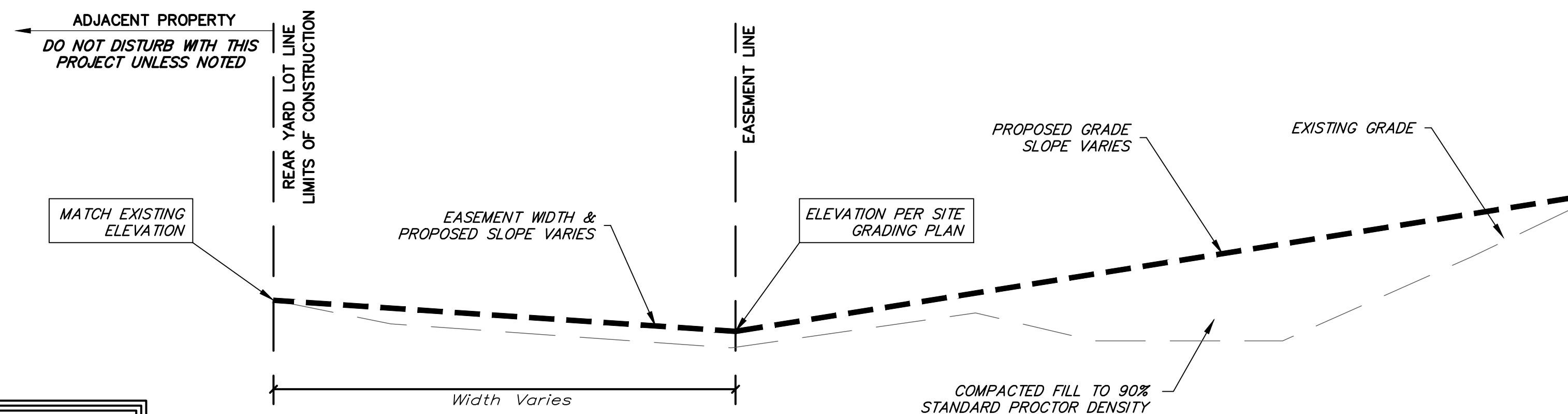

When trees are present along rear lot line, grade shall match at trunk line and trees shall not be disturbed. Any trimming of trees shall be approved by the engineer and owner.