

SAVED 4/8/2022 2:29:34 PM BY KURTIS DEKAT
 PLOTTED 9/13/2022 11:23:00 AM BY KURTIS DEKAT
 U:\WICHITA-CIVIL\2021\210253\000\MIDDRAWINGS\210253-000-CU102.DWG

- LEGEND**
- ✕ = DENOTES SANITARY SEWER LINE TO BE ABANDONED IN PLACE.
 - ✕ = SANITARY SEWER MANHOLE TO BE ABANDONED
 - ⌊ = DENOTES CAP/PLUG BY THE CONTRACTOR. (INCLUDES REMOVAL AND REPLACEMENT OF PAVEMENT)

PLAN: LAT. & LONG. 0 10' 20' 40'

PROFILE: HORIZ. SAME AS ABOVE

VERT: 0 5'

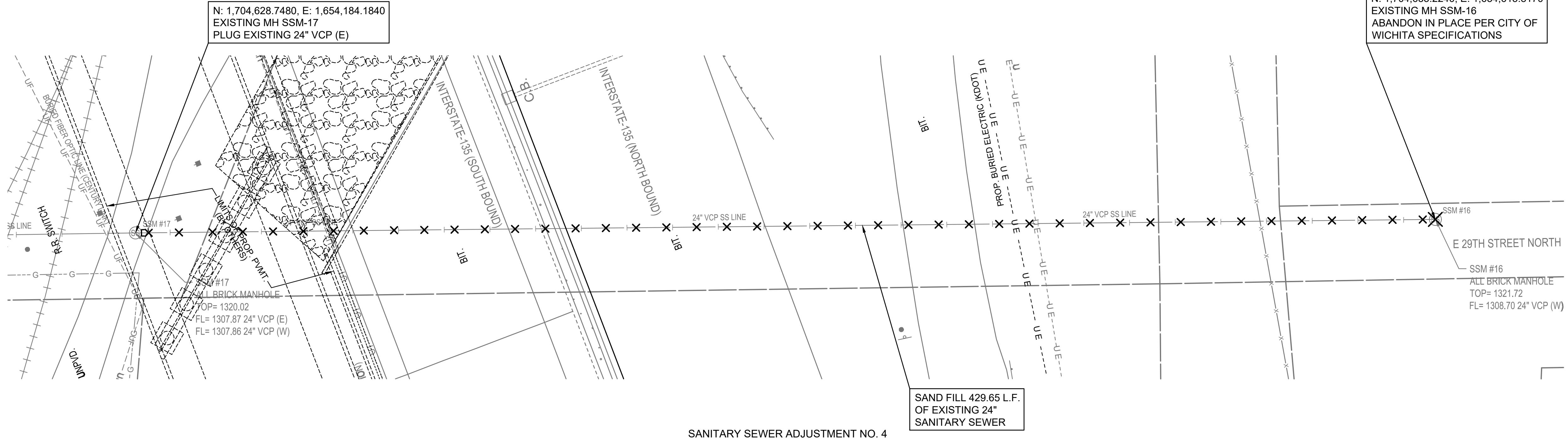
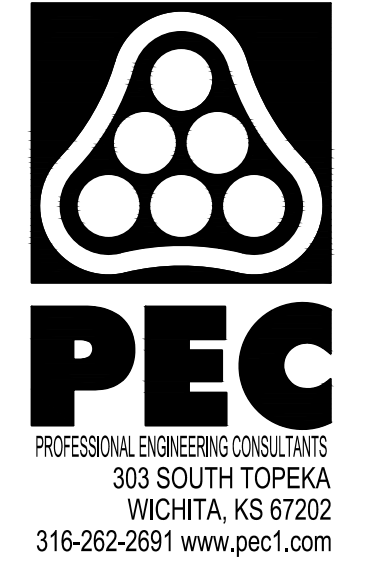

SANITARY SEWER AND WATERLINE IMPROVEMENTS

NORTH JUNCTION UTILITY RELOCATION

GARY JANZEN, P.E. - CITY ENGINEER
 SS: CITY OF WICHITA PROJ. NO. 468-2021-002929
 WL: CITY OF WICHITA PROJ. NO. 448-2021-034139

Issue:	
JOB NO.	35-210253-000-0042
DATE	01 JUNE 2021
PM	TBK
DESIGNED BY	TBK
DRAWN BY	KTD
CHECKED BY	RWG

SANITARY SEWER ADJUSTMENT NO. 4

CU102