

BENCHMARKS

BM- #1:
Square cut on top of South curb of 21st St. N.
334'± West and 32'± South of the intersection of
21st St. N. and Cleveland Ave.
Elev. = 1307.56(NAVD88)

BM- #2:
Square cut on top of South concrete pad of
monitoring well 26'± East and 51'± South of the
intersection of 21st St. N. and Cleveland Ave.
Elev. = 1308.70(NAVD88)

BM- #3:
C.O.W BM Disc on top of South concrete wall
918'± West and 147'± North of the intersection
of 21st St. N. and Cleveland Ave.
Elev. = 1312.58(NAVD88)

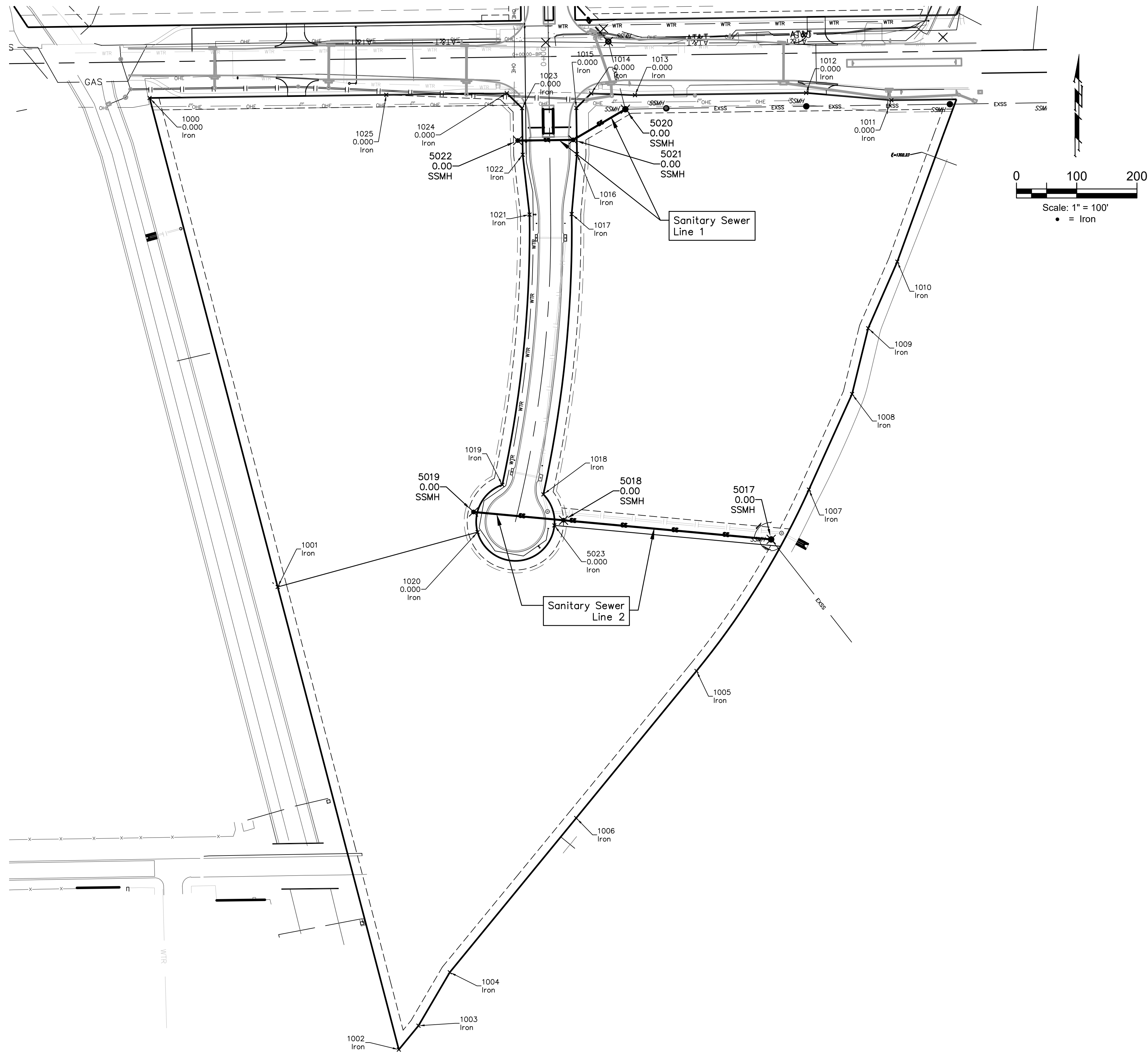

Point Table			
Point #	Northing	Easting	Description
1000	1,698,927.04	1,652,404.35	Iron
1001	1,698,115.52	1,652,616.93	Iron
1002	1,697,347.67	1,652,818.00	Iron
1003	1,697,387.30	1,652,850.56	Iron
1004	1,697,476.03	1,652,902.53	Iron
1005	1,697,976.02	1,653,311.96	Iron
1006	1,697,731.97	1,653,112.28	Iron
1007	1,698,277.09	1,653,498.56	Iron
1008	1,698,435.65	1,653,570.12	Iron
1009	1,698,544.87	1,653,596.86	Iron
1010	1,698,655.38	1,653,645.18	Iron
1011	1,698,923.31	1,653,635.38	Iron
1012	1,698,935.44	1,653,493.90	Iron
1013	1,698,931.68	1,653,209.93	Iron
1014	1,698,934.55	1,653,137.17	Iron
1015	1,698,910.54	1,653,112.52	Iron
1016	1,698,833.99	1,653,113.54	Iron
1017	1,698,734.36	1,653,104.85	Iron
1018	1,698,269.08	1,653,057.81	Iron
1019	1,698,284.90	1,652,989.62	Iron
1020	1,698,206.45	1,652,948.65	Iron
1021	1,698,733.44	1,653,034.86	Iron
1022	1,698,832.80	1,653,023.54	Iron
1023	1,698,910.21	1,653,022.52	Iron
1024	1,698,934.87	1,652,997.19	Iron
1025	1,698,932.23	1,652,797.11	Iron
5017	1,698,194.39	1,653,435.89	SSMH
5018	1,698,226.15	1,653,091.26	SSMH
5019	1,698,239.91	1,652,941.90	SSMH
5020	1,698,908.31	1,653,193.90	SSMH
5021	1,698,857.46	1,653,107.22	SSMH
5022	1,698,856.26	1,653,015.23	SSMH
5023	1,698,217.65	1,653,076.06	Iron

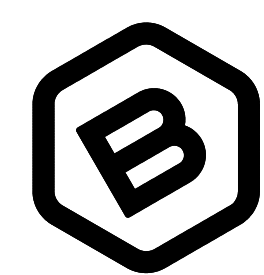
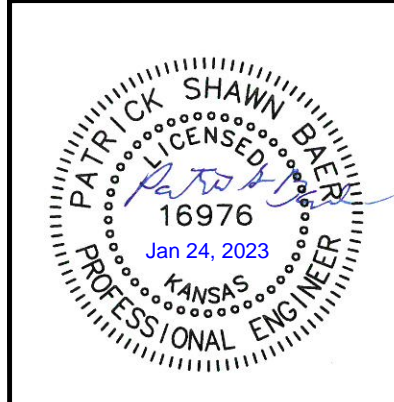

**BAUGHMAN
COMPANY**

315 Ellis St.
Wichita, KS 67211
316-262-7271
BaughmanCo.com

Cornejo Industrial District
2nd Addition
**Coordinate
Plan**

Sanitary Sewer
Improvements

PROJECT NUMBER:
468-2021-017263

DESIGN: PSB DRAWN: JA
DATE: January 23, 2023

SHEET OF
13 14

File: E:\Projects\Cornejo Industrial District_2nd (21-10-P717)\Engineering\Phase 1\SS\CID PPS 2nd Petition.dwg