

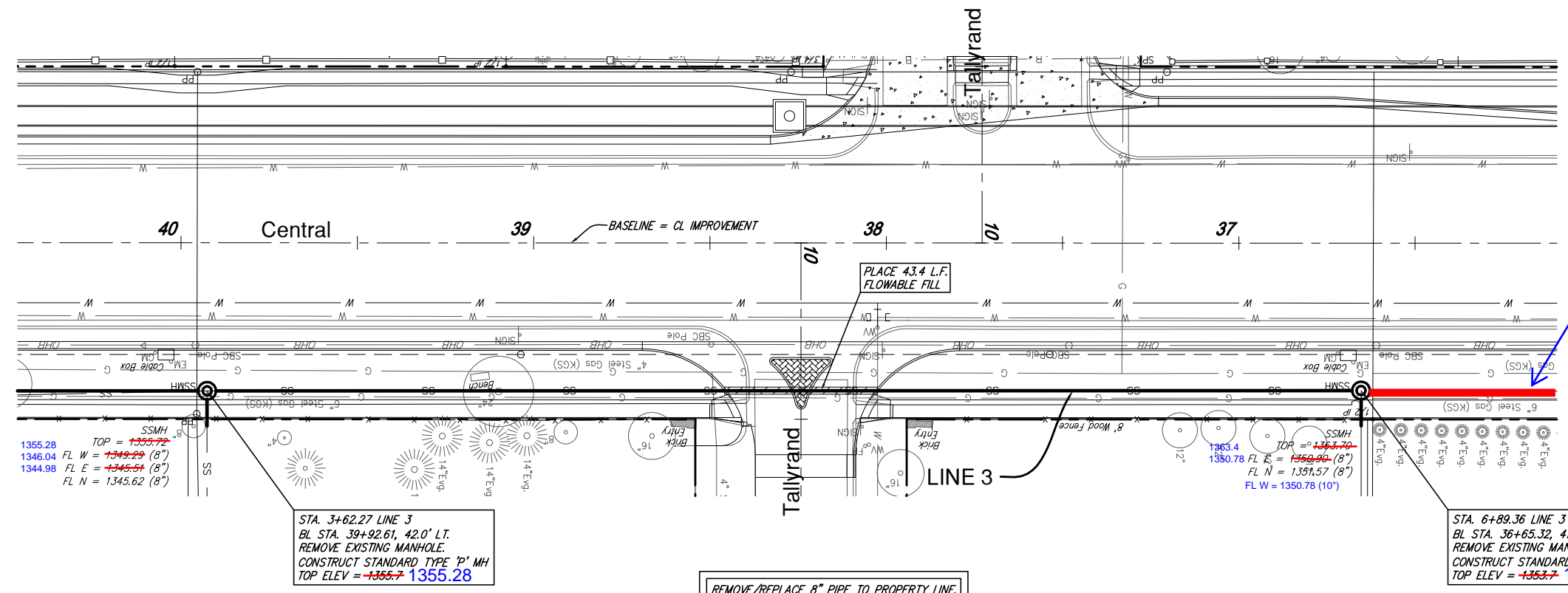

SCALE 1" = 20'



Note: App. 325 L.F. of 10" PVC added to original plan between MH #116 & MH #122.

SSMH  
 TOP = 1355.78  
 FL W = 1345.29 (8")  
 FL E = 1345.51 (8")  
 FL N = 1345.62 (8")

STA. 3+62.27 LINE 3  
 BL STA. 39+92.61, 42.0' LT.  
 REMOVE EXISTING MANHOLE.  
 CONSTRUCT STANDARD TYPE 'P' MH  
 TOP ELEV = ~~1355.7~~ 1355.28

REMOVE/REPLACE 8" PIPE TO PROPERTY LINE.  
 CONNECT TO EXISTING USING CASCADE  
 MODEL CSST OR APPROVED COUPLING.

SSMH  
 TOP = 1363.4  
 FL E = 1350.78 (8")  
 FL N = 1351.57 (8")  
 FL W = 1350.78 (10")

STA. 6+89.36 LINE 3  
 BL STA. 36+65.32, 41.8' LT.  
 REMOVE EXISTING MANHOLE.  
 CONSTRUCT STANDARD TYPE 'P' MH  
 TOP ELEV = ~~1363.7~~ 1363.4

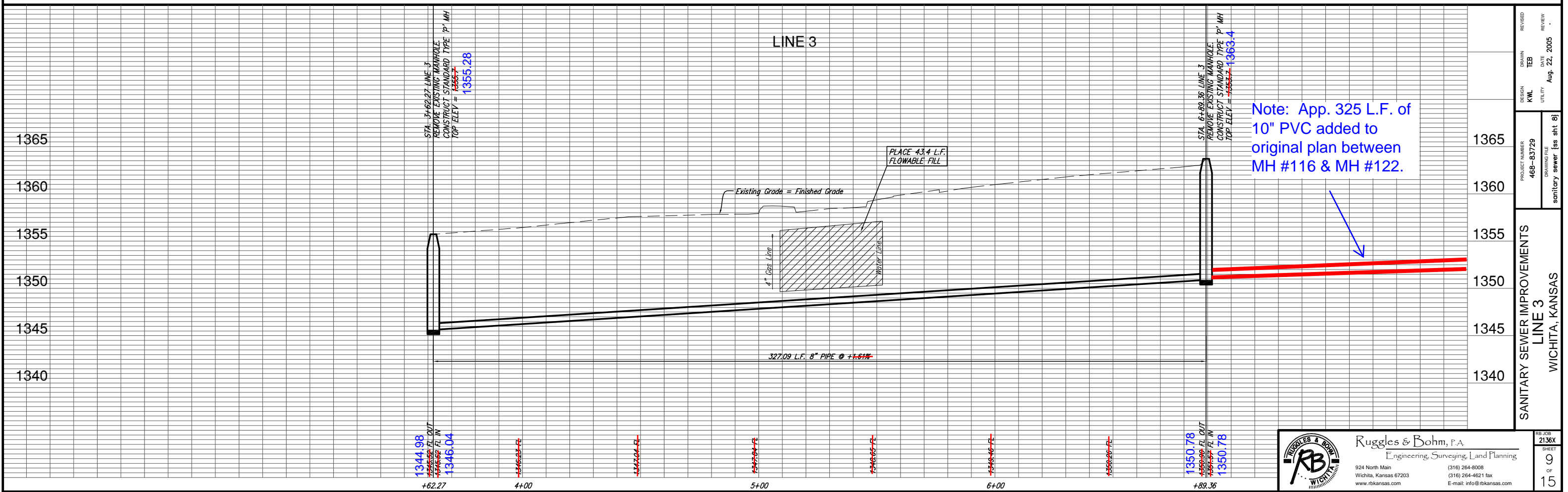

Note: App. 325 L.F. of 10" PVC added to original plan between MH #116 & MH #122.

STA. 3+62.27 LINE 3  
 REMOVE EXISTING MANHOLE.  
 CONSTRUCT STANDARD TYPE 'P' MH  
 TOP ELEV = ~~1355.7~~ 1355.28

STA. 6+89.36 LINE 3  
 REMOVE EXISTING MANHOLE.  
 CONSTRUCT STANDARD TYPE 'P' MH  
 TOP ELEV = ~~1363.7~~ 1363.4

1344.98  
 1346.04  
 1346.04

1350.78  
 1350.78  
 1350.78

DESIGN	TEB	DATE	Aug. 22, 2005
DRAWN	TEB	REVIEW	
PROJECT NUMBER	468-83729	UTILITY	sanitary sewer
DRAWING FILE	sanitary sewer_sss sht 8j		
SANITARY SEWER IMPROVEMENTS LINE 3 WICHITA, KANSAS			
REVISION	NO.	DATE	DESCRIPTION

**Ruggles & Bohm, P.A.**  
 Engineering, Surveying, Land Planning  
 924 North Main  
 Wichita, Kansas 67203  
 www.rbkansas.com  
 (316) 264-8008  
 (316) 264-4621 fax  
 E-mail: info@rbkansas.com