

LANDSCAPE PLANS FOR WEBB ROAD FROM PAWNEE AVENUE TO HARRY STREET

MAY 2002

PROJECT NO. 472-83093

WICHITA, SEDGWICK COUNTY, KANSAS
MICHAEL E. LINDEBAK, CITY ENGINEER

O.C.A. NO. 706783

INDEX OF SHEETS

SHEET NO.	DESCRIPTION
1	TITLE SHEET
2	TYPICAL SECTION
3-14	ROAD SIDE IMPROVEMENTS-LANDSCAPING

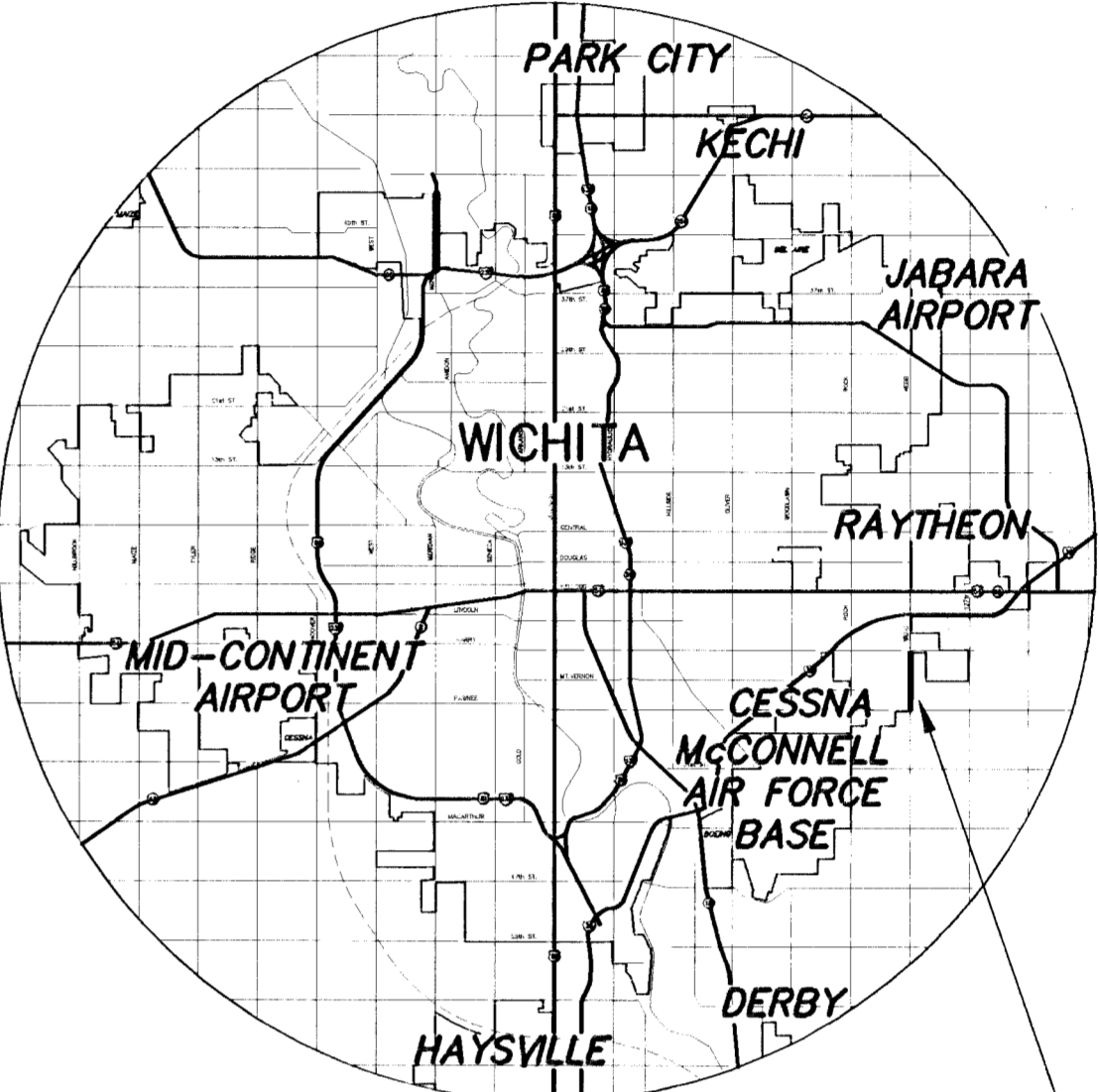

PROJECT LOCATION

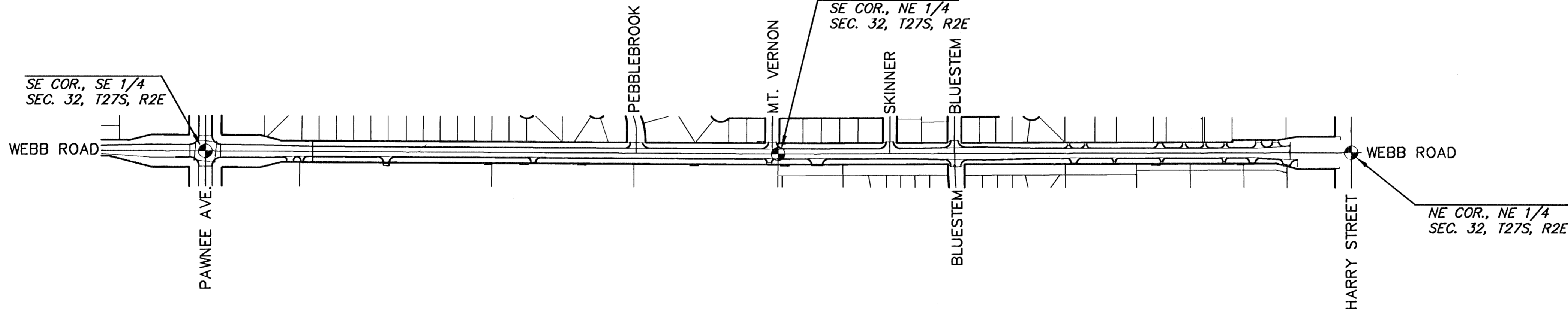

PREPARED & SUBMITTED BY
MKEC ENGINEERING CONSULTANTS, INC.
WICHITA, KANSAS



CONVENTIONAL SIGNS

COUNTY LINE	-----	CENTER LINE OF PROJECT	4+000 +100
CITY LIMITS	-----	TERRACE	-----
STATE OR NATIONAL LINE	-----	CULVERTS	-----
TOWNSHIP, SECTION or GRANT LINE	-----	DROP INLET & STORM SEWER	-----
PROPERTY LINE	-----	ACCESS CONTROL	-----
HIGHWAY FENCE	-----	POWER POLE	-----
EXISTING FENCE	-----	TELEPHONE POLE	-----
GUARD FENCE	-----	MARSH	-----
CONSTRUCTION LIMITS	-----	HEDGE	-----
RIGHT OF WAY LINE	-----	TREES	-----
TRAVELED WAY	-----	PROFILE ELEVATION	-----
RAILROADS	-----	STREAM or CREEK	-----

LANDSCAPE IMPROVEMENTS
WEBB ROAD
PROJECT NAME

TITLE SHEET
SHEET TITLE

DESIGN BY: JAG	DRAWN BY: NRP	CHECKED BY: JAG
DATE: APRIL 2002	JOB NO.: 98172	SHEET/OF: 1 / 14

411 N. WEBB ROAD
WICHITA, KS. 67206
316 - 684 - 9600