

FHWA REG. NO.	STATE	PROJECT NO.	YEAR	SHEET NO.	TOTAL SHEETS
7	KANSAS	STP-N012(601)	2001	5	14

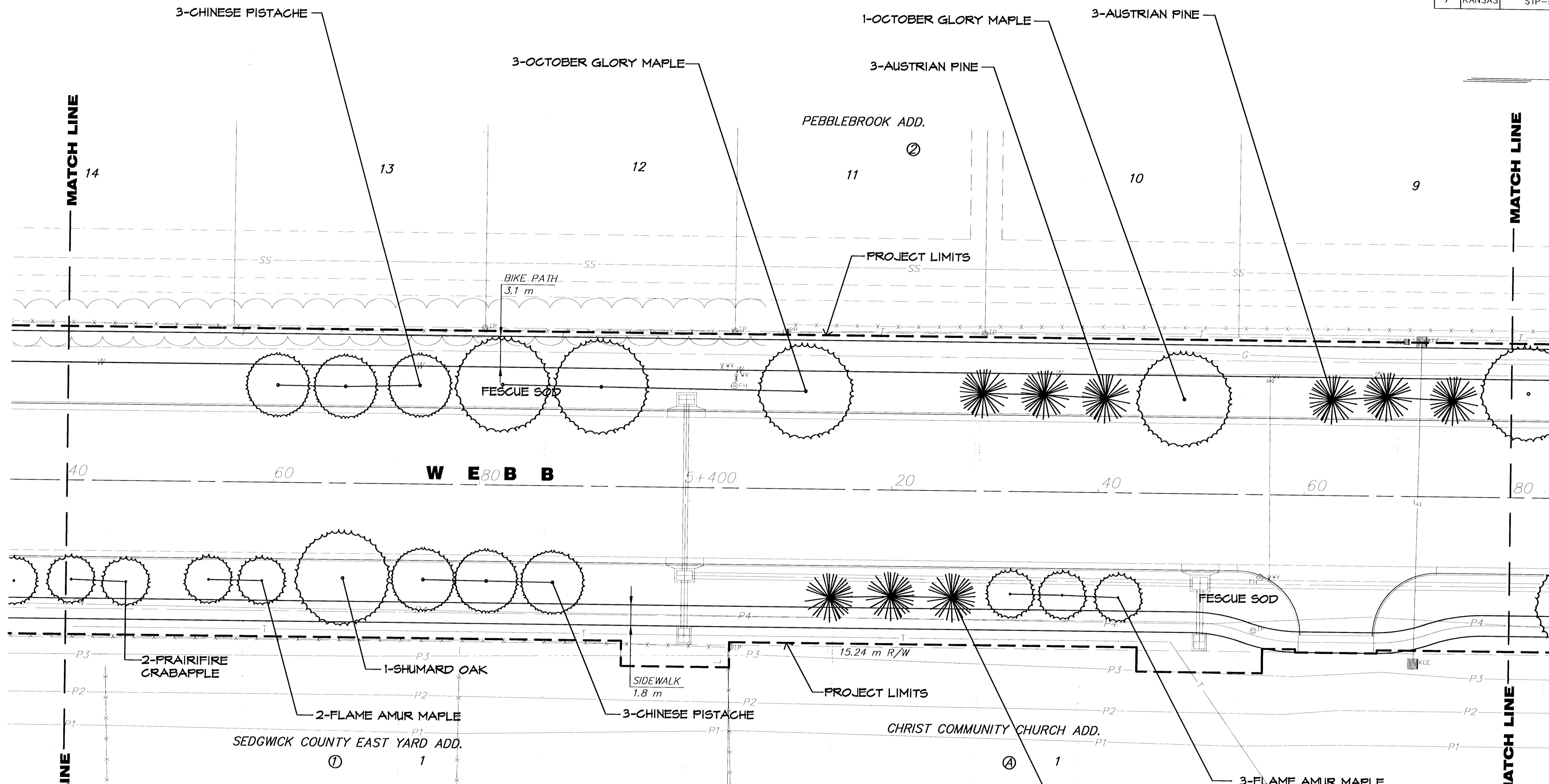

**PLANT LIST FOR THIS SHEET**

QTY.	COMMON NAME	BOTANICAL NAME	SIZE	CONDITION/REMARKS
<b>LARGE DECIDUOUS TREES</b>				
4	OCTOBER GLORY MAPLE	<i>Acer rubrum</i> 'October Glory'	2.5" cal.	Balled-in-Burlap
1	SHUMARD OAK	<i>Quercus shumardii</i>	2.5" cal.	Balled-in-Burlap
6	CHINESE PISTACHE	<i>Pistacia chinensis</i>	2.5" cal.	Balled-in-Burlap
<b>EVERGREEN TREES</b>				
6	AUSTRIAN PINE	<i>Pinus nigra</i>	8'	Balled-in-Burlap
3	LIMBER PINE	<i>Pinus flexilis</i>	8'	Balled-in-Burlap
<b>ORNAMENTAL TREES</b>				
2	PRAIRIFIRE CRABAPPLE	<i>Malus sp.</i> 'Prairifire'	1.5" cal.	Balled-in-Burlap
3	FLAME AMUR MAPLE	<i>Acer ginnala</i> 'Flame'	1.5" cal.	Balled-in-Burlap
<b>LAWN</b>				
	K-31 FESCUE	<i>Festuca arundinacea</i> 'K-31'	SOD	

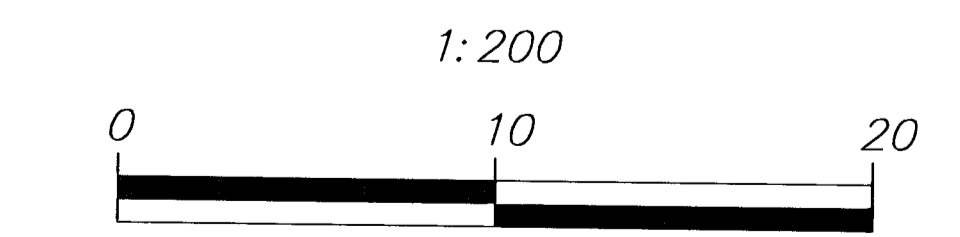

PLAN: Lat. & Long. (meters)  
 PROFILE: Horiz. same as above,  
 Vert. SCALE: 1 : 20

2					
1					
NO.	DATE	REVISIONS	BY	APP'D	
KANSAS DEPARTMENT OF TRANSPORTATION					
<b>LANDSCAPE IMPROVEMENTS</b>					
<b>WEBB ROAD</b>					
<b>STA. 5+340 TO STA. 5+480</b>					
PROJ. NO. 87 STP-N-0129-01					
<b>MKEC ENGINEERING CONSULTANTS, INC.</b>					
WICHITA, KANSAS					
DESIGNED BY:	JTC	CHECKED BY:	JTC		
DRAWN BY:	GJR	DATE:	APRIL 2002	SHEET 5 OF 14	

G:\CIVIL\PAV-WEBB\8712\ROADSIDE\LANDSCAPE\LANDSCAPE\LANDSCAPE\LANDSCAPE.dwg Thu Apr 11 16:21:34 2002