

FHWA REG. NO.	STATE	PROJECT NO.	YEAR	SHEET NO.	SHEETS
7	KANSAS	87N 0064-01	1997	21	130

- P.O.T. STA. 123+59.23
S.E. Cor. Sec. 30, T27S, R1E
1. Found Pipe in Thimble @ Seneca & Harry
 2. SW Cor. Quick Trip Sign Post 50.4' N.E.
 3. NW Cor. of Bldg. 67.7' S.E.
 4. SW Cor. of Bldg. 152.8' N.E.
 5. NE Cor. of Bldg. 129.1' S.W.

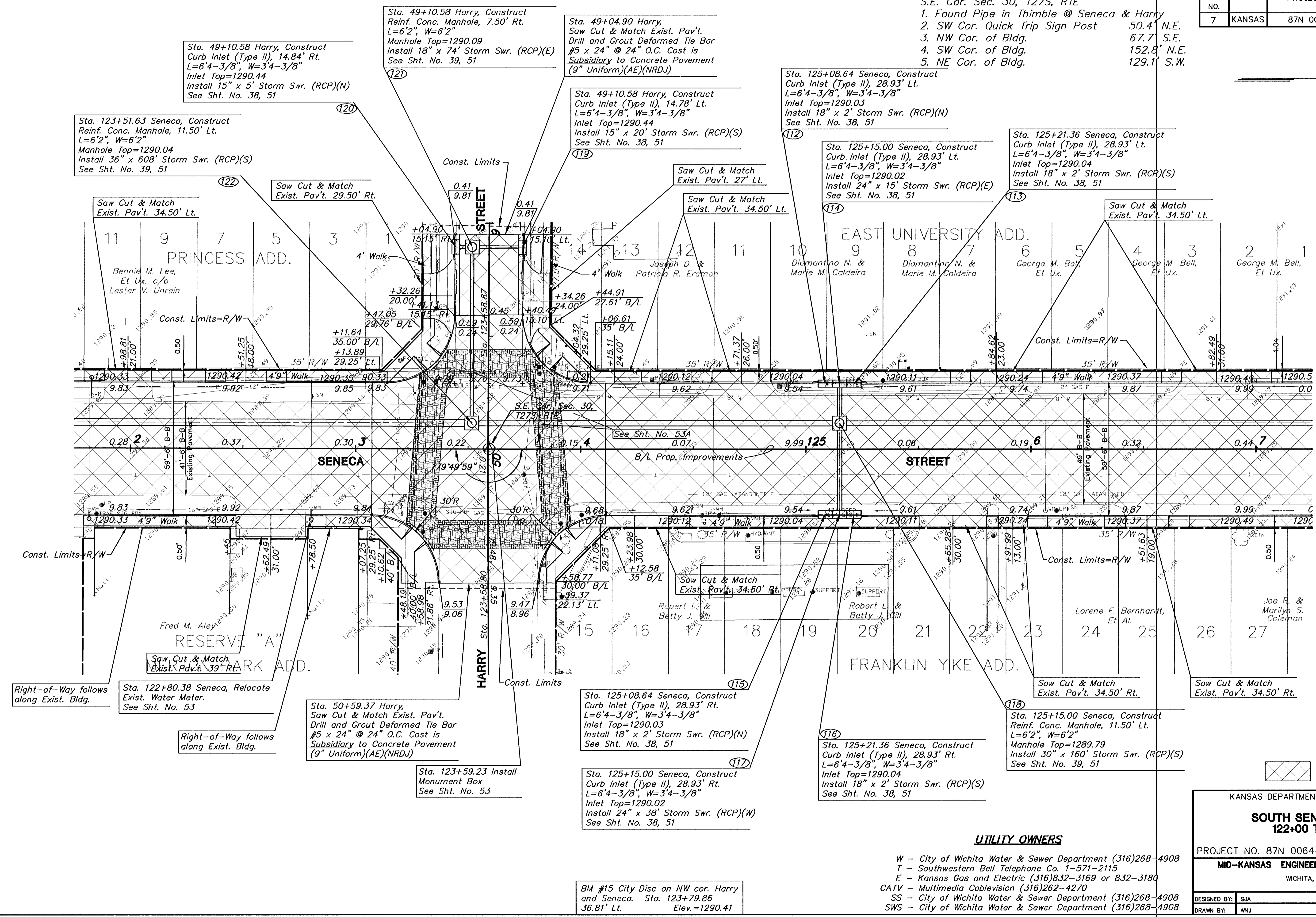

LEGEND
 PAYMENT, DRIVEWAY AND/OR SIDEWALK REMOVAL.

KANSAS DEPARTMENT OF TRANSPORTATION
SOUTH SENECA STREET
 122+00 TO 127+00

PROJECT NO. 87N 0064-01 SEDGWICK CO.
MID-KANSAS ENGINEERING CONSULTANTS, INC.
 WICHITA, KANSAS

DESIGNED BY: GJA	CHECKED BY: GJA
DRAWN BY: WNJ	DATE: 12/94

SHEET 21 OF 130

- UTILITY OWNERS**
- W - City of Wichita Water & Sewer Department (316)268-4908
 - T - Southwestern Bell Telephone Co. 1-571-2115
 - E - Kansas Gas and Electric (316)832-3169 or 832-3180
 - CATV - Multimedia Cablevision (316)262-4270
 - SS - City of Wichita Water & Sewer Department (316)268-4908
 - SWS - City of Wichita Water & Sewer Department (316)268-4908

BM #15 City Disc on NW cor. Harry and Seneca. Sta. 123+79.86
 36.81' Lt. Elev.=1290.41

H:\CIVIL\SENECA\PAVE\PAVE\84006E18.FG: MAY 30 11: 10: 05 1997