

FHWA REG NO.	STATE	PROJECT NO.	YEAR	SHEET NO.	SHEETS
7	KANSAS	87N 0064-01	1997	23	130

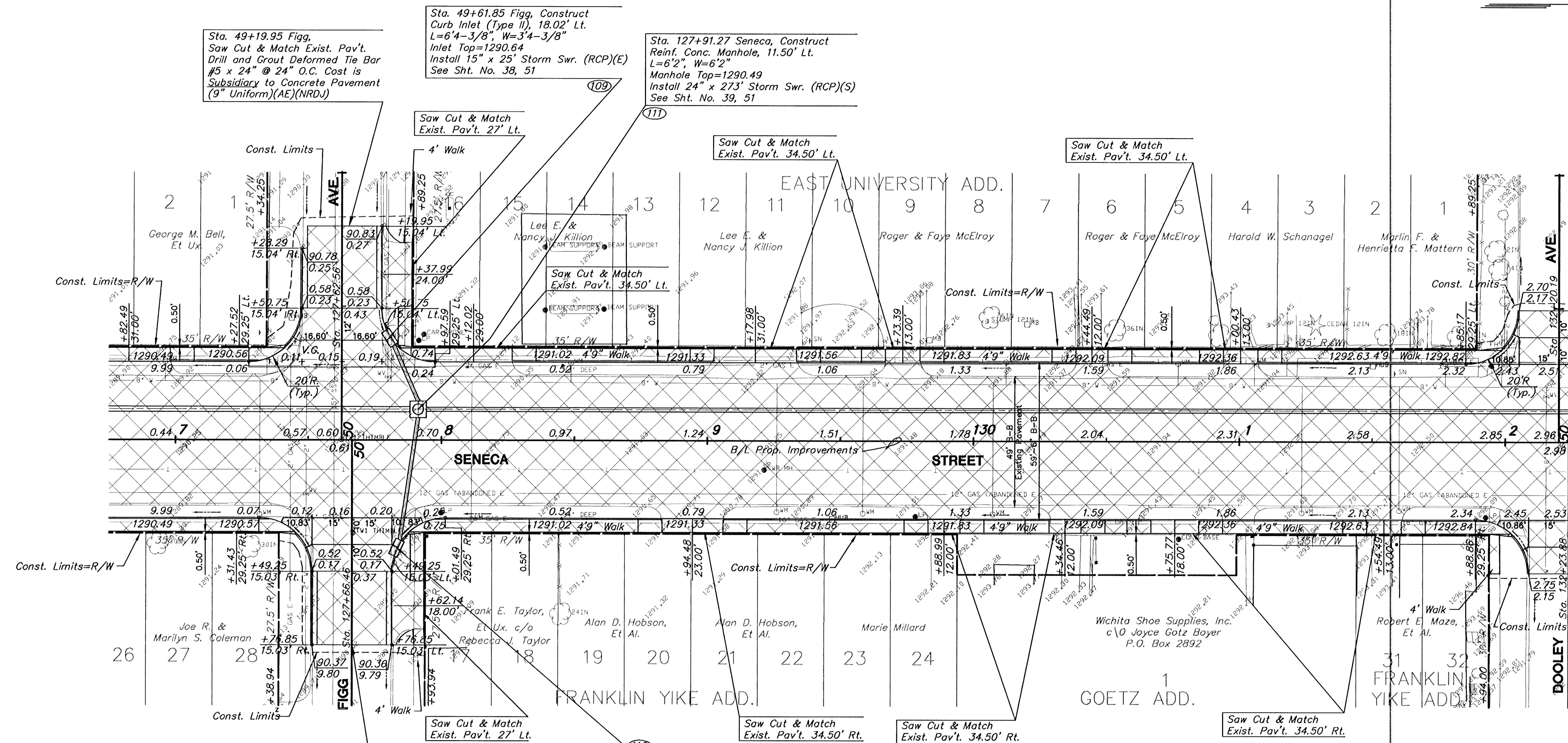
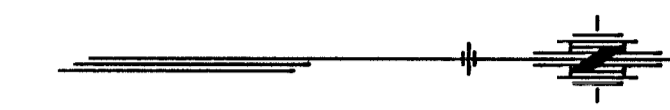

Sta. 49+19.95 Figg, Construct Saw Cut & Match Exist. Pav't. Drill and Grout Deformed Tie Bar #5 x 24" @ 24" O.C. Cost is Subsidiary to Concrete Pavement (9" Uniform)(AE)(NRDJ)

Sta. 49+61.85 Figg, Construct Curb Inlet (Type II), 18.02' Lt. L=6'4-3/8", W=3'4-3/8" Inlet Top=1290.64 Install 15" x 25' Storm Swr. (RCP)(E) See Sht. No. 38, 51

Sta. 127+91.27 Seneca, Construct Reinf. Conc. Manhole, 11.50' Lt. L=6'2", W=6'2" Manhole Top=1290.49 Install 24" x 273' Storm Swr. (RCP)(S) See Sht. No. 39, 51

Sta. 50+76.85 Figg, Construct Saw Cut & Match Exist. Pav't. Drill and Grout Deformed Tie Bar #5 x 24" @ 24" O.C. Cost is Subsidiary to Concrete Pavement (9" Uniform)(AE)(NRDJ)

Sta. 50+40.43 Figg, Construct Curb Inlet (Type II), 16.73' Lt. L=6'4-3/8", W=3'4-3/8" Inlet Top=1290.58 Install 15" x 49' Storm Swr. (RCP)(W) See Sht. No. 38, 51

UTILITY OWNERS

- W - City of Wichita Water & Sewer Department (316)268-4908
- T - Southwestern Bell Telephone Co. 1-571-2115
- E - Kansas Gas and Electric (316)832-3169 or 832-3180
- CATV - Multimedia Cablevision (316)262-4270
- SS - City of Wichita Water & Sewer Department (316)268-4908
- SWS - City of Wichita Water & Sewer Department (316)268-4908

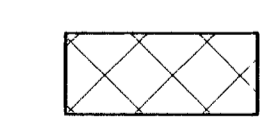

LEGEND
PAVEMENT, DRIVEWAY AND/OR
SIDEWALK REMOVAL.

KANSAS DEPARTMENT OF TRANSPORTATION

**SOUTH SENECA STREET
127+00 TO 132+00**

PROJECT NO. 87N 0064-01 SEDGWICK CO.

MID-KANSAS ENGINEERING CONSULTANTS, INC.
WICHITA, KANSAS

DESIGNED BY: GJA	CHECKED BY: GJA
DRAWN BY: WNJ	DATE: 8/95
SHEET 23 OF 130	

H:\CVT\IL\SENECA\87005\PAVE\87005E19.FR1 May 30 11:11:21 1997

87005E19