

FHWA REG NO.	STATE	PROJECT NO.	YEAR	SHEET NO.	SHEETS
7	KANSAS	87N-0064-01	1997	69	130

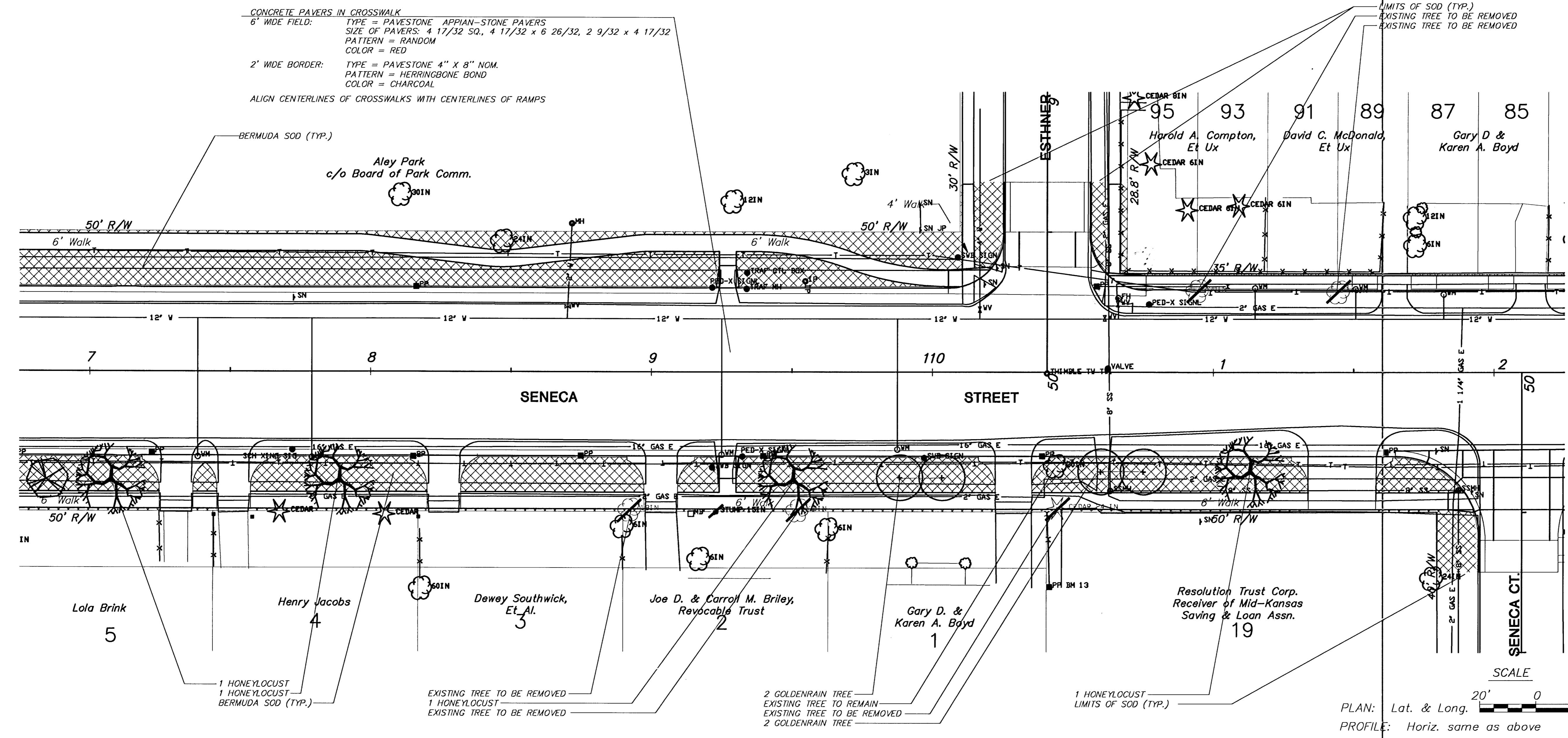

CONCRETE PAVERS IN CROSSWALK
 6" WIDE FIELD: TYPE = PAVESTONE APPIAN-STONE PAVERS
 SIZE OF PAVERS: 4 17/32 SQ., 4 17/32 x 6 26/32, 2 9/32 x 4 17/32
 PATTERN = RANDOM
 COLOR = RED
 2" WIDE BORDER: TYPE = PAVESTONE 4" X 8" NOM.
 PATTERN = HERRINGBONE BOND
 COLOR = CHARCOAL
 ALIGN CENTERLINES OF CROSSWALKS WITH CENTERLINES OF RAMPS

LIMITS OF SOD (TYP.)
 EXISTING TREE TO BE REMOVED
 EXISTING TREE TO BE REMOVED

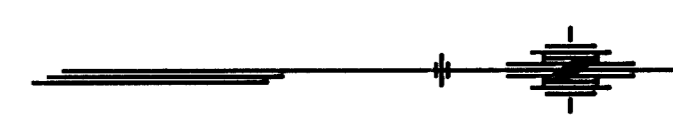
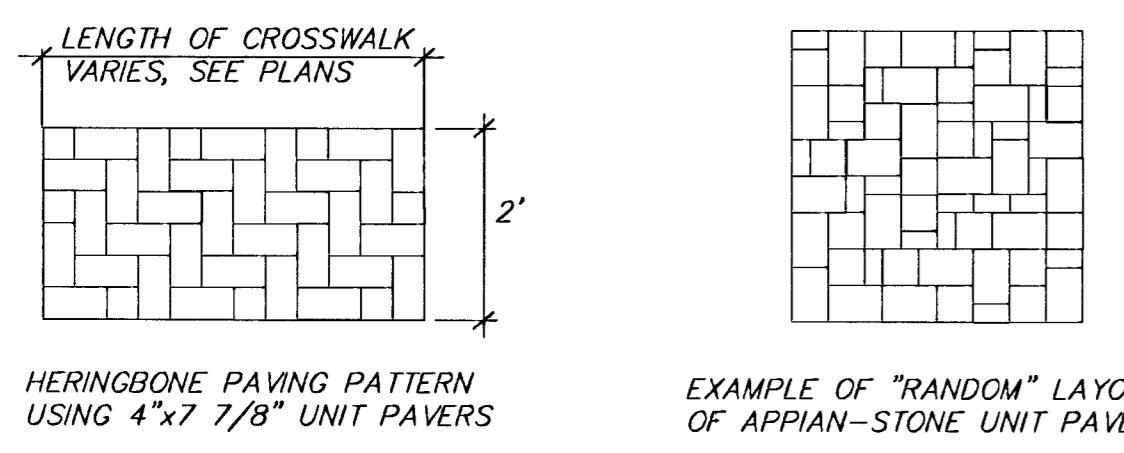
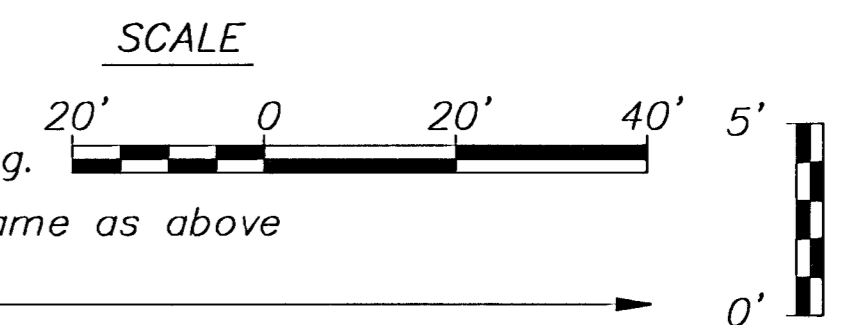

PER-SHEET LANDSCAPE BID QUANTITIES

QTY.	BOTANICAL NAME	COMMON NAME	SIZE	ROOT
4	GLEDITSIA TRIACANTHOS VAR. INERMIS CV. IMPERIAL	IMPERIAL HONEYLOCUST	2"	CAL. B&B
4	KOELREUTERIA PANICULATA	GOLDENRAIN TREE	2"	CAL. B&B

UTILITY OWNERS
 W - City of Wichita Water & Sewer Department (316)268-4908
 T - Southwestern Bell Telephone Co. 1-571-2115
 E - Kansas Gas and Electric (316)832-3169 or 832-3180
 G - Peoples Natural Gas Co. (316)946-0096
 CATV - Multimedia Cablevision (316)262-4270
 SS - City of Wichita Water & Sewer Department (316)268-4908
 SWS - City of Wichita Water & Sewer Department (316)268-4908

KANSAS DEPARTMENT OF TRANSPORTATION
SOUTH SENECA STREET
107+00 TO 112+00
LANDSCAPE PLAN
 PROJECT NO. 87N-0064-01 SEDGWICK CO.
 MID-KANSAS ENGINEERING CONSULTANTS, INC.
 WICHITA, KANSAS

DESIGNED BY: DJA/WDM	CHECKED BY: LME/WDM
DRAWN BY: DJA/WDM	DATE: 2/97 SHEET 69 OF 130

94005E15