

FHWA REG NO.	STATE	PROJECT NO.	YEAR	SHEET NO.	SHEETS
7	KANSAS	87N 0064-01	1997	99	130

**GENERAL NOTES**

TEMPORARY TYPE I 4" YELLOW PAVEMENT MARKING (SOLID DOUBLE) TO CONTINUE BEYOND ENDS OF WORK AREA TO CHANNEL TRAFFIC TO EXISTING LANES. (SEE PLAN.)

THE CONTRACTOR WILL INSTALL AND OPERATE A TEMPORARY TRAFFIC SIGNAL AT THE INTERSECTION OF SENECA AND HARRY UNTIL SUCH TIME AS THE PERMANENT TRAFFIC SIGNAL IS IN OPERATION.

Scale: 1" = 150'

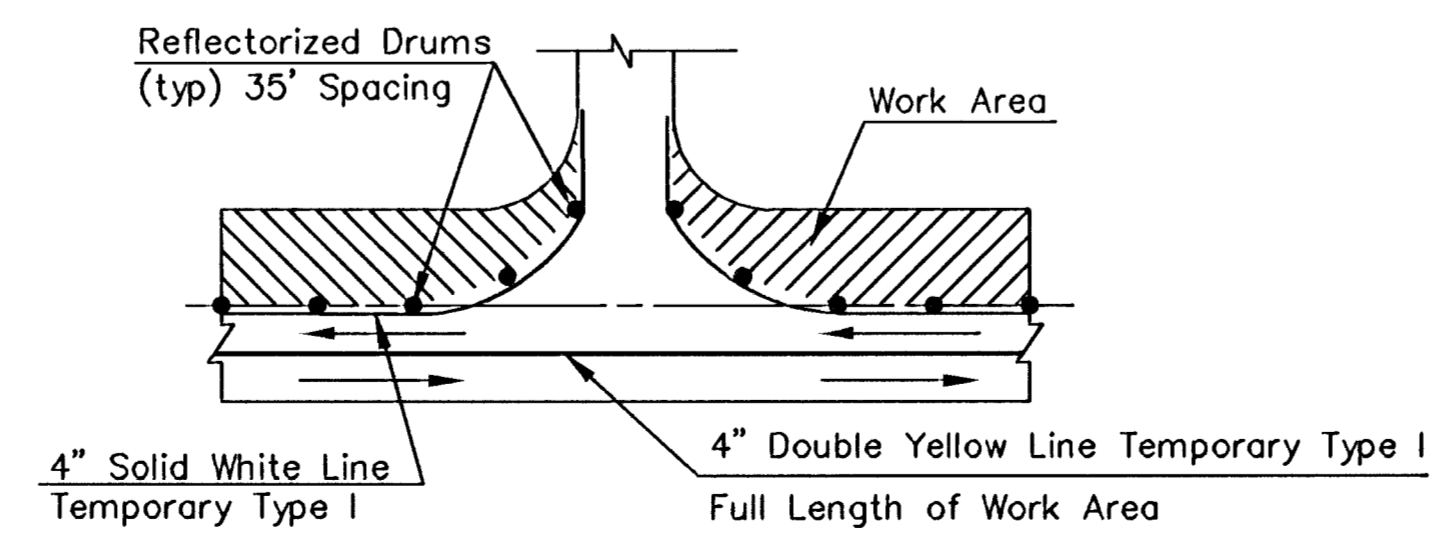
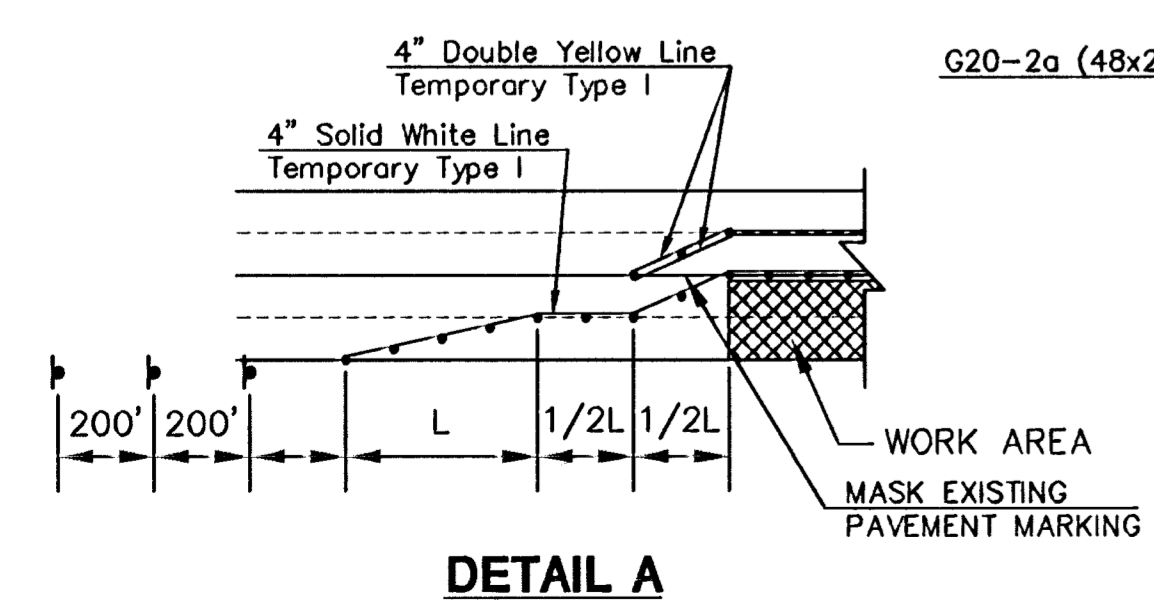
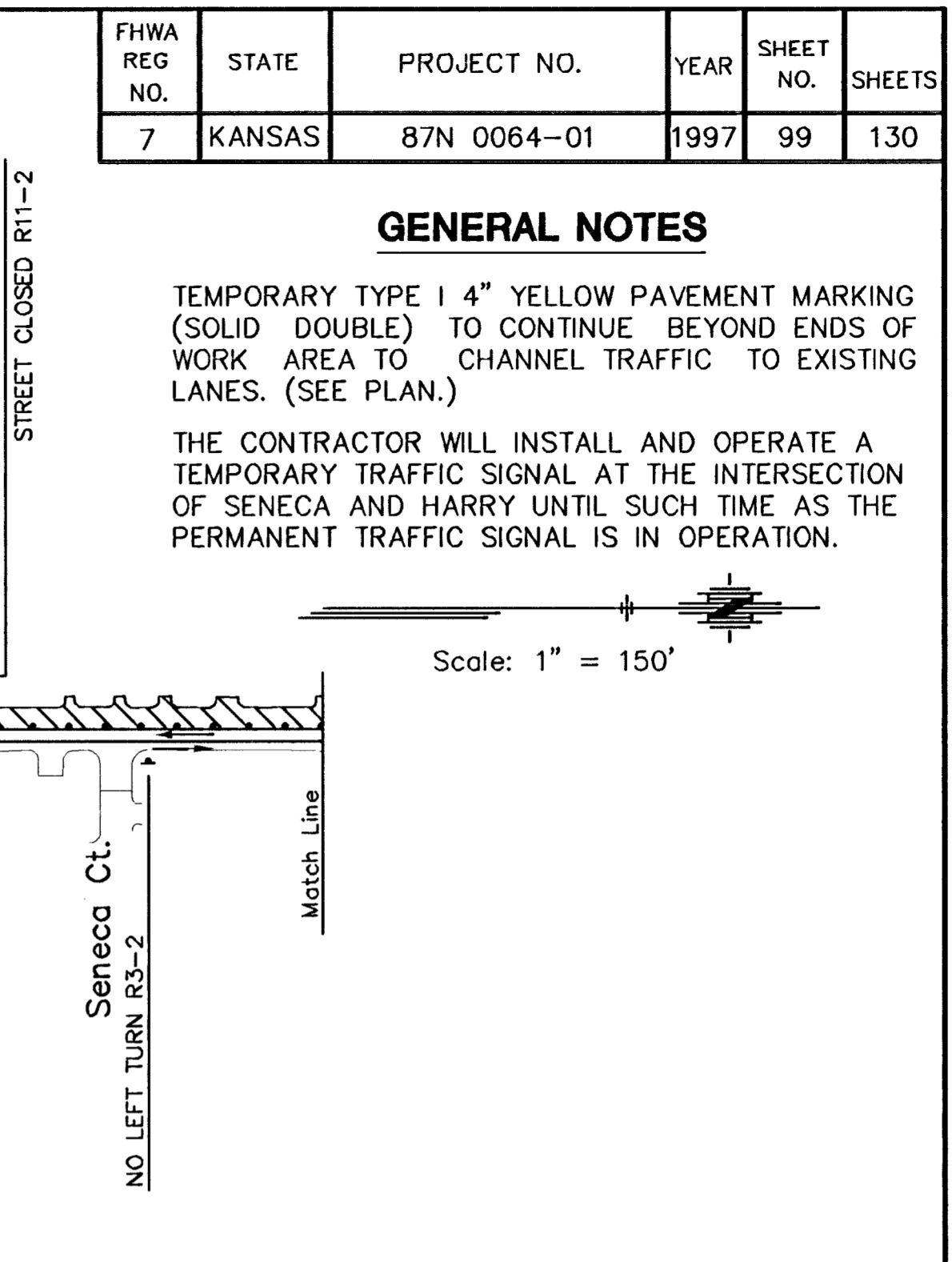
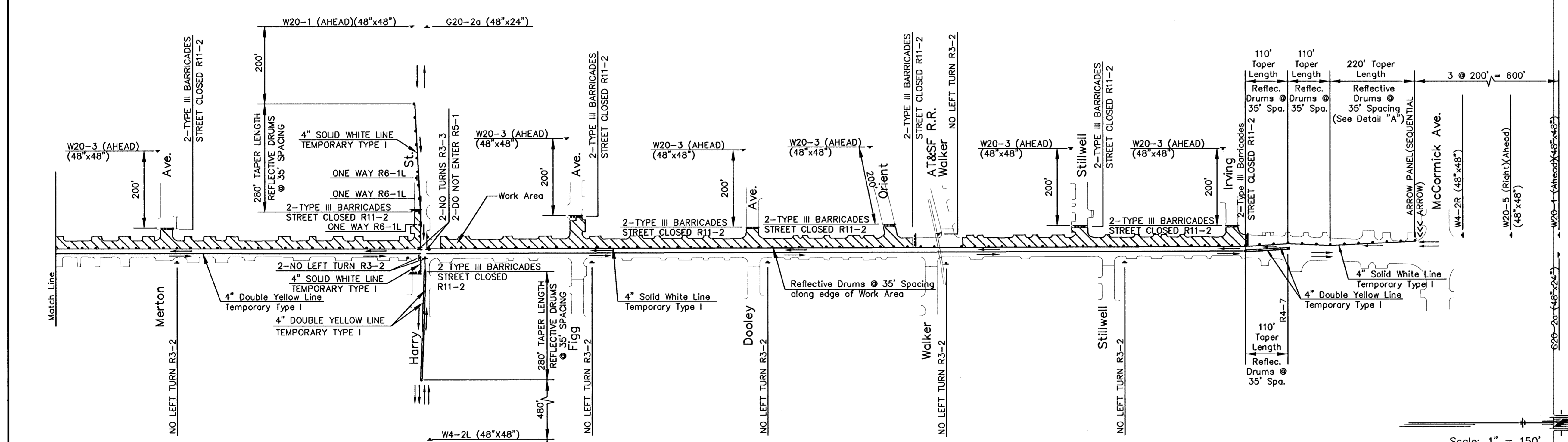
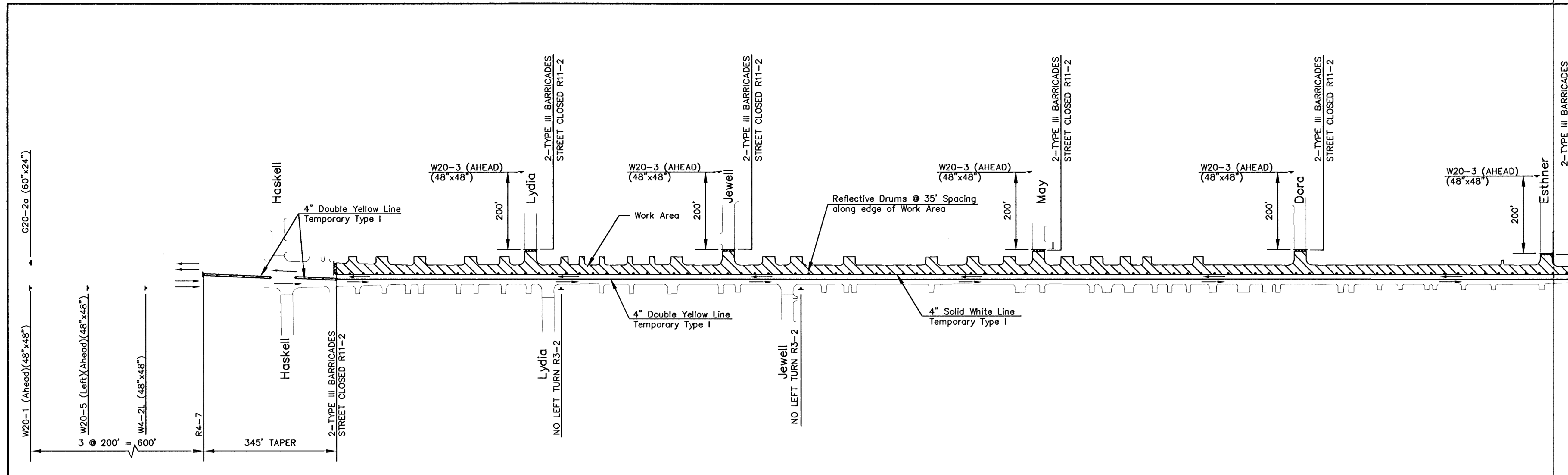

**TYPICAL ENTRANCE AND SIDE STREET**

**PHASE IIA**

KANSAS DEPARTMENT OF TRANSPORTATION

**SENECA STREET TRAFFIC CONTROL PHASE II & PHASE IIA**

PROJECT NO. 87N 0064-01 SEDGWICK CO.

**MID-KANSAS ENGINEERING CONSULTANTS, INC.**

WICHITA, KANSAS

DESIGNED BY: GJA	CHECKED BY: GJA
DRAWN BY: WNJ	DATE: SHEET 99 OF 130

H:\CIVIL\SENECA\94005\TRAF\9405TRF-4.FR May 30 13:45:04 1997