

FHWA REG NO.	STATE	PROJECT NO.	YEAR	SHEET NO.	SHEETS
7	KANSAS	87N 0064-01	1997	100	130

**TEMPORARY SIGNAL NOTES**

1. ALL WIRING INSTALLED SHALL CONFORM TO THE NATIONAL ELECTRICAL CODE AND LOCAL ORDINANCES AND REQUIREMENTS.
2. ALL SIGNAL CABLE AND FEEDER RUNS TO BE CARRIED OVERHEAD ON SPAN WIRE ACROSS ROADWAYS OR IN CONDUIT UNDER THE ROADWAYS.
3. THE OPERATION AND MAINTENANCE OF THE SIGNAL SYSTEM SHALL BE THE RESPONSIBILITY OF THE CONTRACTOR.
4. ALL SIGNAL INDICATIONS, CLEARANCES, AND SEQUENCES SHALL BE IN ACCORDANCE WITH THE CURRENT M.U.T.C.D.
5. TEMPORARY SIGNAL HEADS SHALL BE 4-WAY TYPE A.
6. THE SPAN WIRE SIGNAL HEADS SHALL BE CENTERED OVER THE EXIT LANES.
7. THE SPAN WIRE SIGNAL HEADS SHALL BE INCLUDED IN THE BID ITEM "TRAFFIC SIGNAL INSTALLATION (TEMPORARY)".
8. THE TEMPORARY TRAFFIC SIGNALS SHALL BE SWITCHED ON DURING AN OFF-PEAK HOUR. WHEN SWITCHING SIGNALS, FLAGGERS WILL BE REQUIRED.
9. THE TERMINAL BLOCKS SHALL BE IN A WEATHERPROOF ENCLOSURE.
10. ALL NECESSARY SIGNAL HEAD, CONTROLLER AND POLE RELOCATIONS, WHETHER SPECIFICALLY MENTIONED OR NOT, SHALL BE THE CONTRACTOR'S RESPONSIBILITY.
11. TRAFFIC SIGNAL HEADS WHICH ARE IN PLACE AND NOT IN USE DURING A SPECIFIC STEP SHALL BE REMOVED OR COVERED WITH AN OPAQUE MATERIAL.
12. SIGNAL PHASING AND TIMING SHALL BE SET AS INDICATED ON THE PLANS UNLESS OTHERWISE APPROVED BY THE ENGINEER IN CHARGE OF CONSTRUCTION.
13. THE SIGNAL SHALL HAVE A SIGNAL CONTROLLER CAPABLE OF A STANDARD EIGHT PHASE OPERATION, WITH GREEN INTERVALS ABLE TO BE SET FROM 0 TO 255 SECONDS.
14. THE TRAFFIC SIGNAL CONTROLLER MUST BE CAPABLE OF STORING A MINIMUM OF THREE SEPARATE PHASING/TIMING PLANS, WHICH CAN BE SELECTED ON A TIME-OF-DAY BASIS.
15. IN CASE OF SIGNAL MALFUNCTION, THE CONTRACTOR MUST RESPOND WITHIN ONE HOUR OF NOTIFICATION.

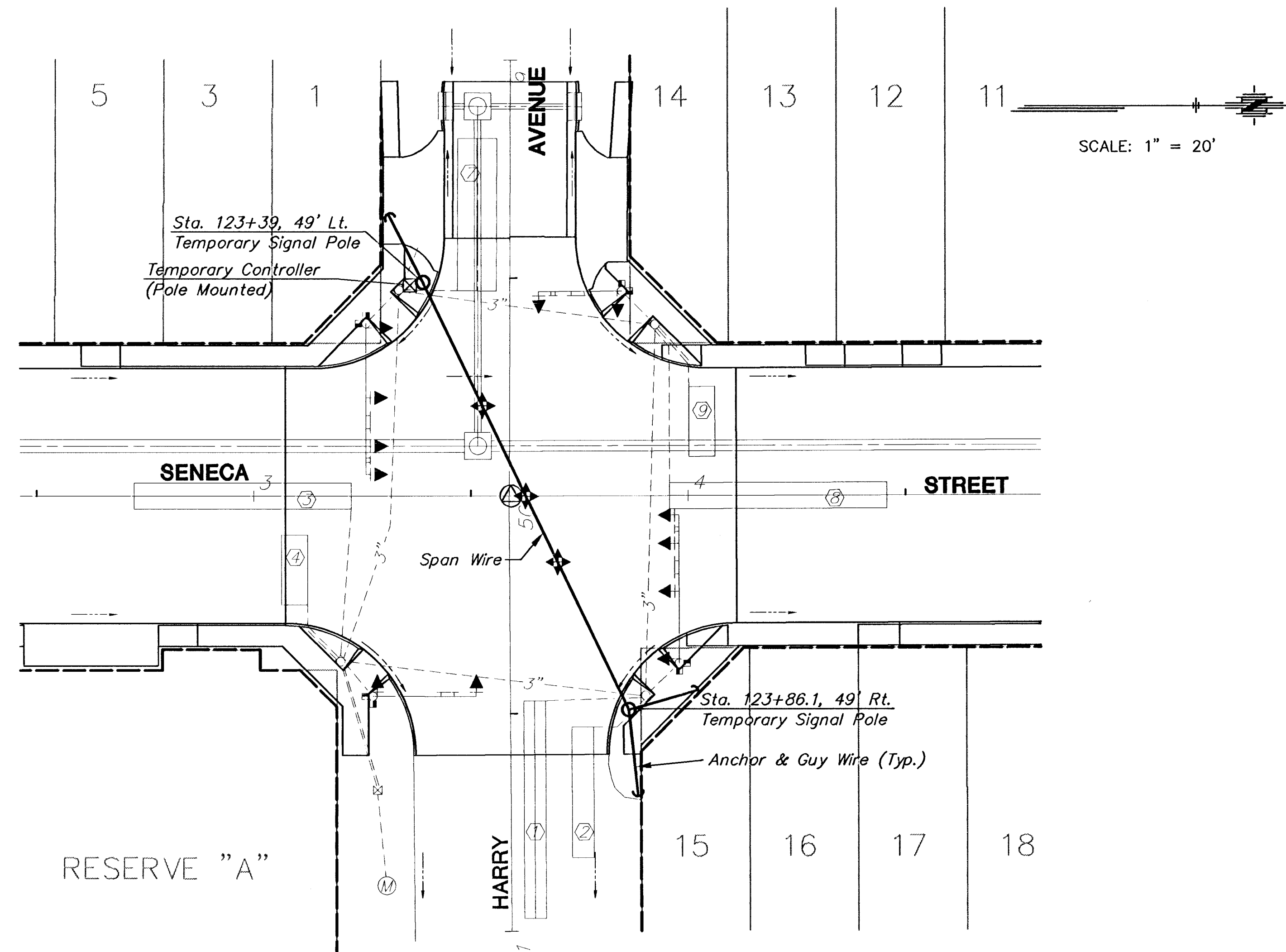

**LEGEND**

- Prop. Steel Traffic Signal Pole (Joint use)
- Prop. Steel Traffic Signal Pole (Std. Pole)
- ▶ Prop. Traffic Signal Indication (Type A)
- ◀ Prop. Traffic Signal with Backplate (Type A)
- ⬇ Prop. Mast Arm Suspended Traffic Signal
- Prop. Service Box
- ⊠ Prop. Controller
- Prop. Pedestrian Indication
- ◁ Prop. Junction Box
- ▭ Prop. Vehicle Detector Loop
- ① Prop. Detector Number
- Prop. Rigid Galvanized Conduit (RGC) Trenched
- Ⓜ Prop. Meter Box and Power Disconnect
- ⌈ Prop. Overhead Street Name Sign
- Temporary Traffic Signal Pole
- ◆ Temporary Traffic Signal (4-Way)(Type A)

TEMPORARY SIGNAL TIMING			
TIME OF DAY	PHASE	SECONDS	COLOR
3:30-6:00 P.M.	N-S	50	G
		4.0	Y
	E-W	1.5	AR
		35	G
		4.0	Y
ALL OTHER TIMES	N-S	40	G
		4.0	Y
	E-W	1.5	AR
		25	G
		4.0	Y
		1.5	AR

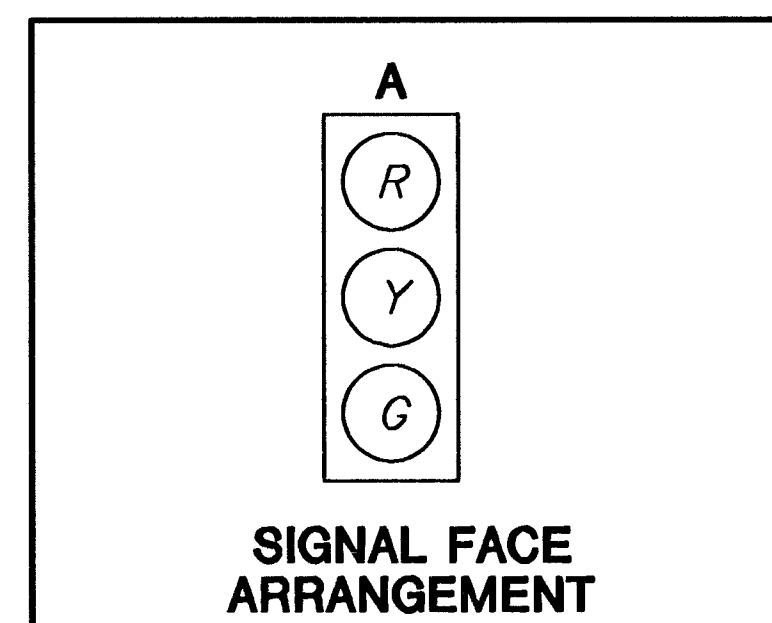

KANSAS DEPARTMENT OF TRANSPORTATION

**SENECA STREET AND HARRY ST.**  
**TEMPORARY TRAFFIC SIGNALIZATION PLAN**

PROJECT NO. 87N 0064-01      SEDGWICK CO.

**MID-KANSAS ENGINEERING CONSULTANTS, INC.**  
WICHITA, KANSAS

DESIGNED BY: PAF	CHECKED BY: GJA
DRAWN BY: PAF	DATE: SHEET 100 OF 130

SACBTPSS

H:\CIVIL\SENECA\94005\G10M\1940BTPSS F1 May 30 13:47:37 1997