

BENCHMARK:
 BM #1: "□" Cut in middle of N headwall of RCBC on 21st St. North. 1004.3' W & 22.1' N of SE Cor., SE1/4, Sec. 2, T-27-S, R-2-E.
 Elev. = 173.23 City Datum

BM #2: "□" Cut at the SE corner of the intersection of Castle Rock & Castle Rock Ct., Krug North Addition.
 Elev. = 183.50 City Datum

Scale: 1" = 20'
 • = Iron

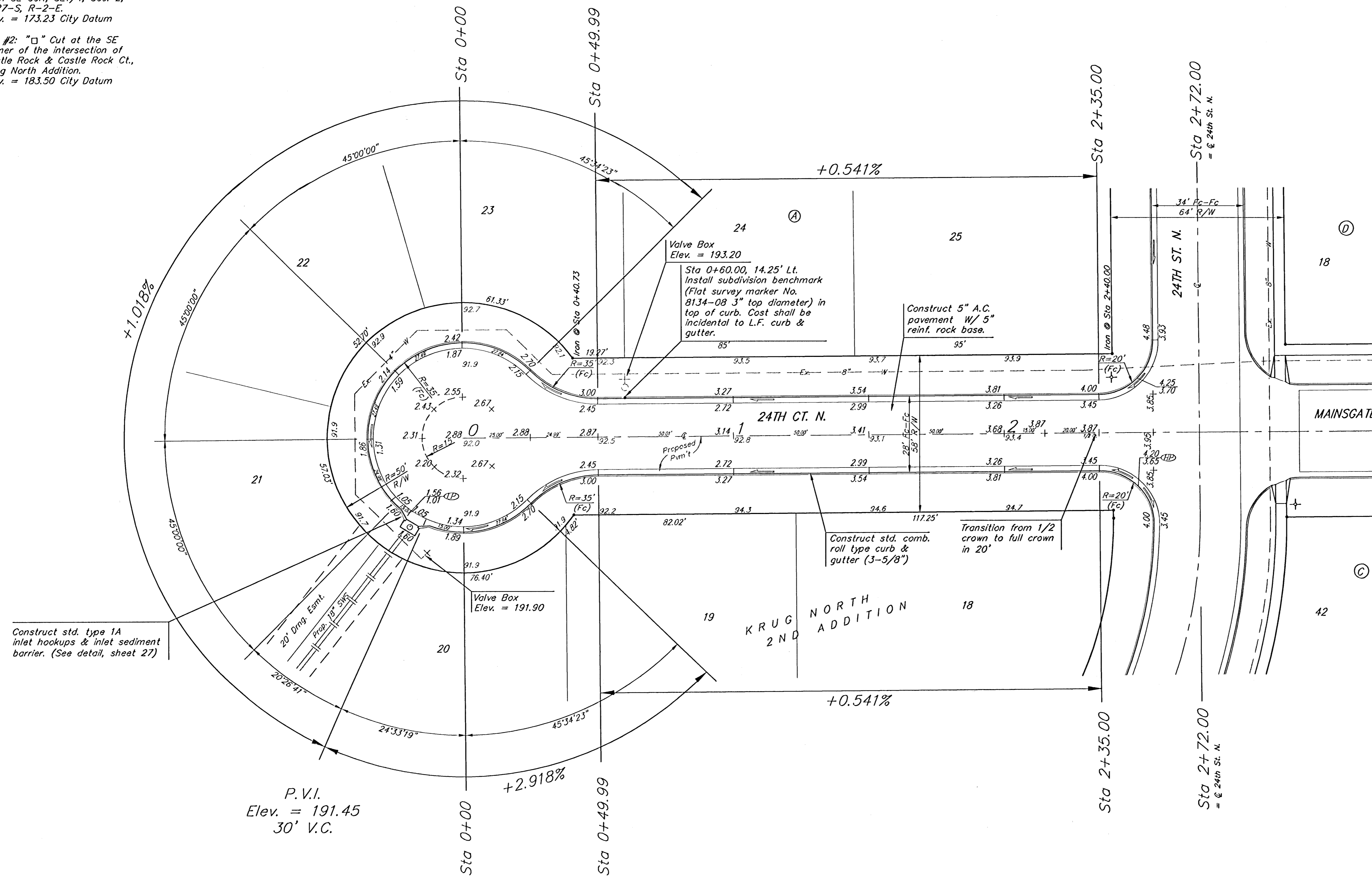

Construct std. type 1A inlet hookups & inlet sediment barrier. (See detail, sheet 27)

Valve Box
 Elev. = 193.20
 Sta 0+60.00, 14.25' Lt.
 Install subdivision benchmark (Flat survey marker No. 8134-08 3" top diameter) in top of curb. Cost shall be incidental to L.F. curb & gutter.

Construct std. comb. roll type curb & gutter (3-5/8")

Transition from 1/2 crown to full crown in 20'

Construct 5" A.C. pavement w/ 5" reinf. rock base.

NOTE: ROLL TYPE CURB & GUTTER TO BE CONSTRUCTED ON THE PAVEMENT SHOWN ON THIS SHEET. TOP OF CURB ELEVATIONS ARE GIVEN FOR FULL HEIGHT CURB.

Baughman		KRUG NORTH 2ND ADD. - PH. III	
		24TH CT. N.	
		STA 0+00 TO STA 2+72.00	
<small>Baughman Company, P.A. 315 Ellis St. Wichita, KS 67211 P3162827271 F3162820149 ENGINEERING SURVEYING PLANNING LANDSCAPE ARCHITECTURE</small>			
PROJECT NUMBER 47234249	DESIGN ATD	DRAWN TMS	
REVISIONS	APPROVED	DATE 01/06	
	SCALE Noted	SHEET	
		12	OF 39
<small>KrugNorth2nd\PhaseIII\Sz7</small>		<small>0509B368</small>	