

BENCHMARK:
 BM #1: "□" Cut in middle of N headwall of RCBC on 21st St. North. 1004.3' W & 22.1' N of SE Cor., SE1/4, Sec. 2, T-27-S, R-2-E. Elev. = 173.23 City Datum

BM #2: "□" Cut at the SE corner of the intersection of Castle Rock & Castle Rock Ct., Krug North Addition. Elev. = 183.50 City Datum

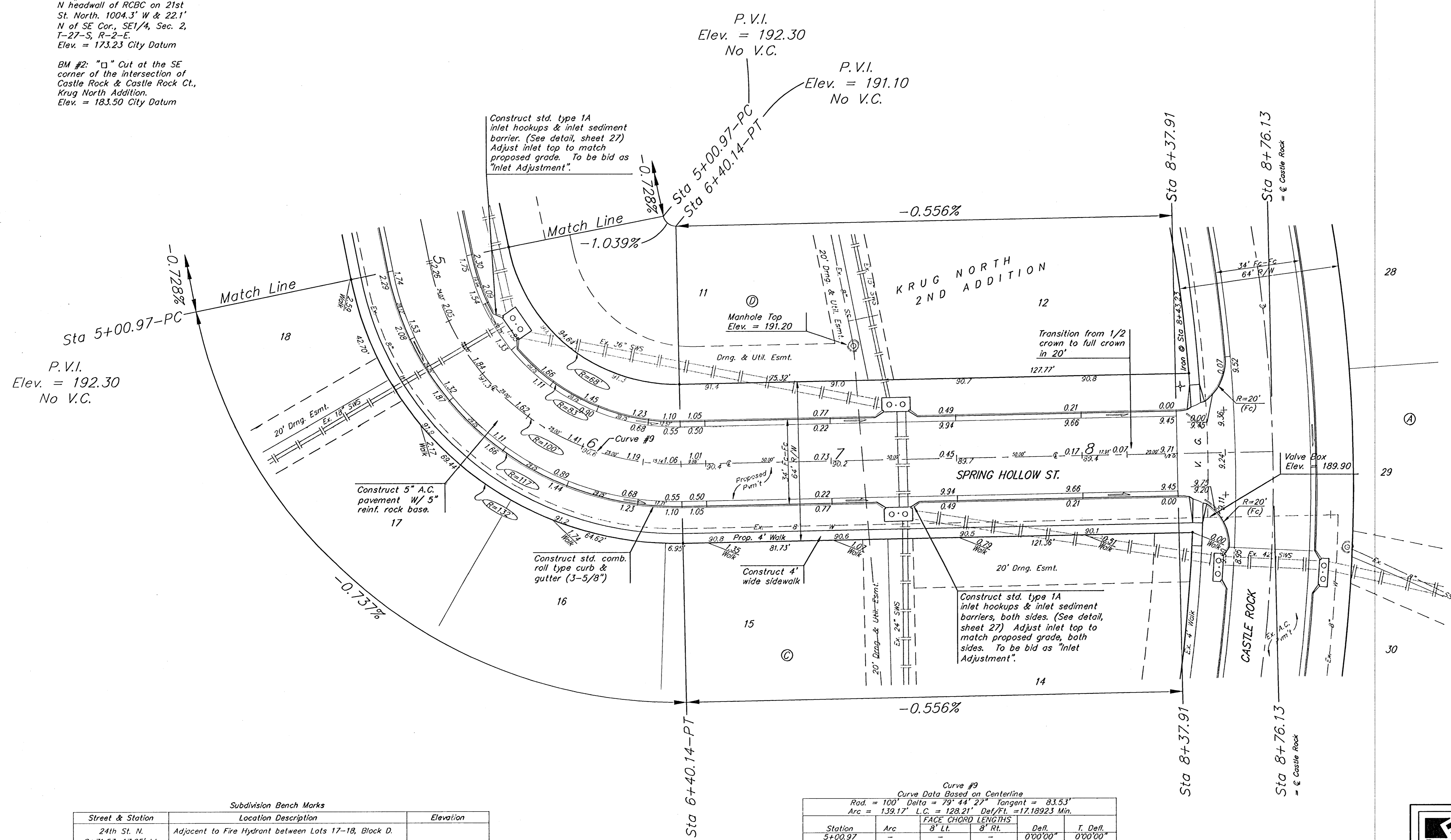

P.V.I.
 Elev. = 192.30
 No V.C.

P.V.I.
 Elev. = 192.30
 No V.C.

P.V.I.
 Elev. = 191.10
 No V.C.

P.V.I.
 Elev. = 191.10
 No V.C.

Subdivision Bench Marks

Street & Station	Location Description	Elevation
24th St. N. 8+71.53, 17.25' Lt.	Adjacent to Fire Hydrant between Lots 17-18, Block D.	
Mainsgate Cir. 0+49.28, 17.25' Rt.	Adjacent to Fire Hydrant between Lots 24-25, Block C.	
Mainsgate 7+19.57, 17.25' Rt.	Adjacent to Fire Hydrant between Lots 2-3, Block D.	
24th Ct. N. 0+60.00, 14.25' Lt.	Adjacent to Fire Hydrant between Lots 23-24, Block A.	
Spring Hollow St. 3+86.61, 17.25' Rt.	Adjacent to Fire Hydrant between Lots 19-20, Block C.	

Curve #9
 Curve Data Based on Centerline
 Rad. = 100' Data = 79' 44' 27" Tangent = 83.53'
 Arc = 139.17' L.C. = 128.21' Def/Fl. = 17.18923 Min.

Station	FACE CHORD LENGTHS				T. Defl.
	Arc	8' Lt.	8' Rt.	Defl.	
5+00.97	-	-	-	0'00'00"	0'00'00"
5+25.00	24.03'	17.98'	29.97'	6'53'03"	6'53'03"
5+50.00	25.00'	18.70'	31.17'	7'09'44"	14'02'47"
5+75.00	25.00'	18.70'	31.17'	7'09'44"	21'12'31"
6+00.00	25.00'	18.70'	31.17'	7'09'44"	28'22'15"
6+25.00	25.00'	18.70'	31.17'	7'09'44"	35'31'59"
6+40.14	15.14'	11.34'	18.91'	4'20'15"	39'52'13"

NOTE: ROLL TYPE CURB & GUTTER TO BE CONSTRUCTED ON THE PAVEMENT SHOWN ON THIS SHEET. TOP OF CURB ELEVATIONS ARE GIVEN FOR FULL HEIGHT CURB.

Baughman KRUG NORTH 2ND ADD. - PH. III
SPRING HOLLOW ST.
 STA 5+00.97 TO STA 8+76.13

Baughman Company, P.A. 315 Ellis St. Wichita, KS 67211 P 316-262-7711 F 316-262-0149
 ENGINEERING | SURVEYING | PLANNING | LANDSCAPE ARCHITECTURE

PROJECT NUMBER 472-34249	DESIGN AID	DRAWN TMS
REVISIONS	APPROVED	DATE 01/06
	SCALE Noted	SHEET 14 OF 39

KrugNorth2nd\PhaseIII\Str9 0509B368