

Subdivision Bench Marks

No.	Street and Station	From CL	Description	Elevation
4	Stafford, Sta. 8+48.19	17.0' Lt.	S.E. End of Curb Return Intersection of Stafford and Stoneybrook	

Curve 3
Curve Data Based on Centerline
Rad. = 100' Delta = 90°00'00" Tangent = 100.00'
Arc = 156.64' L.C. = 141.42' Def/Flt. = 17.23698 Min.

Station	FACE CHORD LENGTHS			
	Arc	8 Lt.	8 Rt.	F. Defl.
7+16.02	-	-	-	0°00'00"
7+25.00	8.98'	11.25'	6.75'	2°34'47"
7+50.00	25.00'	31.26'	18.75'	7°10'55"
7+75.00	25.00'	31.26'	18.75'	7°10'55"
8+00.00	25.00'	31.26'	18.75'	7°10'55"
8+25.00	25.00'	31.26'	18.75'	7°10'55"
8+50.00	25.00'	31.26'	18.75'	7°10'55"
8+72.65	22.65'	28.33'	17.00'	6°30'25"

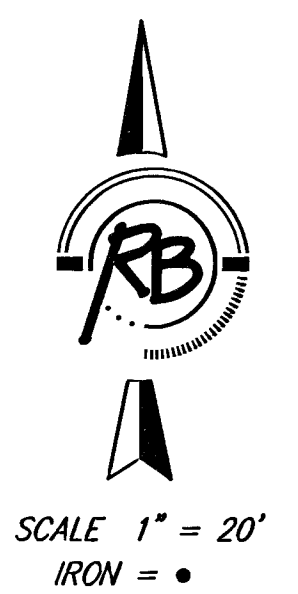
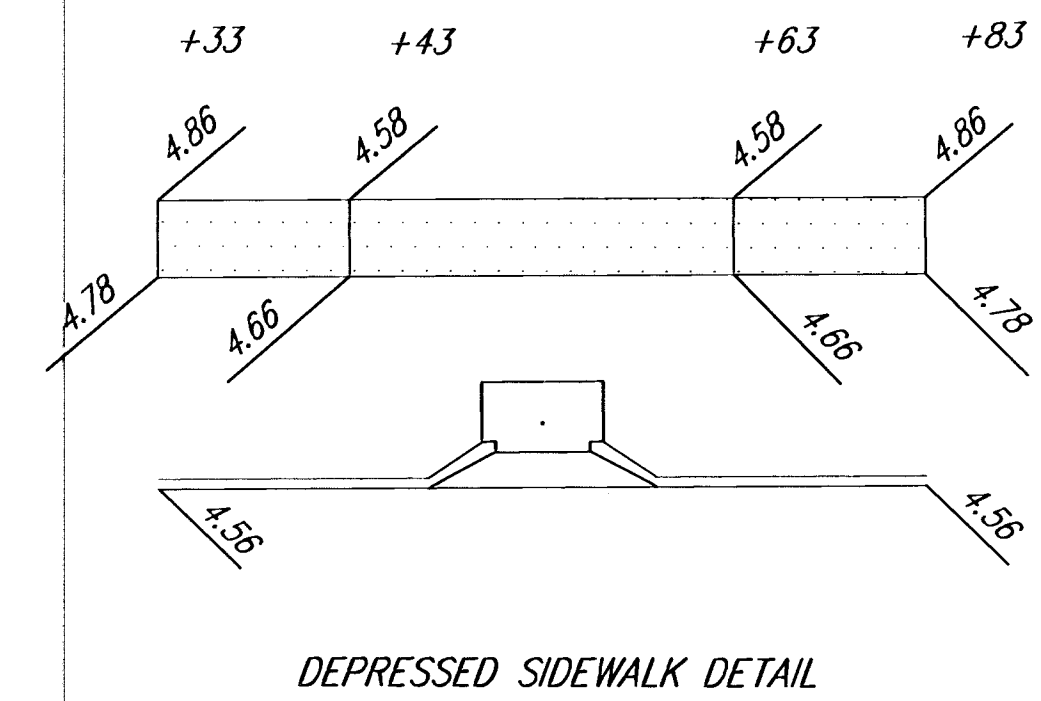
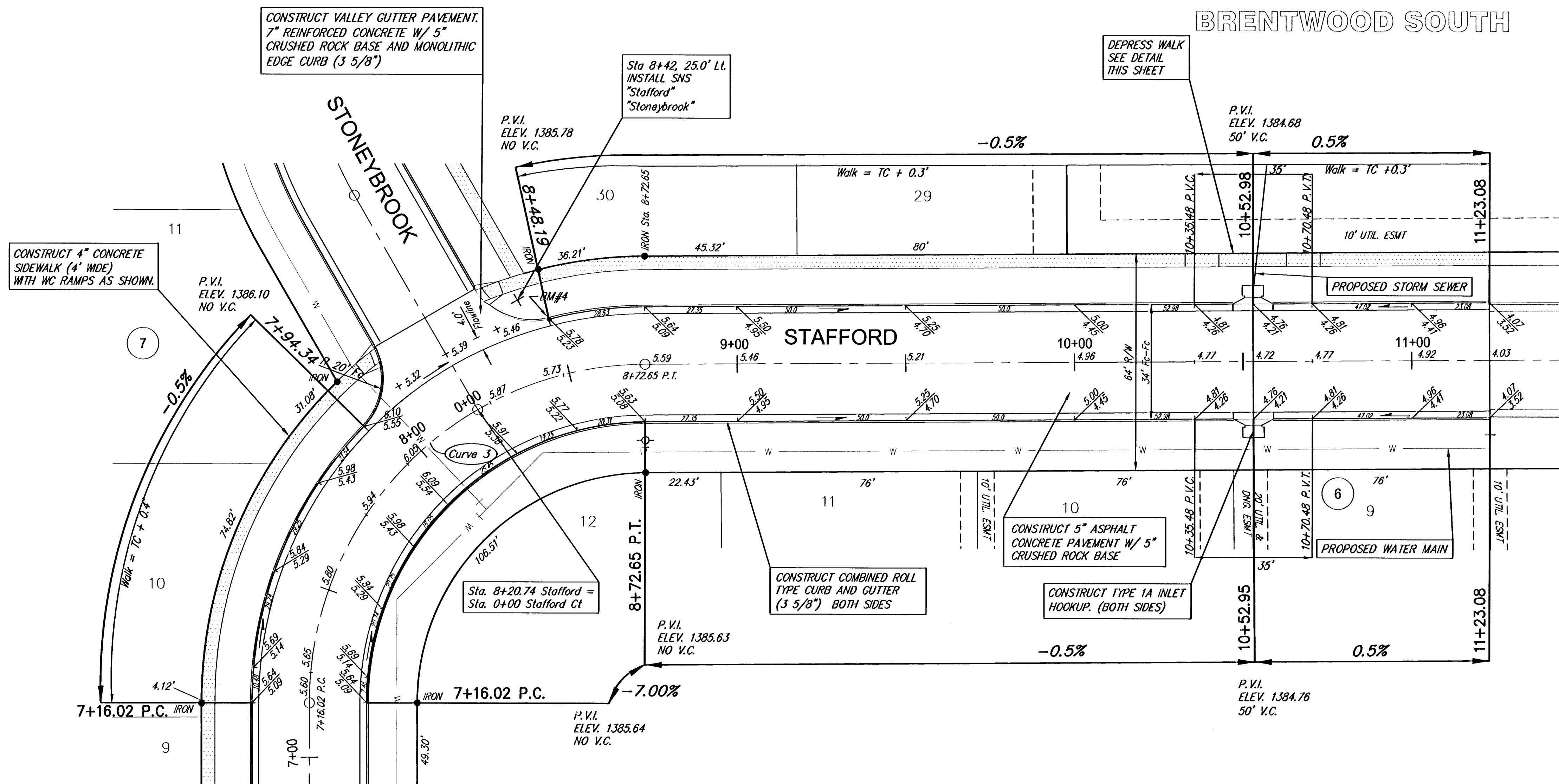

Brentwood South Addition, Paving Improvements
Stoneybrook
WICHITA, KANSAS

 Ruggles & Bohm, P.A. Engineering, Surveying, Land Planning 924 North Main Wichita, Kansas 67203 www.rbkansas.com (316) 264-8008 (316) 264-4621 fax E-mail: info@rbkansas.com	DESIGN KWL	SHEET 7 OF 30
	DRAWN RLS	
DRAWING FILE paving {Stafford (3)}	PROJECT NUMBER 472-84270	DATE Sept. 13, 2005