

21ST ST. N. DECEL LANE IMPROVEMENTS

84229

TO SERVE
CROSS POINTE (PHASE 1)
THE ENTRANCE BETWEEN LOTS 4 AND 5, BLOCK 1

OCA NO. 765979
CITY OF WICHITA PROJECT NO. 472-84229
CITY OF WICHITA, KANSAS
JAMES L. ARMOUR, P.E. - CITY ENGINEER

INDEX OF SHEETS

1.	TITLE SHEET
2.	KEY MAP AND GENERAL NOTES
3.	PLAT
4.	TYPICAL SECTION
5.	PAVING PLAN
6.	VALLEY CUTTER DETAILS
7.	STANDARD TYPE 1 CURB INLET (10' OPENING)
8.	EROSION CONTROL PLAN
9-10.	EROSION CONTROL DETAILS
11-12.	CROSS SECTIONS

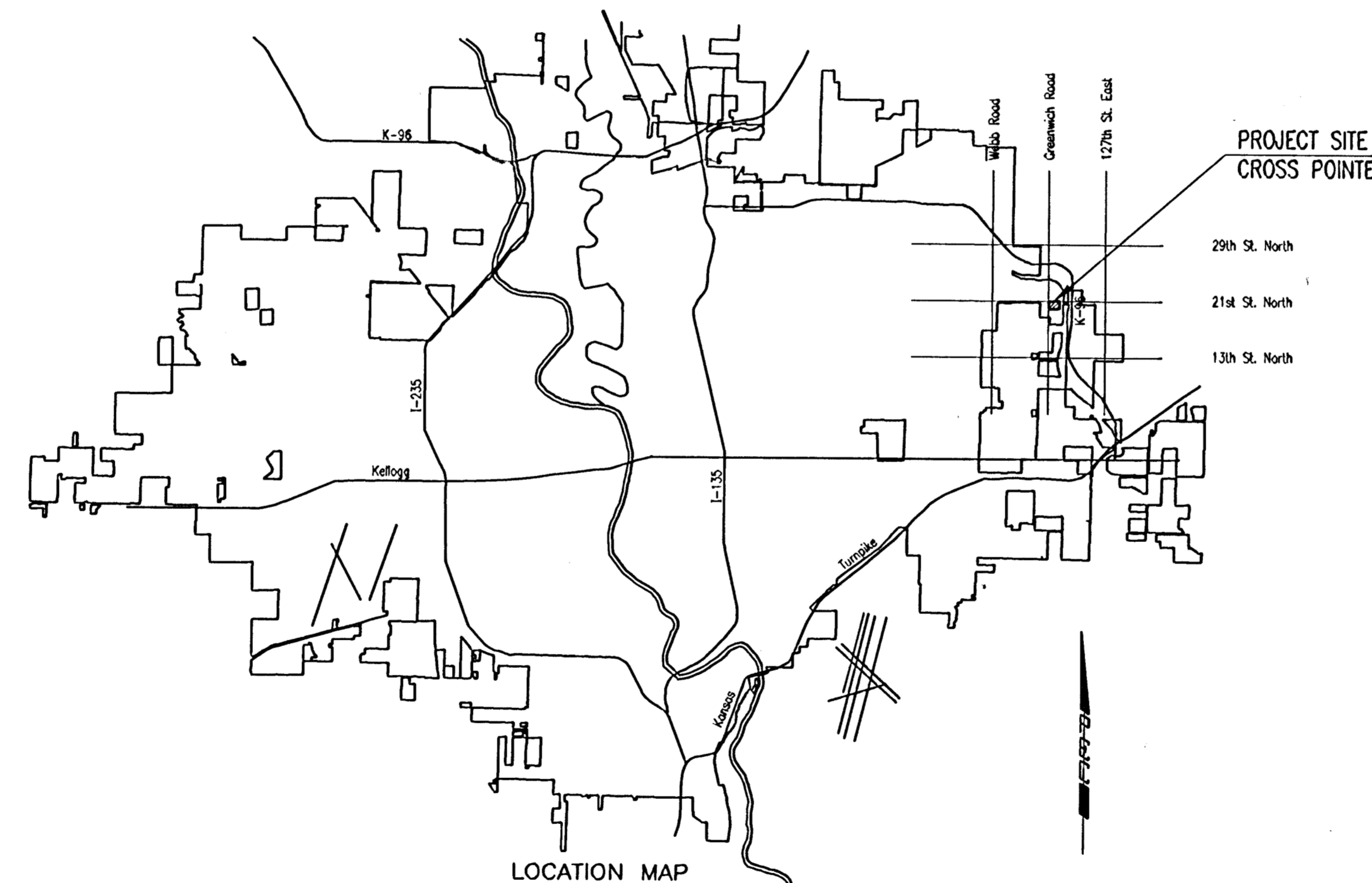

PROJECT LENGTH = 293 LIN. FT.

EARTHWORK

EXCAVATION 451 CU. YDS.*
* SEE NOTE 5, SHEET NO. 4.

EXCESS EXCAVATED MATERIAL SHALL BE
DISPOSED OF ON A SITE PROVIDED BY THE
CONTRACTOR AND APPROVED BY THE ENGINEER.

WORK ON THIS PROJECT SHALL
BE COMPLETED BY MAY 19, 2006.

FEBRUARY 2006

PLANS PREPARED BY
PROFESSIONAL ENGINEERING CONSULTANTS, P.A.
ENGINEERS
WICHITA, KANSAS

