

BENCHMARKS:
 RR spike in asphalt, SW Cor.,
 N1/2, SW1/4, Sec. 34, TWP. 26-S,
 R-2-E.
 Elev. = 1400.59 NAVD

R.R. spike in E. face of power pole,
 174± N. of S. line, N1/2, SW1/4
 & 49± E. of W. line, SW1/4, SEC.
 34, TWP. 26-S, R-2-E.
 Elev. = 1398.64 NAVD88

RR. spike in S. face of power pole,
 294± S. of N. line, SW1/4, &
 48± E. of W. line, SW1/4, SEC.
 34, TWP. 26-S, R-2-E.
 Elev. = 1386.14 NAVD88

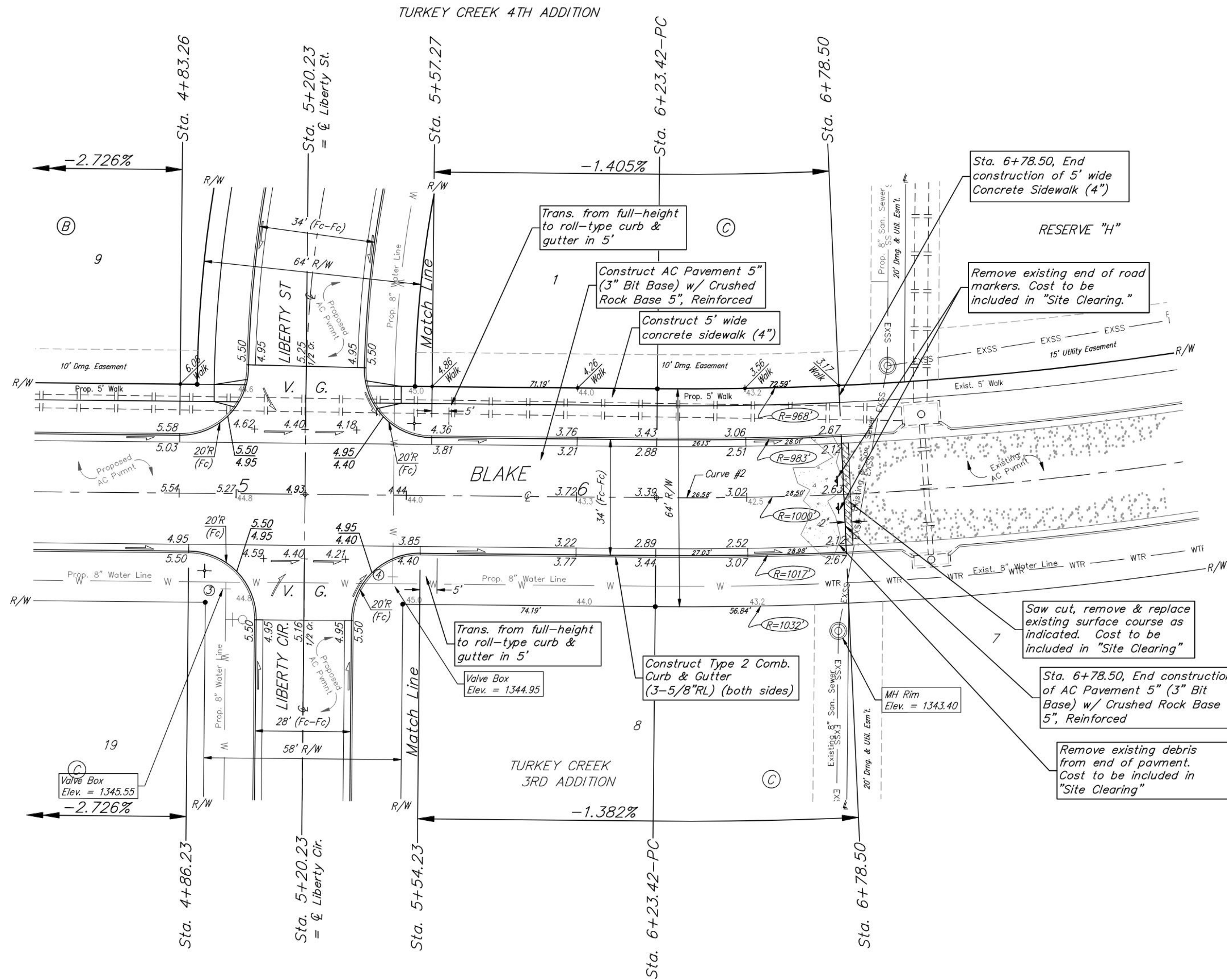
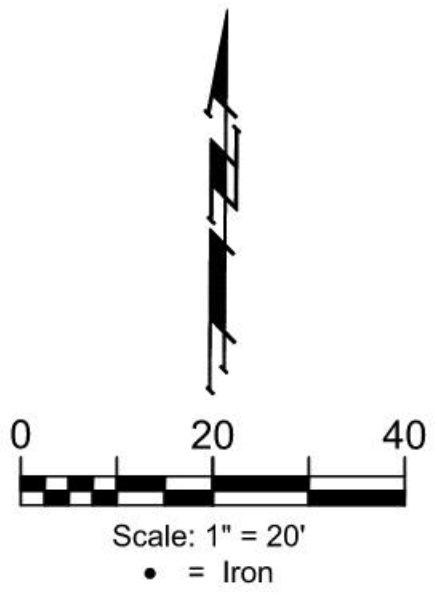

Curve #2
 Curve Data Based on Centerline
 Rad. = 1000' Delta = 3'09"20" Tangent = 27.54'
 Arc = 55.08' L.C. = 55.07' Def./Ft. = 1.71871 Min.

Station	Arc	Face Chord Lengths		Defl.	Total Defl.
		8' Left	8' Right		
6+23.42	-	-	-	0'00"00"	0'00"00"
6+25.00	1.58'	1.54'	1.62'	0'02"43"	0'02"43"
6+50.00	25.00'	25.00'	25.62'	0'42"58"	0'45"41"
6+75.00	25.00'	24.37'	25.62'	0'42"58"	1'28"39"
6+78.50	3.50'	3.41'	3.59'	0'06"01"	1'34"40"

Roll type curb & gutter to be constructed on the pavement on this sheet.
 Top of curb elevation are given for full height curb.



BAUGHMAN COMPANY
 315 Ellis St.
 Wichita, KS 67211
 316-262-7271
 BaughmanCo.com

TURKEY CREEK 4TH
 ADDITION - PHASE III
BLAKE ST

Sta. 5+57.27 to Sta. 6+78.50
 Street Paving Improvements
 PROJECT NUMBER:
 472-2020-085620
 DESIGN: DMV DRAWN: JAK
 DATE: Sept. 18, 2023
 SHEET OF
9 28

File: E:\Projects\Turkey Creek 4th Addition\Engineering\Phase 3\STR_22-06-E217\STR_22-06-E217.dwg