

NORTH RIDGE VILLAGE ADDITION

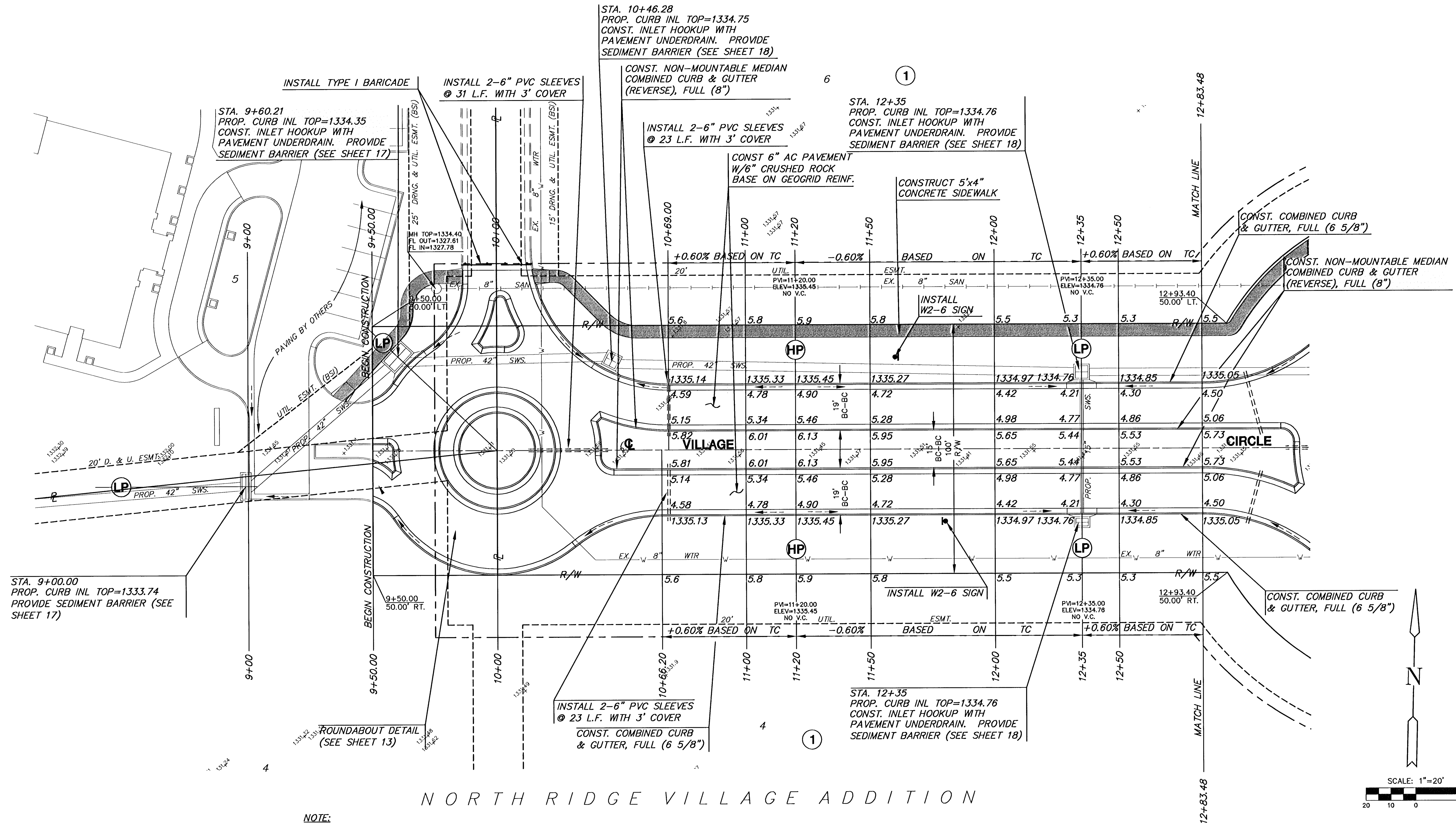

NORTH RIDGE VILLAGE ADDITION

NOTE:

1. TOP OF CURB ELEVATIONS SHOWN ARE FOR FULL OR NON-MOUNTABLE CURB. THE TOP OF CURB ELEVATIONS FOR AREAS TO BE CONSTRUCTED AS ROLL-TYPE CURB ARE SHOWN FOR FULL CURB. CONSTRUCT CURB AS NOTED.
2. ALL DIMENSIONS AND RADII ARE SHOWN TO BACK OF CURB UNLESS OTHERWISE NOTED.
3. PVC SLEEVES CAN BE ADJUSTED IF CONFLICTS WITH OTHER UTILITY LINES. MINIMUM DEPTHS OF COVER SHALL BE 18".
4. CONTRACTOR TO VERIFY LOCATION AND ELEVATION OF EXISTING UTILITIES PRIOR TO CONSTRUCTION.

LEGEND

- = STREET SIGN & SIGN LOCATION (SEE SIGN ASSEMBLY TABLE FOR TYPE & STATION OF SIGN)
- = VALLEY GUTTER
- = SIDEWALK
- = PVC SLEEVES

MKEC
ENGINEERING
CONSULTANTS
411 N. WEBB ROAD
WICHITA, KS. 67206
316-684-9600

NORTH RIDGE VILLAGE ADDITION
PROJECT NAME

VILLAGE CIRCLE
SHEET TITLE

| | | |
|----------------------|------------------|------------------------|
| MAB DESIGN BY. | KWS DRAWN BY. | MAB/DFL CHECKED BY. |
| JANUARY 2006 DATE | 04394 JOB NO. | 9 / 34 SHEET/OF |

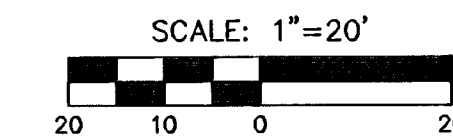

L:\DWG\04394\DWG\PLAN\04394E.DWG