

NORTH RIDGE VILLAGE ADDITION

NOTE:

1. TOP OF CURB ELEVATIONS SHOWN ARE FOR FULL OR NON-MOUNTABLE CURB. THE TOP OF CURB ELEVATIONS FOR AREAS TO BE CONSTRUCTED AS ROLL-TYPE CURB ARE SHOWN FOR FULL CURB. CONSTRUCT CURB AS NOTED.
2. ALL DIMENSIONS AND RADII ARE SHOWN TO BACK OF CURB UNLESS OTHERWISE NOTED.
3. PVC SLEEVES CAN BE ADJUSTED IF CONFLICTS WITH OTHER UTILITY LINES. MINIMUM DEPTHS OF COVER SHALL BE 18".
4. CONTRACTOR TO VERIFY LOCATION AND ELEVATION OF EXISTING UTILITIES PRIOR TO CONSTRUCTION.

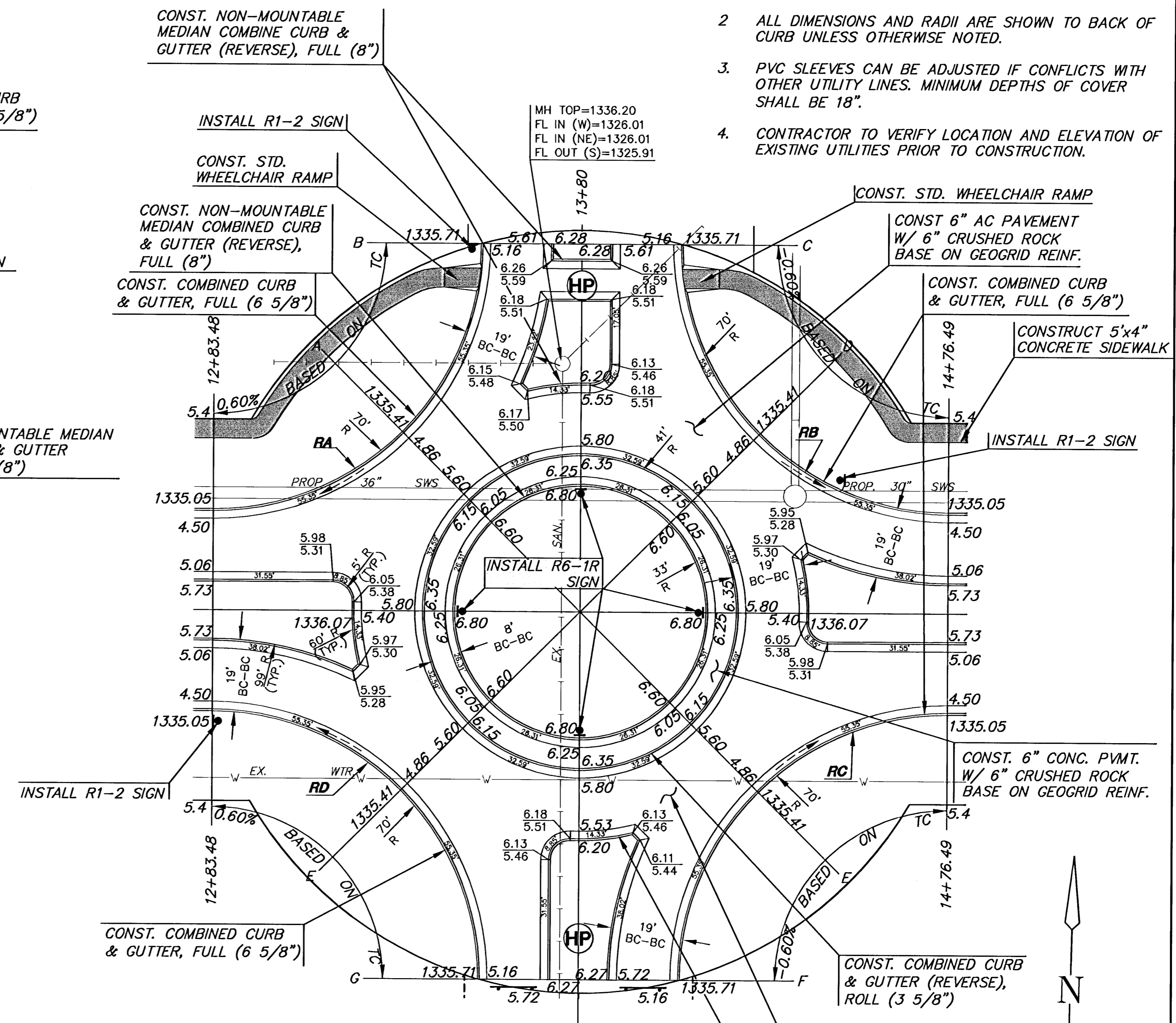
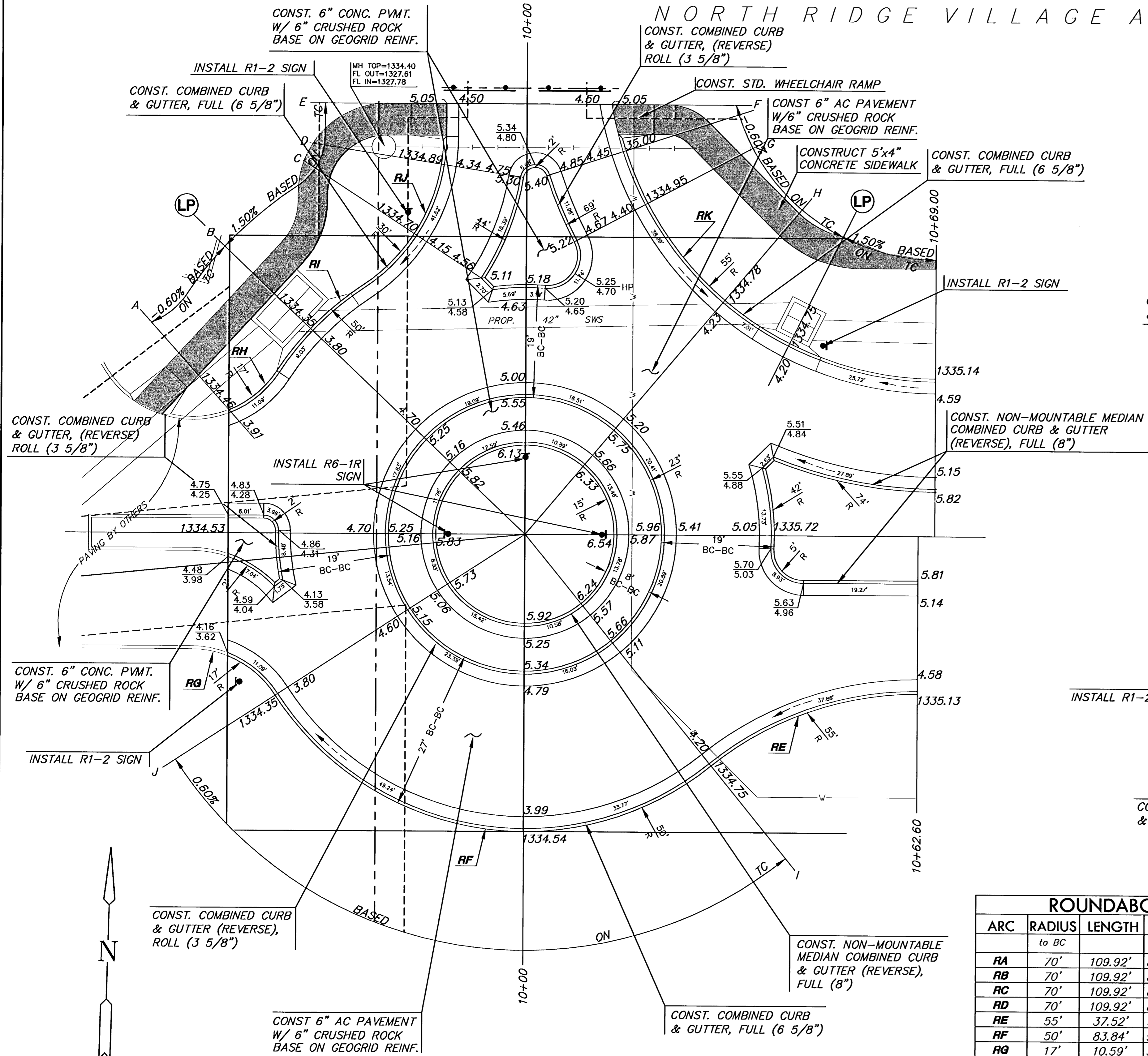

ROUNDBOUT DRIVE					
ARC	RADIUS	LENGTH	DELTA	NORTHING	EASTING
	to BC			Northing & Easting Based on Radius Point	
RA	70'	109.92'	89°58'02"	N 1711651.48	E 1621581.54
RB	70'	109.92'	89°58'08"	N 1711656.37	E 1621774.49
RC	70'	109.92'	89°58'02"	N 1711463.43	E 1621779.37
RD	70'	109.92'	89°58'08"	N 1711458.54	E 1621586.43
RE	55'	37.52'	39°05'13"	N 1711468.03	E 1621368.84
RF	50'	83.84'	96°04'39"	N 1711547.83	E 1621300.59
RG	17'	10.59'	35°40'42"	N 1711509.92	E 1621245.35
RH	17'	10.58'	35°39'42"	N 1711582.91	E 1621243.51
RI	50'	20.61'	23°36'52"	N 1711547.83	E 1621300.59
RJ	30'	29.65'	56°38'02"	N 1711613.51	E 1621254.91
RK	55'	77.19'	80°24'52"	N 1711631.05	E 1621367.51

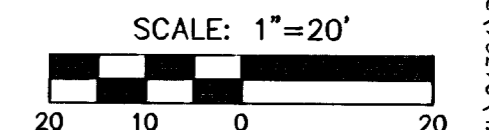
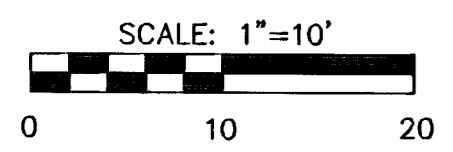

NORTH RIDGE VILLAGE ADDITION
PROJECT NAME

VILLAGE CIRCLE
SHEET TITLE

MKEC
ENGINEERING CONSULTANTS
411 N. WEBB ROAD
WICHITA, KS. 67204
316-684-9600

DESIGN BY: MAB DRAWN BY: KWS CHECKED BY: MAB/DFL

DATE: JANUARY 2006 JOB NO.: 04394 SHEET OF: 13 / 34