

BENCHMARKS:
 BM-1#
 SQUARE CUT ON TOP OF CURB 119.3'± N.
 & 6.4'± W. OF SE. COR. LOT 7, BLOCK 2,
 TURTLE RUN 3RD ADDITION.
 ELEV. = 1390.32 NAVD88

BM-2#
 SQUARE CUT ON TOP OF CURB 118.4'± N.
 OF SE. COR. LOT 6, BLOCK 2, TURTLE
 RUN 2ND ADDITION.
 ELEV. = 1391.04 NAVD88

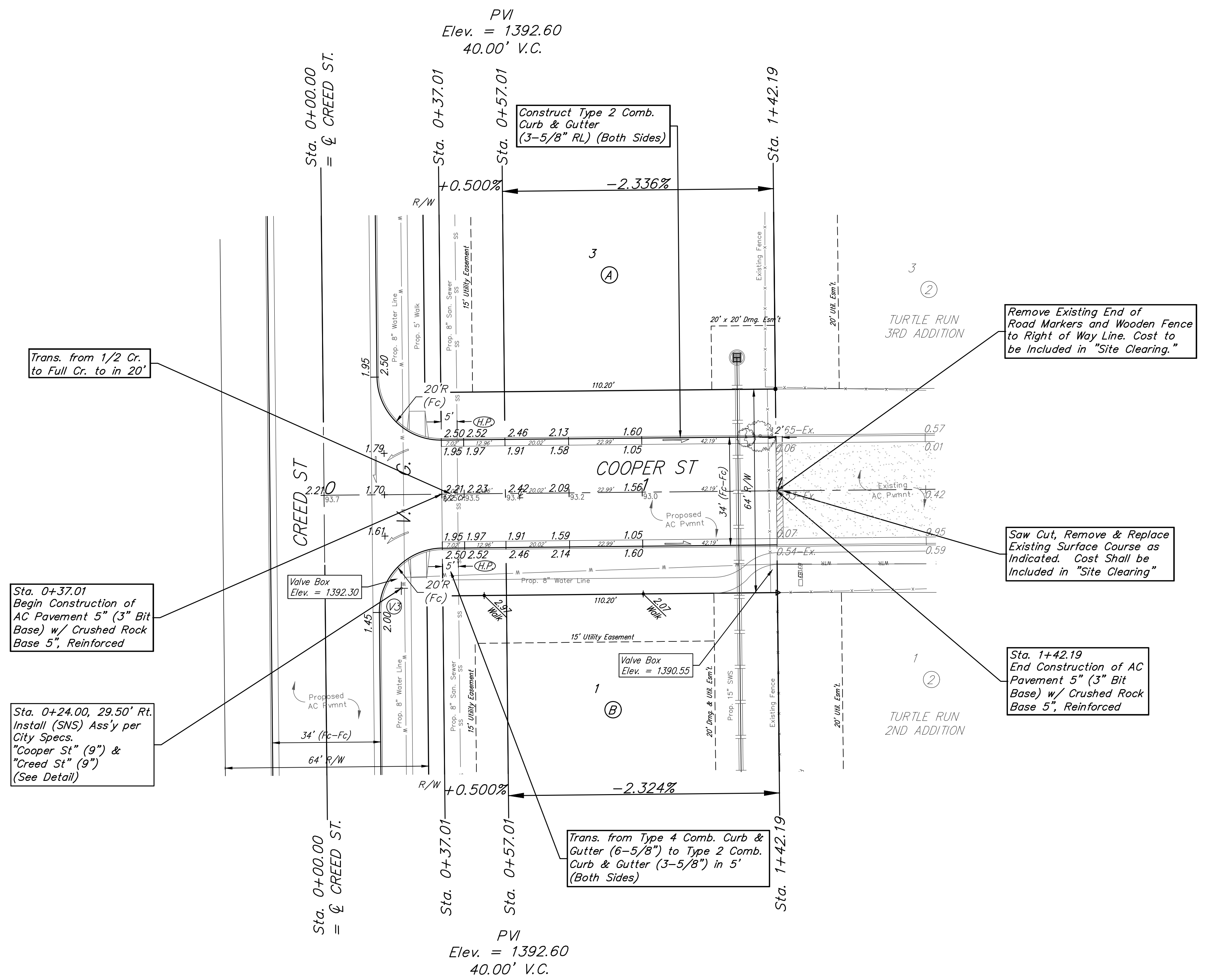
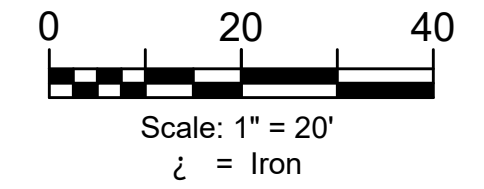

Trans. from 1/2 Cr. to Full Cr. to in 20'

Remove Existing End of Road Markers and Wooden Fence to Right of Way Line. Cost to be Included in "Site Clearing."

Sta. 0+37.01 Begin Construction of AC Pavement 5" (3" Bit Base) w/ Crushed Rock Base 5", Reinforced

Saw Cut, Remove & Replace Existing Surface Course as Indicated. Cost Shall be Included in "Site Clearing"

Sta. 0+24.00, 29.50' Rt. Install (SNS) Ass'y per City Specs. "Cooper St" (9") & "Creed St" (9") (See Detail)

Sta. 1+42.19 End Construction of AC Pavement 5" (3" Bit Base) w/ Crushed Rock Base 5", Reinforced

Trans. from Type 4 Comb. Curb & Gutter (6-5/8") to Type 2 Comb. Curb & Gutter (3-5/8") in 5' (Both Sides)

Roll type curb & gutter to be constructed on the pavement on this sheet. Top of curb elevation are given for full height curb.



BAUGHMAN COMPANY
 315 Ellis St.
 Wichita, KS 67211
 316-262-7271
 BaughmanCo.com

TOWNE PARC 10TH ADDITION PHASE 1
COOPER ST

Sta. 0+00.00 to Sta. 1+42.21
 Street Paving Improvements
 PROJECT NUMBER:
 DESIGN: NBW DRAWN: JLD
 DATE: 28 September 2023
 SHEET 19 OF 43

File: E:\Projects\Towne Parc 10th Addition_22-01-1743\Engineering\PHASE 1\STR_22-11-E355\STR.dwg