

BENCHMARKS:
 BM-1#
 SQUARE CUT ON TOP OF CURB 119.3'± N.
 & 6.4'± W. OF SE. COR. LOT 7, BLOCK 2,
 TURTLE RUN 3RD ADDITION.
 ELEV. = 1390.32 NAVD88

BM-2#
 SQUARE CUT ON TOP OF CURB 118.4'± N.
 OF SE. COR. LOT 6, BLOCK 2, TURTLE
 RUN 2ND ADDITION.
 ELEV. = 1391.04 NAVD88

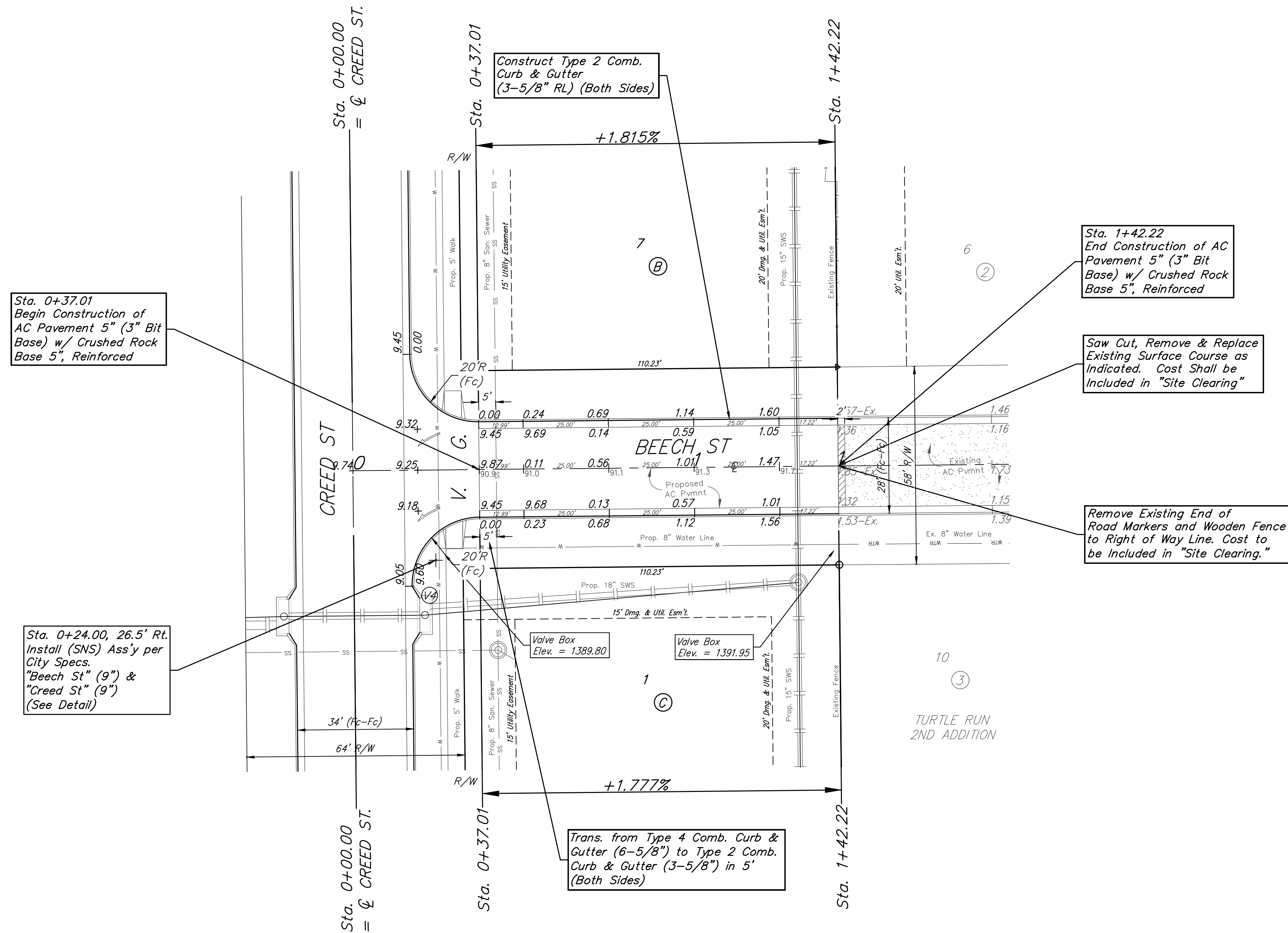
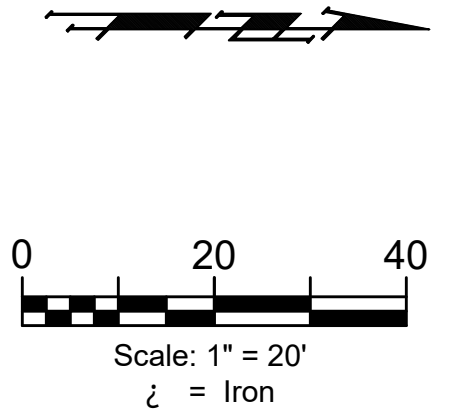

Sta. 0+37.01
 Begin Construction of
 AC Pavement 5" (3" Bit
 Base) w/ Crushed Rock
 Base 5", Reinforced

Sta. 0+24.00, 26.5' Rt.
 Install (SNS) Ass'y per
 City Specs.
 "Beech St" (9") &
 "Creed St" (9")
 (See Detail)

Construct Type 2 Comb.
 Curb & Gutter
 (3-5/8" RL) (Both Sides)

Sta. 1+42.22
 End Construction of AC
 Pavement 5" (3" Bit
 Base) w/ Crushed Rock
 Base 5", Reinforced

Saw Cut, Remove & Replace
 Existing Surface Course as
 Indicated. Cost Shall be
 Included in "Site Clearing"

Remove Existing End of
 Road Markers and Wooden Fence
 to Right of Way Line. Cost to
 be Included in "Site Clearing."

Trans. from Type 4 Comb. Curb &
 Gutter (6-5/8") to Type 2 Comb.
 Curb & Gutter (3-5/8") in 5'
 (Both Sides)



**BAUGHMAN
 COMPANY**

315 Ellis St.
 Wichita, KS 67211
 316-262-7271
 BaughmanCo.com

TOWNE PARC 10TH
 ADDITION PHASE 1

BEECH ST

Sta. 0+00.00 to Sta. 1+42.23
 Street Paving Improvements

PROJECT NUMBER:
 DESIGN: NBW DRAWN: JLD
 DATE: 28 September 2023

SHEET **20** OF **43**

Roll type curb & gutter to
 be constructed on the pavement
 on this sheet.
 Top of curb elevation are given
 for full height curb.

File: E:\Projects\Towne Parc 10th Addition_22-01-P743\Engineering\PHASE 1\STR_22-11-E355\STR.dwg