

**BENCHMARK:**  
 BM #1: "□" Cut in middle of N headwall of RCBC on 21st St. North. 1004.3' W & 22.1' N of SE Cor., SE 1/4, Sec. 2, T-27-S, R-2-E. Elev. = 173.23 City Datum

BM #2: "□" Cut at the SE corner of the intersection of Castle Rock & Castle Rock Ct., Krug North Addition. Elev. = 183.50 City Datum

Saw, cut, remove and replace 2" existing pavement as shown. To be incidental to "Site Clearing & Restoration".

Sta 0+23.03, Begin construction of 5" A.C. pvmt. W/5" reinf. rock base and 4' sidewalk.

Sta 0+25.03, 4' Lt.&Rt. Remove type 1 barricade w/ E.O.R. marker for salvage by the City of Wichita.

Manhole Top Elev. = 192.60

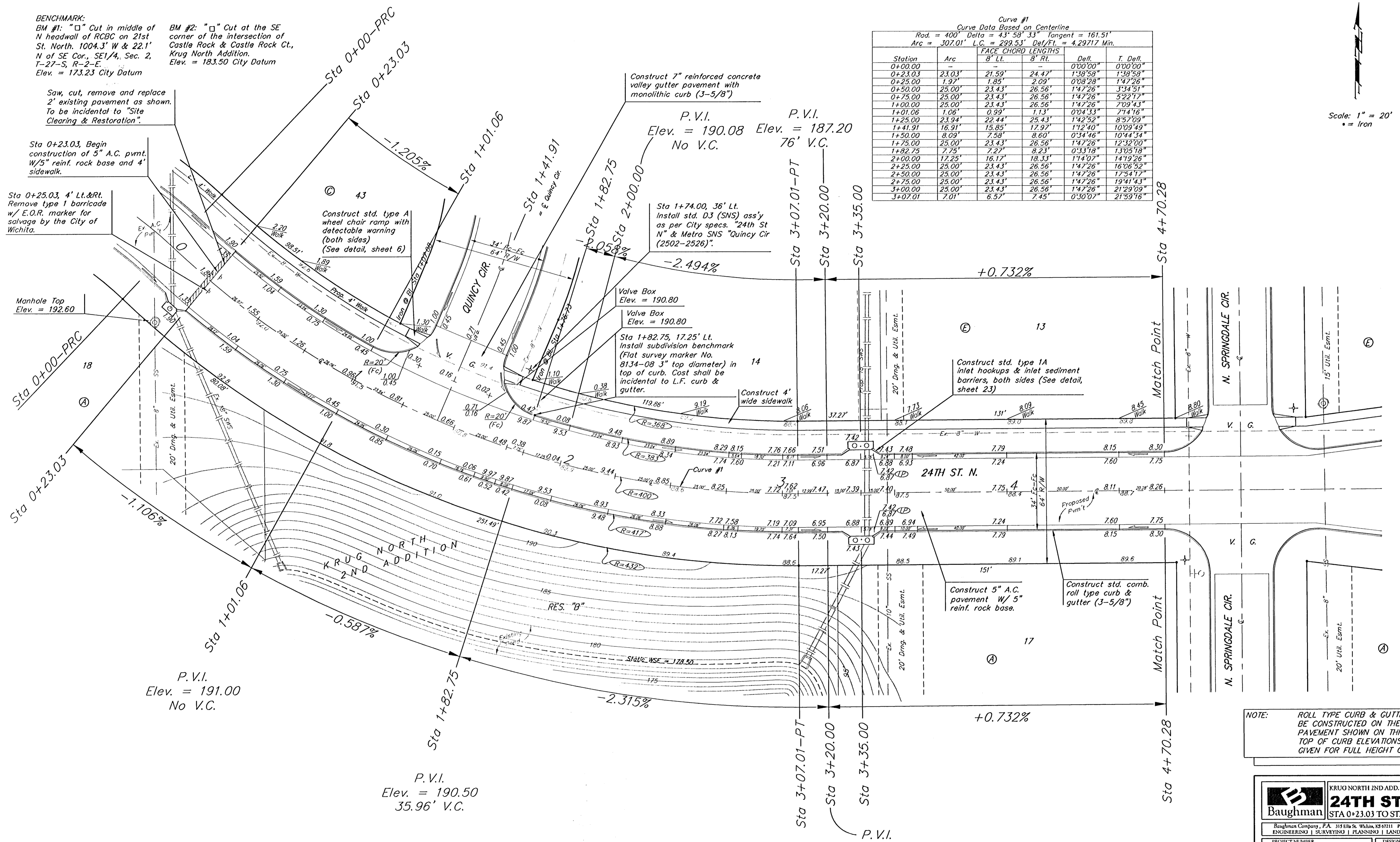

Curve #1  
 Curve Data Based on Centerline  
 Rad. = 400' Delta = 43° 58' 33" Tangent = 161.51'  
 Arc = 307.01' L.C. = 299.53' Del./Ft. = 4.29717 Min.

Station	Arc	FACE CHORD LENGTHS		Defl.	T. Defl.
		8' Lt.	8' Rt.		
0+00.00	-	-	-	0°00'00"	0°00'00"
0+23.03	23.03'	21.59'	24.47'	1°38'58"	1°38'58"
0+25.00	1.97'	1.85'	2.09'	0°08'28"	1°47'26"
0+50.00	25.00'	23.43'	26.56'	1°47'26"	3°34'51"
0+75.00	25.00'	23.43'	26.56'	1°47'26"	5°22'17"
1+00.00	25.00'	23.43'	26.56'	1°47'26"	7°09'43"
1+01.06	1.06'	0.99'	1.13'	0°04'33"	7°14'16"
1+25.00	23.94'	22.44'	25.43'	1°42'52"	8°57'09"
1+41.91	16.91'	15.85'	17.97'	1°12'40"	10°09'49"
1+50.00	8.09'	7.58'	8.60'	0°34'46"	10°44'34"
1+75.00	25.00'	23.43'	26.56'	1°47'26"	12°32'00"
1+82.75	7.75'	7.27'	8.23'	0°33'18"	13°05'18"
2+00.00	17.25'	16.17'	18.33'	1°14'07"	14°19'26"
2+25.00	25.00'	23.43'	26.56'	1°47'26"	16°06'52"
2+50.00	25.00'	23.43'	26.56'	1°47'26"	17°54'17"
2+75.00	25.00'	23.43'	26.56'	1°47'26"	19°41'43"
3+00.00	25.00'	23.43'	26.56'	1°47'26"	21°29'09"
3+07.01	7.01'	6.57'	7.45'	0°30'07"	21°59'16"

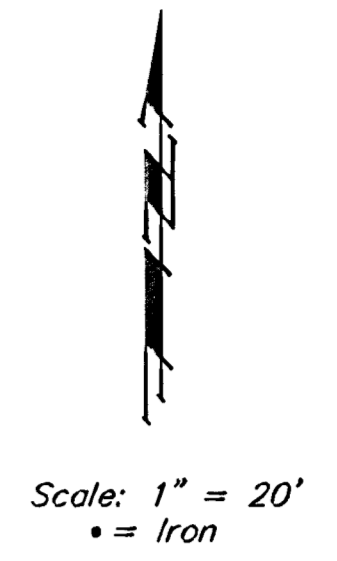

P.V.I.  
 Elev. = 191.00  
 No V.C.

P.V.I.  
 Elev. = 190.50  
 35.96' V.C.

P.V.I.  
 Elev. = 187.20  
 80' V.C.

NOTE: ROLL TYPE CURB & GUTTER TO BE CONSTRUCTED ON THE PAVEMENT SHOWN ON THIS SHEET. TOP OF CURB ELEVATIONS ARE GIVEN FOR FULL HEIGHT CURB.

**Baughman** KRUG NORTH 2ND ADD. - PH. IV  
**24TH ST. N.**  
 STA 0+23.03 TO STA 4+70.28

Baughman Company, P.A. 315 Ellis St. Wichita, KS 67211 P.316.262.7171 F.316.262.0149  
 ENGINEERING | SURVEYING | PLANNING | LANDSCAPE ARCHITECTURE

PROJECT NUMBER 472-84250	DESIGN ATD	DRAWN TMS
REVISIONS:	APPROVED	DATE 04/06
	SCALE Noted	
	SHEET	<b>7 OF 35</b>

KrugNorth2ndPhaseV5.rvt 05-12-04