

**BENCHMARK:**  
 BM #1: "□" Cut in middle of N headwall of RCBC on 21st St. North, 1004.3' W & 22.1' N of SE Cor., SE 1/4, Sec. 2, T-27-S, R-2-E. Elev. = 173.23 City Datum  
 BM #2: "□" Cut at the SE corner of the intersection of Castle Rock & Castle Rock Ct., Krug North Addition. Elev. = 183.50 City Datum

Scale: 1" = 20'  
 • = Iron

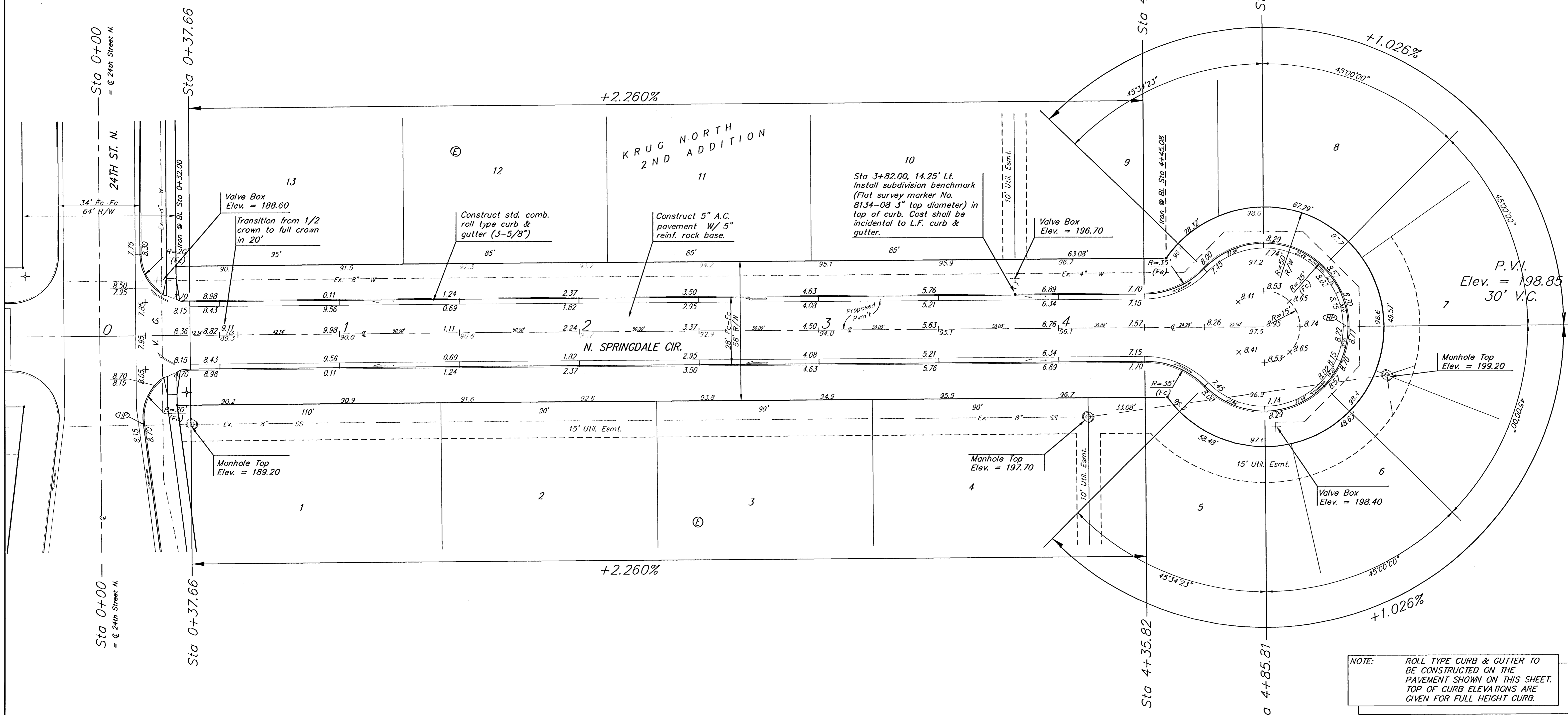

NOTE: ROLL TYPE CURB & GUTTER TO BE CONSTRUCTED ON THE PAVEMENT SHOWN ON THIS SHEET. TOP OF CURB ELEVATIONS ARE GIVEN FOR FULL HEIGHT CURB.

	KRUG NORTH 2ND ADD. - PH. IV <b>N. SPRINGDALE CIR.</b> STA 0+00 TO STA 4+85.81	
	Baughman Company, P.A. 315 Ella St. Wilkes, KS 67111 P 316-263-7211 F 316-263-0149 ENGINEERING   SURVEYING   PLANNING   LANDSCAPE ARCHITECTURE	
PROJECT NUMBER 472-84250	DESIGN ATD	DRAWN TMS
REVISIONS:	APPROVED DATE 04/06	SCALE Noted SHEET <b>13 OF 35</b>
KrugNorth2ndVPhaseIVS7		05-12-E-449