

Scale: 1" = 20'
● = Iron

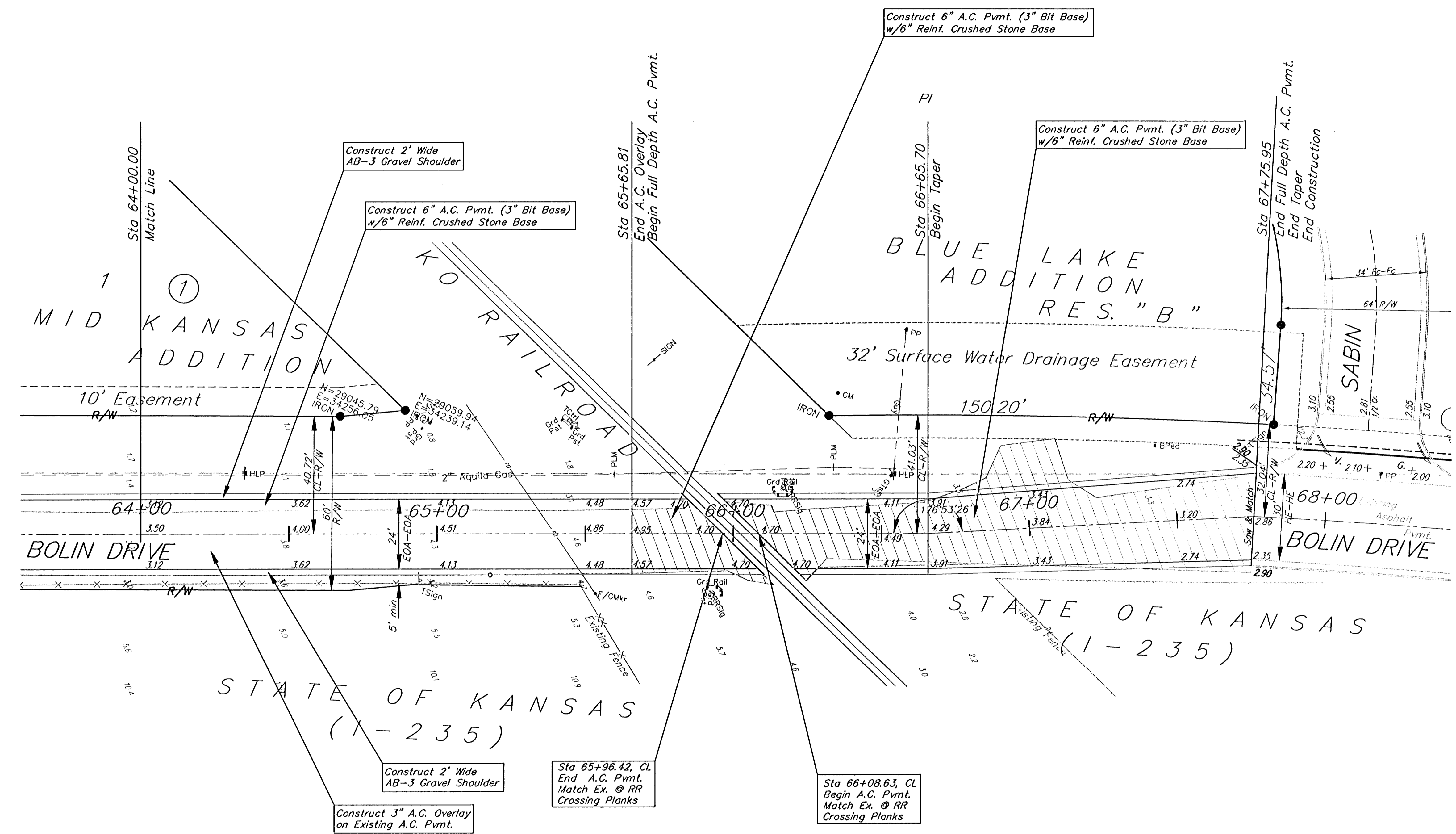

STATE OF KANSAS
(1-235)

STATE OF KANSAS
(1-235)

Note: Contractor shall contact Neil Jacobs with the K.O. Railroad at 263-3240 (Ext. 172) at least 24 hrs prior to construction in RR Right-of-way.

Note:
Pavement, Sidewalks, and Etc. To Be Removed Are Indicated By:

| | | | |
|---|---------------|--|-------|
| | | BLUE LAKE ADDITION Bolin Drive Street Improvements | |
| <small>Baughman Company, P.A. 118 Ellis St., Wichita, KS 67211 P 316/262-7771 F 316/262-0149 ENGINEERING SURVEYING PLANNING LANDSCAPE ARCHITECTURE</small> | | | |
| PROJECT NUMBER 472-84078 | DESIGN KK | DRAWN TCA | |
| APPROVED JFB | DATE 04/06 | SCALE Noted | SHEET |
| REVISIONS: | | | |
| | | 7 OF 18 | |
| <small>E:\eng\Bolin Drive - Blue Lake Add\Bolin1_base.mxd.dwg</small> | | | |