

Benchmarks:

"□" Cut Top of Curb North End of Northwest Return at Highland Springs & Hardner Elev. = 178.72 (City Datum)

"□" Cut Top of Curb West Side of Kentucky Lane ±20' South of End of Existing pavement. Elev. = 182.16 (City Datum)

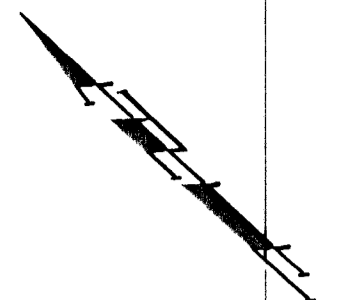

Scale: 1" = 20'
• = Iron

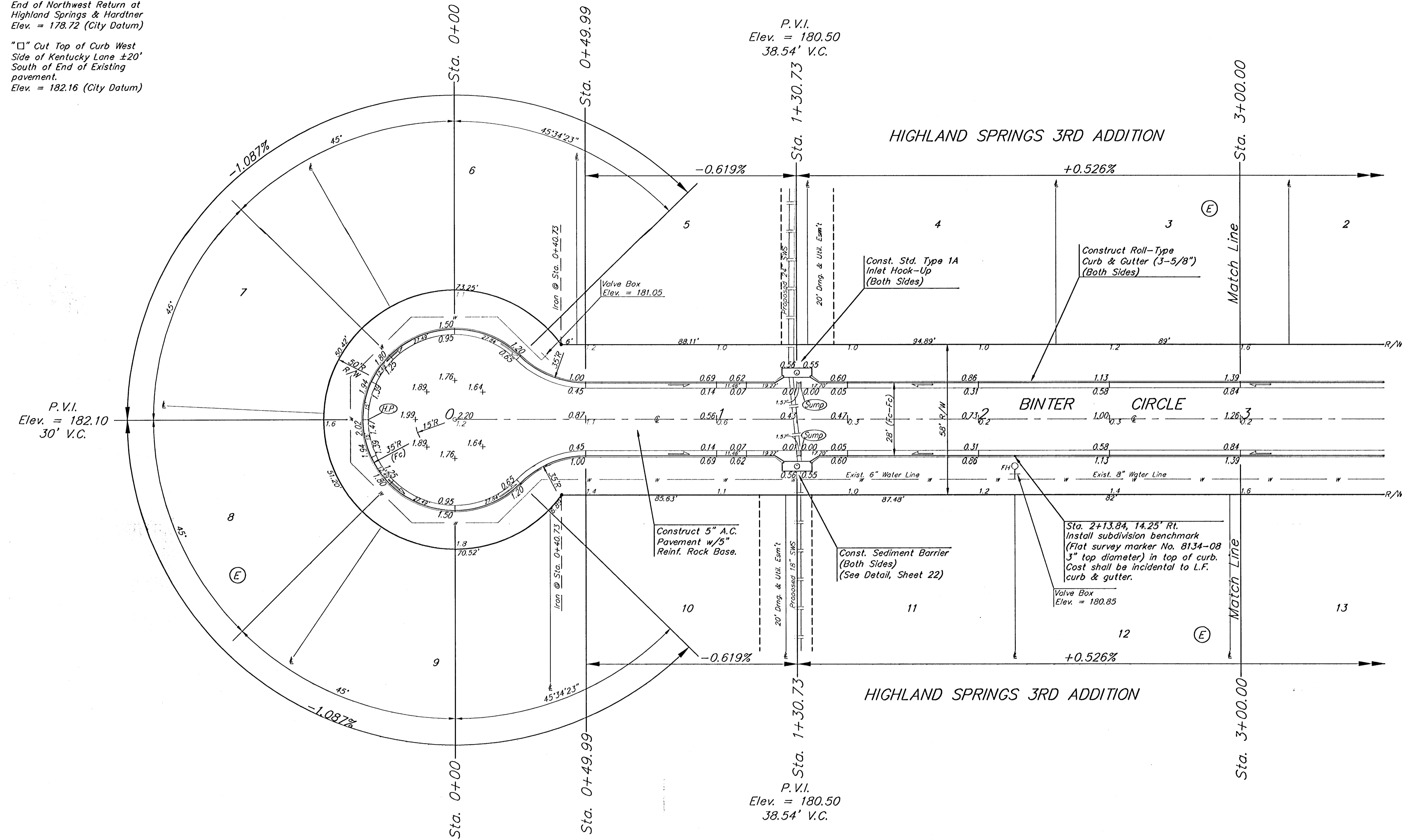

Subdivision Benchmarks

Street & Station	Location Description	Elevation
Hardner 5+43.17, 17.25' Rt.	Adjacent to Fire Hydrant near common lot corner of Lots 2 & 3, Block G	
Hardner Ct. 4+85.12, 14.25' Rt.	Adjacent to Fire Hydrant near common lot corner of Lots 7 & 8, Block F	
Binter Cir. 15+71.07, 17.25' Lt.	Adjacent to Fire Hydrant near common lot corner of Lots 11 & 12, Block E	

	Highland Springs 3rd Addition - Phase III	
	BINTER CIR.	
STA. 0+00 - STA. 3+00		
Baughman Company, P.A. 315 Ellis St. Wichita, KS 67211 F31626/771 F31626/049 ENGINEERING SURVEYING PLANNING LANDSCAPE ARCHITECTURE		
PROJECT NUMBER 472-83780	DESIGN NBW/JAK	DRAWN TMS/JAK
REVISIONS:	APPROVED	DATE 6/21/06
	SCALE Noted	
	SHEET	11 OF 31
F:\Eng\Highland Springs 3rd\Phase 3\Set5		05-09-E358