

Benchmarks:

"□" Cut Top of Curb North End of Northwest Return at Highland Springs & Hardtner Elev. = 178.72 (City Datum)

"□" Cut Top of Curb West Side of Kentucky Lane ±20' South of End of Existing pavement. Elev. = 182.16 (City Datum)

HIGHLAND SPRINGS 3RD ADDITION

Scale: 1" = 20'
• = Iron

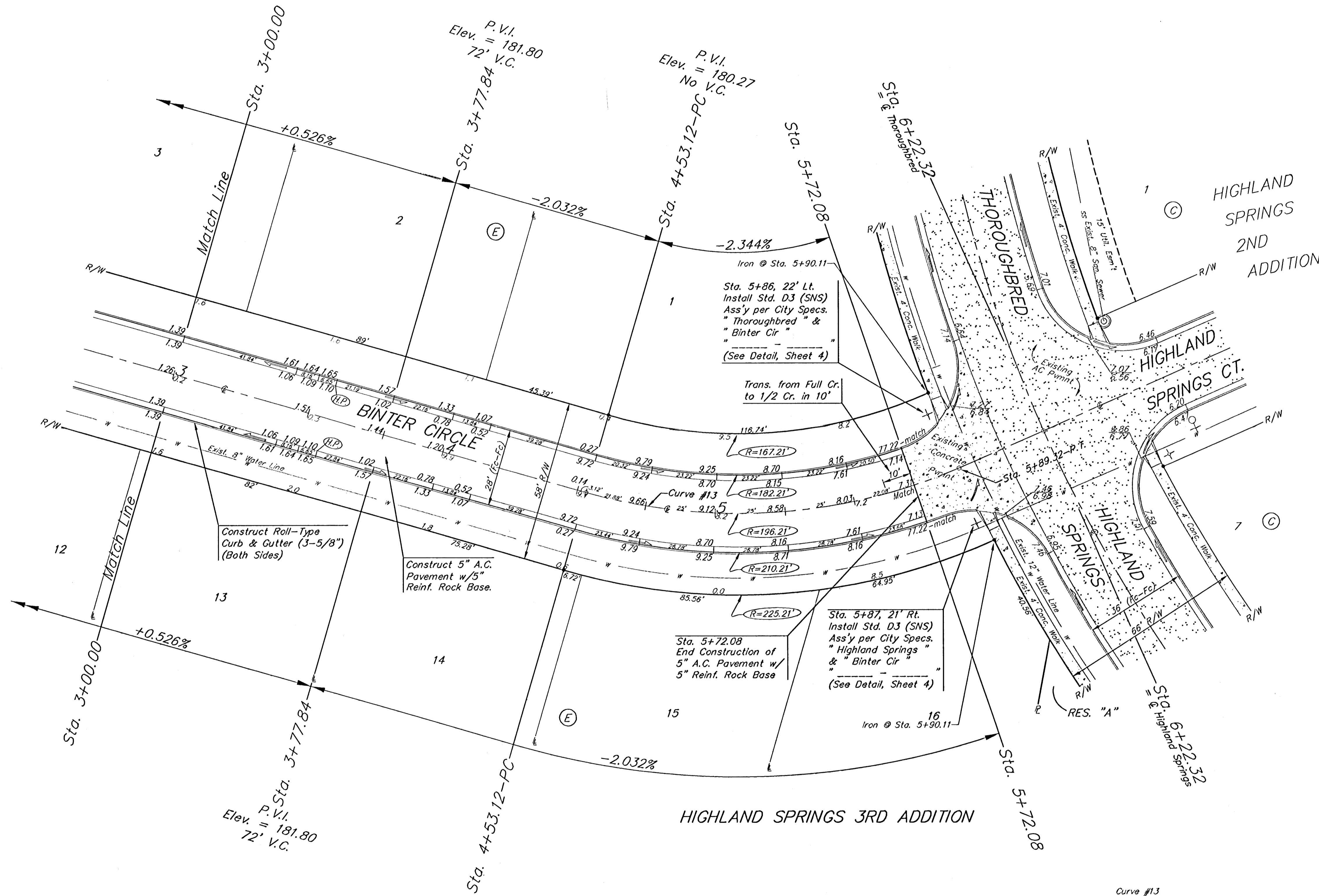

HIGHLAND SPRINGS 3RD ADDITION

Roll type curb & gutter to be constructed on the pavement on this sheet. Top of curb elevation are given for full height curb.

Curve #13
Curve Data Based on Centerline
Rad. = 196.21' Delta = 39° 46' 18" Tangent = 70.97'
Arc = 136.20' L.C. = 133.48' Del/Ft. = 8.76028 Min.

Station	Arc	FACE CHORD LENGTHS		Defl.	T. Defl.
		8" Lt.	8" Rt.		
4+53.12	-	-	-	0°00'00"	0°00'00"
4+75.00	21.88'	19.42'	24.32'	3°11'40"	3°11'40"
5+00.00	25.00'	22.18'	27.78'	3°39'01"	6°50'41"
5+25.00	25.00'	22.18'	27.78'	3°39'00"	10°29'41"
5+50.00	25.00'	22.18'	27.78'	3°39'01"	14°08'42"
5+75.00	22.08'	19.59'	24.54'	3°13'25"	17°22'07"
5+75.00	2.92'	2.92'	3.25'	0°25'35"	17°47'42"
5+89.32	14.32'	12.71'	15.92'	2°05'22"	19°53'09"

highland Springs 3rd Addition - Phase III
BINTER CIR.
STA. 3+00 - STA. 5+72.08

Baughman Engineering & Surveying, P.A. 315 Ellis St. Wichita, KS 67211 F 316-267-7111 F 316-262-2149
ENGINEERING | SURVEYING | PLANNING | LANDSCAPE ARCHITECTURE

PROJECT NUMBER: 472-83180
DESIGN: NBW/JAK
DRAWN: TMS/JAK
APPROVED: [Signature]
DATE: 6/21/06

REVISIONS: [Table]
SCALE: Noted
SHEET: 12 OF 32

F:\Eng\Highland Springs 3rd\Phase 3\Str6 05-09-E358