

WOODLAND LAKES ESTATES
THIRD ADDITION

CURVE TABLE C1					
$\Delta = 59^{\circ}47'00''$ R = 200.00' T = 114.97' L = 208.68' LC = 199.34'					
CURVE DATA BASED ON CENTERLINE $\Delta / 2 = 29^{\circ}53'30''$					
CHORD LENGTH					
STATION	ARC	8'off LICB	8'off RICB	DEFLECTION	TOTAL DEFLECTION
25+42.50	-	-	-	00'00"00"	00'00"00"
25+50.00	7.50'	8.44'	6.56'	01'04"27"	01'04"27"
25+75.00	25.00'	28.11'	21.86'	03'34"52"	04'39"19"
26+00.00	25.00'	28.11'	21.86'	03'34"52"	08'14"11"
26+25.00	25.00'	28.11'	21.86'	03'34"52"	11'49"02"
26+50.00	25.00'	28.11'	21.86'	03'34"52"	15'23'54"
26+75.00	25.00'	28.11'	21.86'	03'34"52"	18'58'45"
27+00.00	25.00'	28.11'	21.86'	03'34"52"	22'33'37"
27+25.00	25.00'	28.11'	21.86'	03'34"52"	26'08'28"
27+50.00	25.00'	28.11'	21.86'	03'34"52"	29'43'20"
27+51.18	1.18'	1.33'	1.04'	00'10"10"	29'53'30"
Def/Ft = 8.59437 Min.					

MKEC
ENGINEERING
CONSULTANTS, INC.
411 N. WEBB ROAD
WICHITA, KS. 67206
316-684-9600

PAVING AND INCIDENTAL DRAINAGE
WOODLAND LAKES 3RD & 4TH
ZIMMERLY PHASE

ZIMMERLY ST.
SHEET TITLE
472-83718
PROJECT NUMBER

SRS
DESIGN BY
DM/SMB
DRAWN BY
GJA
CHECKED BY

ISSUED
AUGUST 2006
REVISED

SHEET NO.
8 of 36

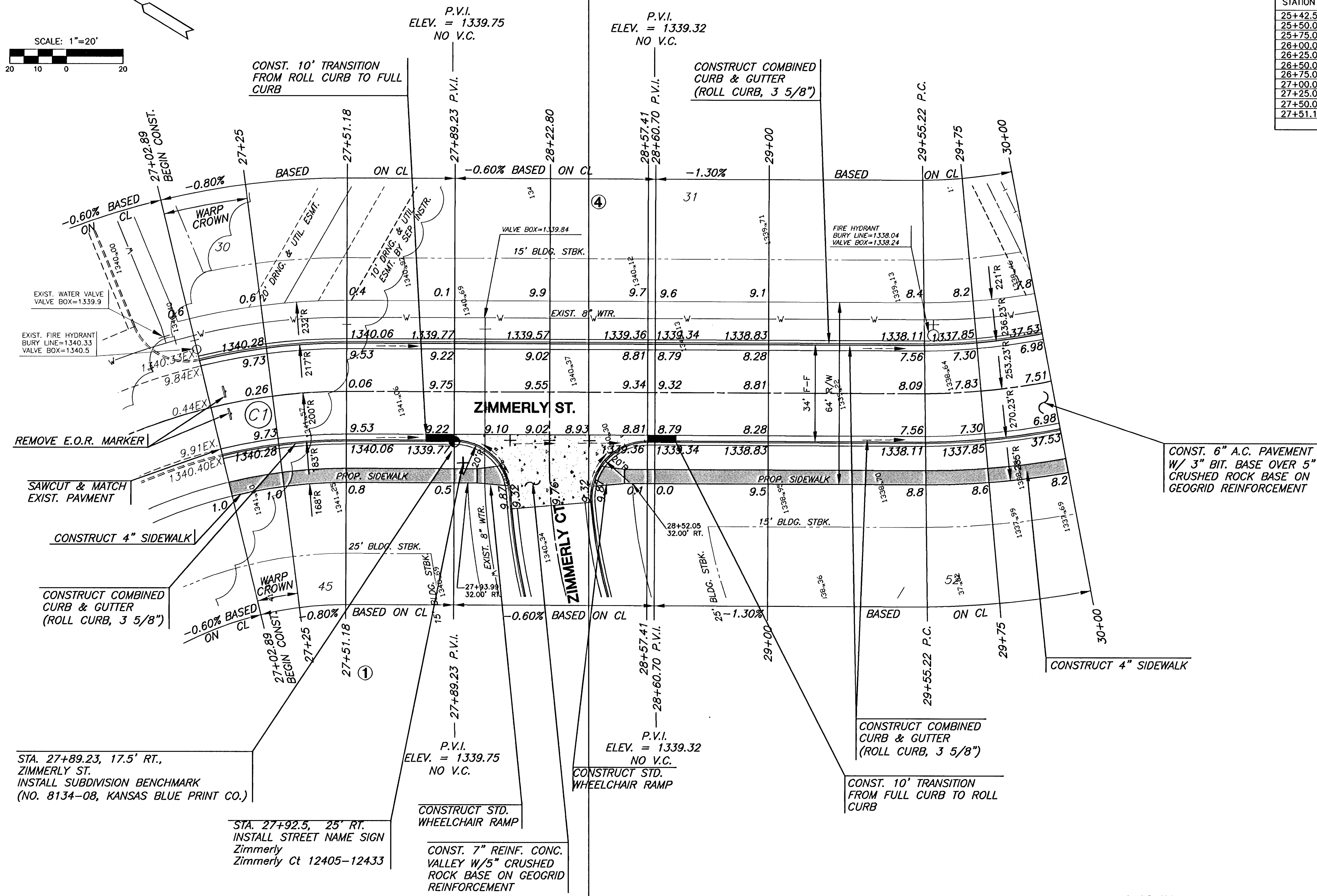

WOODLAND LAKES ESTATES
FOURTH ADDITION

LEGEND
+ STREET SIGN & SIGN LOCATION
(SEE SIGN ASSEMBLY TABLE
FOR TYPE & STATION OF SIGN)
[Symbol] = VALLEY GUTTER

NO.	STREET AND STATION	FROM CL	DESCRIPTION	ELEVATIONS
1	ZIMMERLY ST., STA. 27+89.23	17.5' RT.	TOP OF CURB AT END OF RETURN, ZIMMERLY ST.	

NOTE: CONTRACTOR SHALL INSTALL SUBDIVISION BENCH MARKS ("FLAT SURVEY MARKERS NO. 8134-08 3" TOP DIAMETER" PROVIDED BY KANSAS BLUE PRINT CO., INC.) COSTS TO BE CONSIDERED SUBSIDIARY TO CONSTRUCTION OF COMBINED CURB AND GUTTER.

- NOTE:
- TOP OF CURB ELEVATIONS SHOWN ARE FOR FULL CURB. CONSTRUCT CURB AS NOTED.
 - CONTRACTOR SHALL REMOVE ALL TREES WITHIN ROAD RIGHT-OF-WAY.