

STA 0+06.93 LINE 2
CONNECT TO TYPE P STD. MH BY OTHERS
PROJ# 468-84026
TOP ELEV. = 1344.30

STA 0+25 LINE 2
SERVICE RISER ASSEMBLY
L=13.0'

STA 0+80 LINE 2
SERVICE RISER ASSEMBLY
L=13.0'

STA 1+65 LINE 2
SERVICE RISER ASSEMBLY
L=13.0'

STA 2+29.37 LINE 2
CONSTRUCT STD. TYPE P MH
TOP ELEV. = 1350.70

STA 2+92.31 LINE 2
CONSTRUCT STD. TYPE P MH
TOP ELEV. = 1350.60

STA 2+41 TO STA 2+79
INSTALL 38 L.F. FLOWABLE FILL

STA 0+64.50 LINE 2A
CONSTRUCT STD. TYPE P MH
TOP ELEV. = 1351.0

STA 5+50.82 LINE 2
CONSTRUCT STD. TYPE P MH
TOP ELEV. = 1350.50

STA 8+14.32 LINE 2
CONSTRUCT STD. TYPE P MH
W/ 8" PVC STUB NE, L=10'
TOP ELEV. = 1354.70

STA 8+96.32 LINE 2
CONSTRUCT STD. TYPE P MH
TOP ELEV. = 1356.00

SEWER SERVICE TABLE

Number	Type	Location				For Information Only	
		Lot No.	Block No.	Line No.	Station Direction	Approximate length 4" pipe Vertical	Horizontal
1	8" x 1" Tee Saddle	4	3	2	0+25, Rt.		13.0'
2	8" x 1" Tee Saddle	5	3	2	0+80, Rt.		13.0'
3	8" x 1" Tee Saddle	10	3	2	1+65, Rt.		13.0'

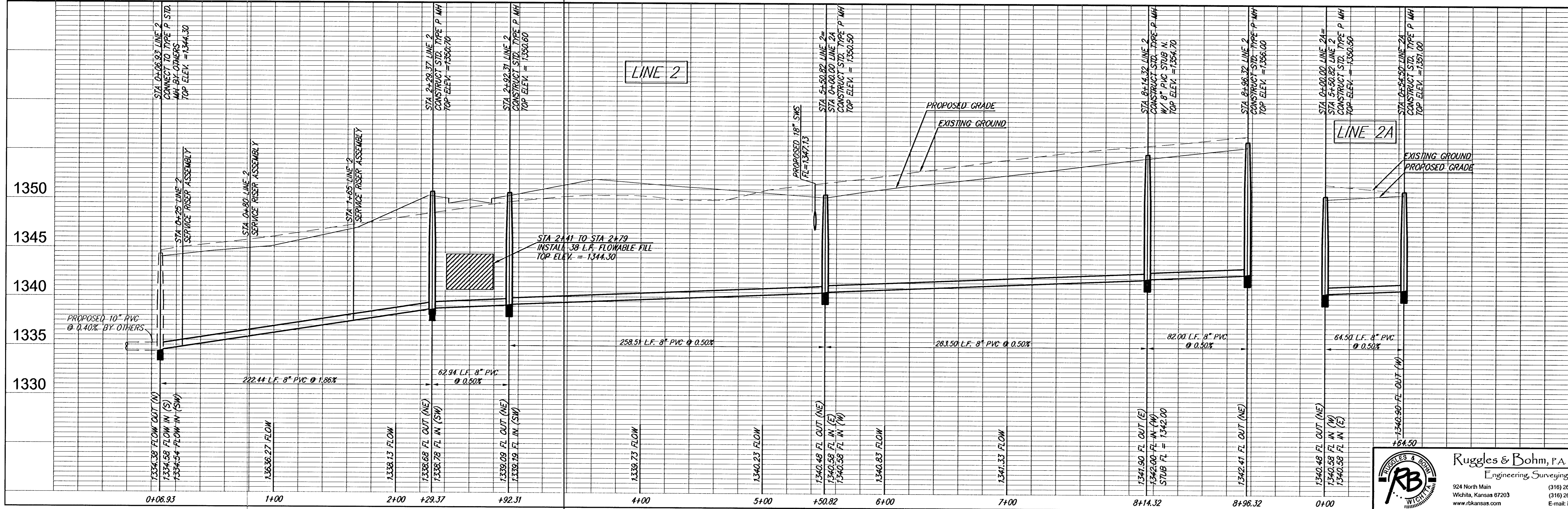
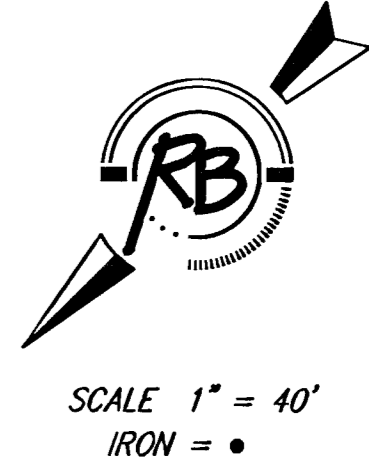

PROJECT NUMBER 468-84072	DESIGN AML UTILITY	DRAWN AML DATE Oct. 17, 2005	REVISION REVIEW
DRAWING FILE Sanitary Sewer (SS 02)			
Casa Bella Addition Sanitary Sewer WICHITA, KANSAS			
PROJECT NUMBER 468-84072	DESIGN AML UTILITY	DRAWN AML DATE Oct. 17, 2005	REVISION REVIEW