

**TRANSYSTEMS**  
 245 N. WACO  
 SUITE 222  
 WICHITA, KANSAS 67202  
 MAIN: 316-303-3000  
 FAX: 316-462-5629



CONSULTANTS:  
**WEST STREET IMPROVEMENTS FROM PAWNEE TO HARRY**

WICHITA, KANSAS  
**CITY OF WICHITA**

REVISIONS:	MARK	DATE	DESCRIPTION

PROJ NO: 87 N-0720-01  
 SCALE: 1"=20'  
 DATE: 9/25/2023  
 DESIGNED BY: DAN  
 DRAWN BY: DAN  
 CHECKED BY: MDB

SHEET TITLE:  
**PAWNEE ST. WATERLINE IMPROVEMENTS**

SHEET NO.  
**385**  
 SHEET 385 OF 517

432 @ Sta. 1078+84.86, 94.82', Lt. =  
 Sta. 311+23.77, Waterline 1 =  
 Sta. 400+00.00, Waterline 2  
 Connect to 12" Valve (E) installed with Waterline 1  
 Install 15.00 LF 12" Pipe (E)  
 N 1,673,001.5240  
 E 1,634,202.3157

733 @ Sta. 1078+99.75, 93.00', Lt. =  
 Sta. 400+15.00, Waterline 2  
 7.0° Horiz. PI  
 Install 196.71 LF 12" Pipe (E)  
 N 1,673,001.7962  
 E 1,634,217.3132

AT & SF Railway Company  
 ?  
 Wichita, KS 67213  
 52

734 @ Sta. 1080+96.46, 93.00', Lt. =  
 Sta. 402+11.71, Waterline 2  
 1.0° Horiz. PI  
 Install 171.85 LF 12" Pipe (E)  
 N 1,673,029.2442  
 E 1,634,412.1022

City of Wichita  
 3800 W. Pawnee Ave.  
 Wichita, KS 67213

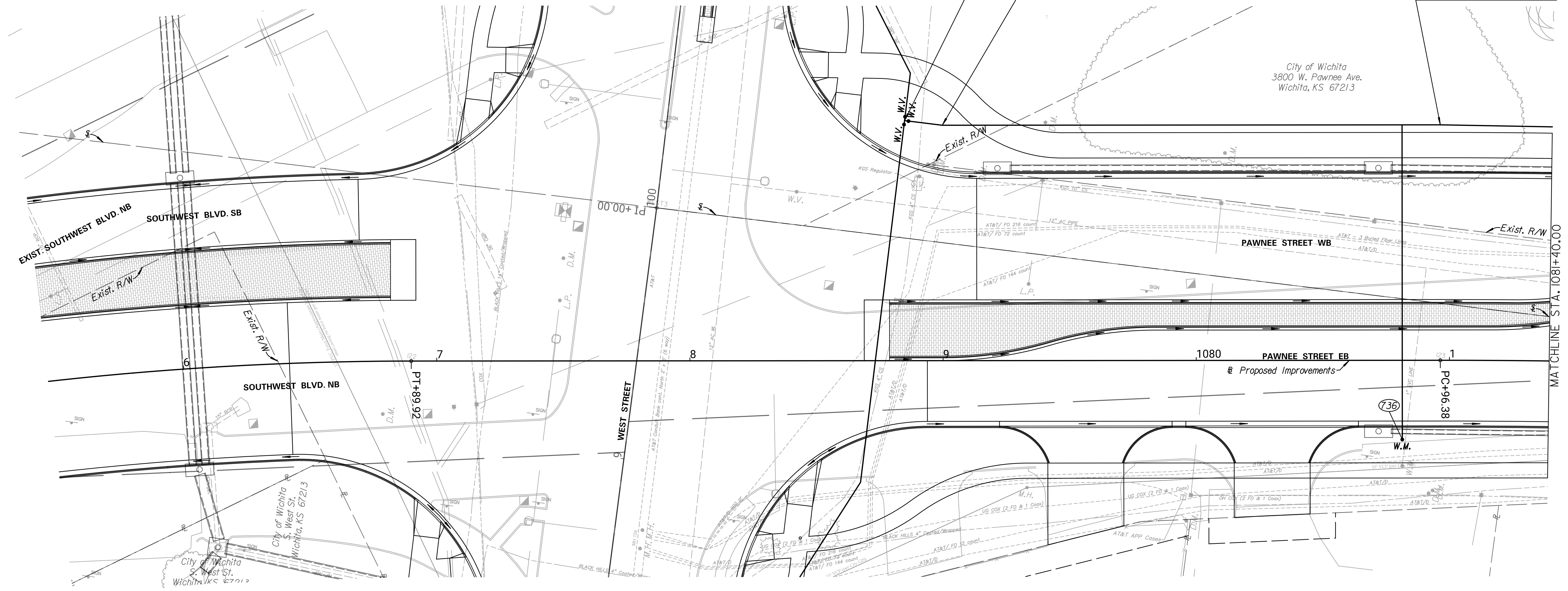

9/25/2023 4:52 PM - c:\transystems\proj\local\transystems\proj\1a-e\_kochas\0984549-C-VTR-M02-10.LDGN