

BENCHMARKS:

BM #1: C.O.W. disc at SW corner of intersection.
 30.00'± S. of CL of 13th St. N.
 35.00'± W. of CL of 135th St. W.
 Elev. = 168.25 City Datum

BM #2: Small RR spike in 4th HLP
 W. of 135th St. W. on south side
 of 13th St. N. (N. face of HLP).
 Elev. = 179.24 City Datum

BM #3: RR spike in Power Pole.
 1321.65 W. of 135th St. W. 30' N.
 of 13th St. N.
 Elev. = 178.45 City Datum

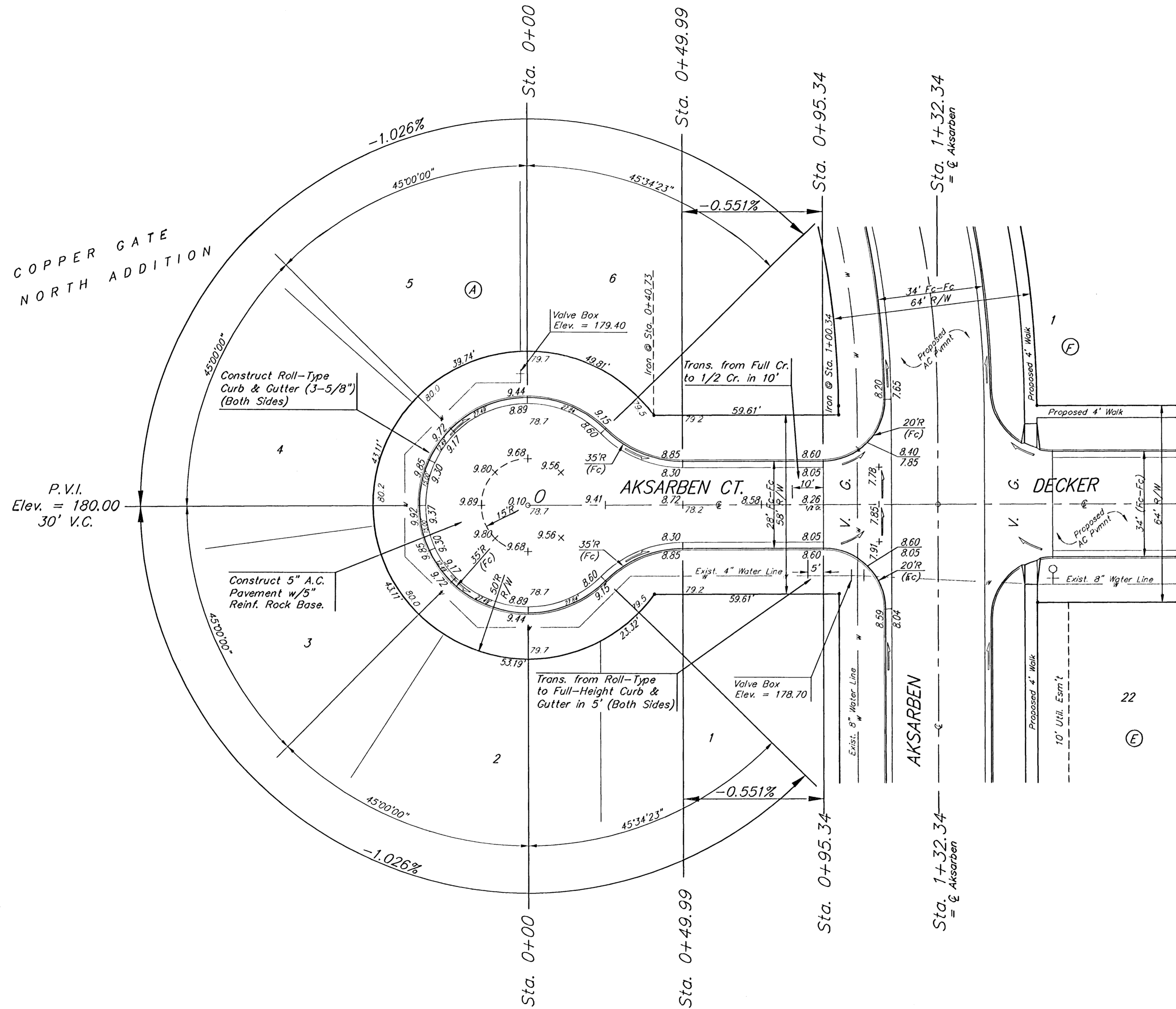
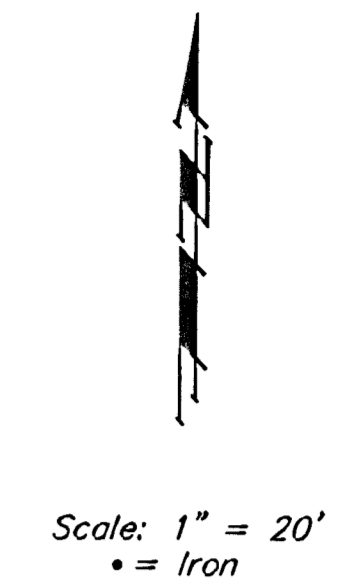

NOTE: ROLL TYPE CURB & GUTTER TO BE CONSTRUCTED ON THE PAVEMENT SHOWN ON THIS SHEET. TOP OF CURB ELEVATIONS ARE GIVEN FOR FULL HEIGHT CURB.

		Copper Gate North Addition - Phase I	
		AKSARBEN CT. LOT 1 - LOT 6, BLOCK A	
Baughman Company, P.A. 315 Ella St. Wichita, KS 67211 P 3162627211 F 3162620149 ENGINEERING SURVEYING PLANNING LANDSCAPE ARCHITECTURE			
PROJECT NUMBER 472-84104	DESIGN NBW	DRAWN TMS/JAK	DATE 10/05/05
REVISIONS:	SCALE Noted SHEET		
			13 OF 28
CopperGateNorth/Sub8		05-02-E162	