

EROSION CONTROL MEASURE	UNITS	QUANTITY
SILT FENCE	L.F.	200
RIPRAP	S.Y.	106
DROP INLET BARRIER	EA.	0
CURB INLET BARRIER	EA.	0
STRAW BALE DITCH CHECK	EA.	3
EARTHEN DIKES	L.F.	0
EROSION CONTROL BLANKET	S.Y.	1280
POND E.C. BLANKET	S.Y.	0
Construction Entrance	EA.	2

QUANTITIES ARE FOR INFORMATION ONLY
CONTRACTOR SHALL VERIFY QUANTITIES PER
SPECIFIC ENGINEERING PLAN SHEET.

The Contractor shall have the option of replacing the three (3) T-Posts with one (1) Fiberglass Marking Post (Green) as supplied by In Stock Now! Inc. (888) 547-4477, or approved equal. Cost of the T-Posts or Fiberglass Marker shall not be paid for directly, but shall be considered **INCIDENTAL** to the Manhole Construction.

JOHN E. DUGAN FAMILY PARTNERSHIP, L.P.
AT-196
2416 MORNING DEW
WICHITA, KS 67205

N-29109.06, E-28415.08
Sta. 74+63.94, SS Line 1
Match Point

Install 40 L.F. Concrete Encasement with Cut-off Wall From Sta. 74+93 to Sta. 75+33. See Detail, This Sheet.

Install 50 L.F. Silt Fence on Each Side of the Creek and Install 675 S.Y. North American Green Erosion Control Blanket, or approved equal, Through Creek Crossing. Cost to be **INCIDENTAL** to "Erosion Control".

TURKEY CREEK ADDITION

RESERVE "A"

Install 3 T-Posts (Green) Around Manhole

35' Sanitary Sewer Easement

SE 1/4, Section 36, Twp 27-S, R 2-W

N-28945.23, E-28674.54
Sta. 77+70.80, End SS Line 1
Construct Std. Type "12" Manhole (4' Dia.), Install 2-10" Stubs (S & NE) and Plug.
Top Elev. = 1330.00

SCALE:
1" = 40' HORIZONTAL
1" = 5' VERTICAL

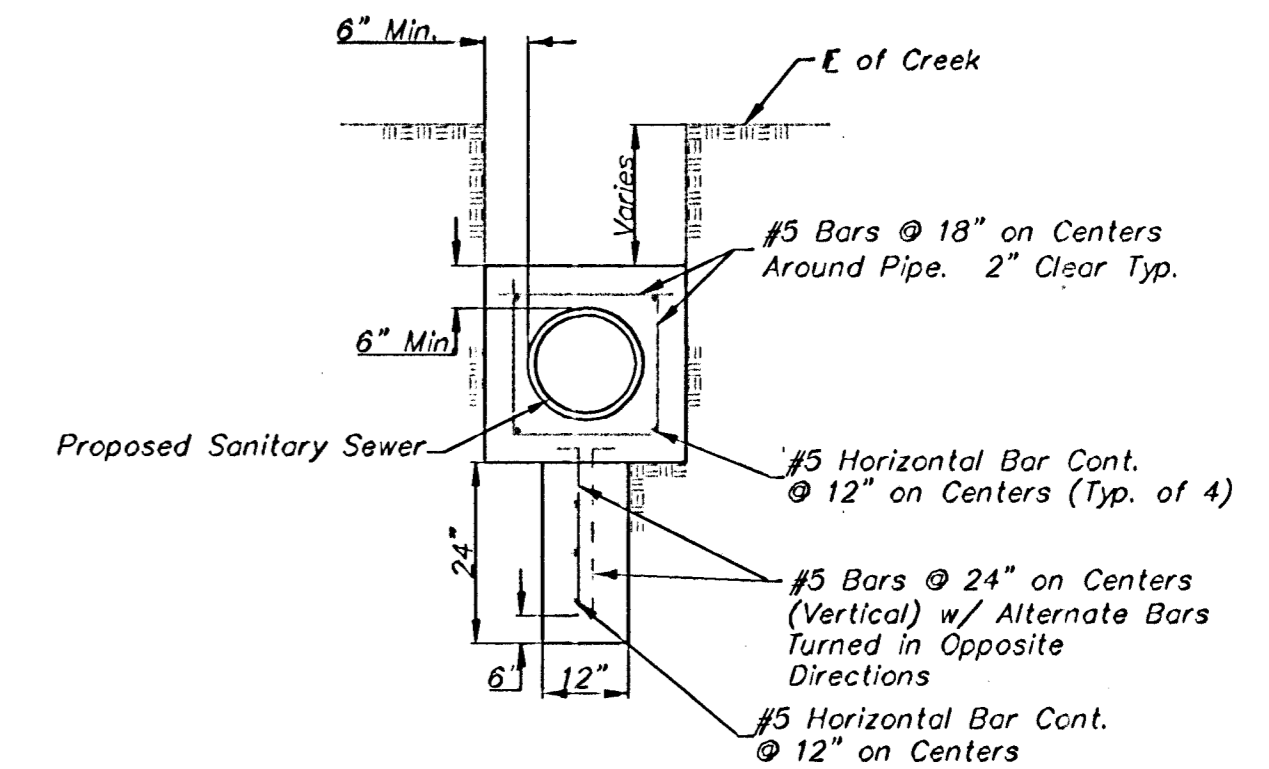

CONCRETE ENCASEMENT WITH CUT-OFF WALL DETAIL

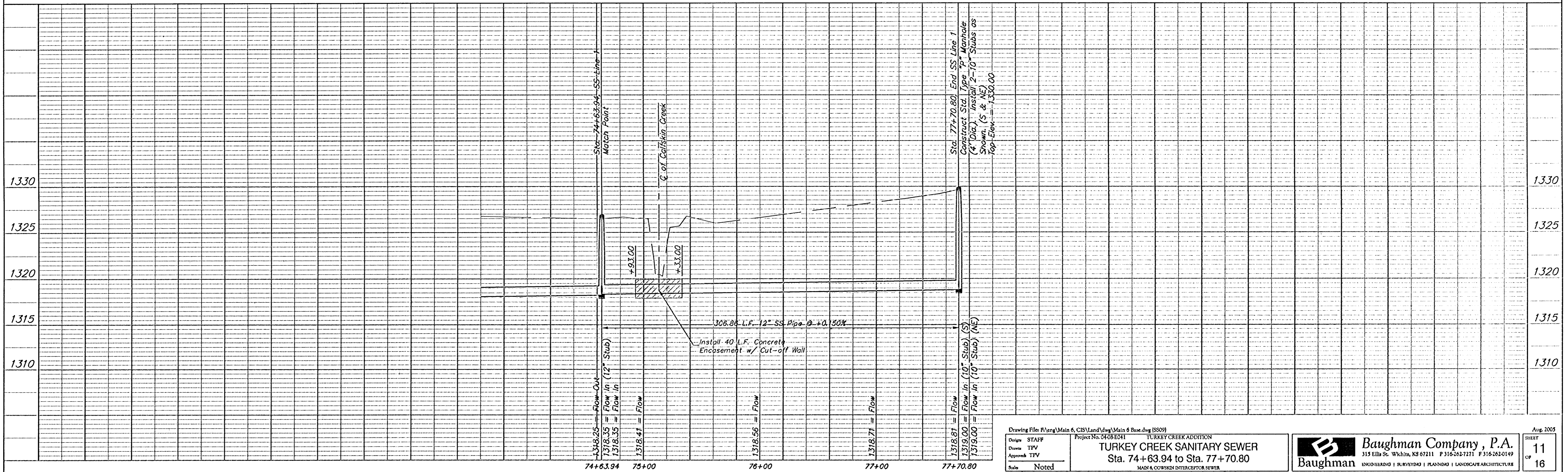

Drawing File: R:\eng\Main 6, GIS\Land\Map\Main 6 Base.dwg (SS09)
Design: STAFF
Drawn: TPV
Approved: TPV
Scale: Noted

TURKEY CREEK ADDITION
TURKEY CREEK SANITARY SEWER
Sta. 74+63.94 to Sta. 77+70.80
MAIN & COWSKEN INTERCEPTOR SEWER

Baughman Company, P.A.
315 Ellis St., Wichita, KS 67211 P 316-262-7271 F 316-262-0149
ENGINEERING | SURVEYING | PLANNING | LANDSCAPE ARCHITECTURE

Aug. 2005
SHEET 11 OF 16